

CURVE	RADIUS	LENGTH	TANGENT	CHORD	BEARING	DELTA
CURV. # 1	215.17'	77.72'	39.29'	77.30'	N41°03'54"W	20°41'42"
CURV. # 2	203.18'	221.37'	123.11'	210.58'	S61°55'44"E	62°25'22"
CURV. # 3	200.00'	58.60'	29.51'	58.39'	N78°27'58"E	16°47'14"
CURV. # 4	225.00'	78.48'	39.64'	78.09'	S80°03'55"W	19°59'08"

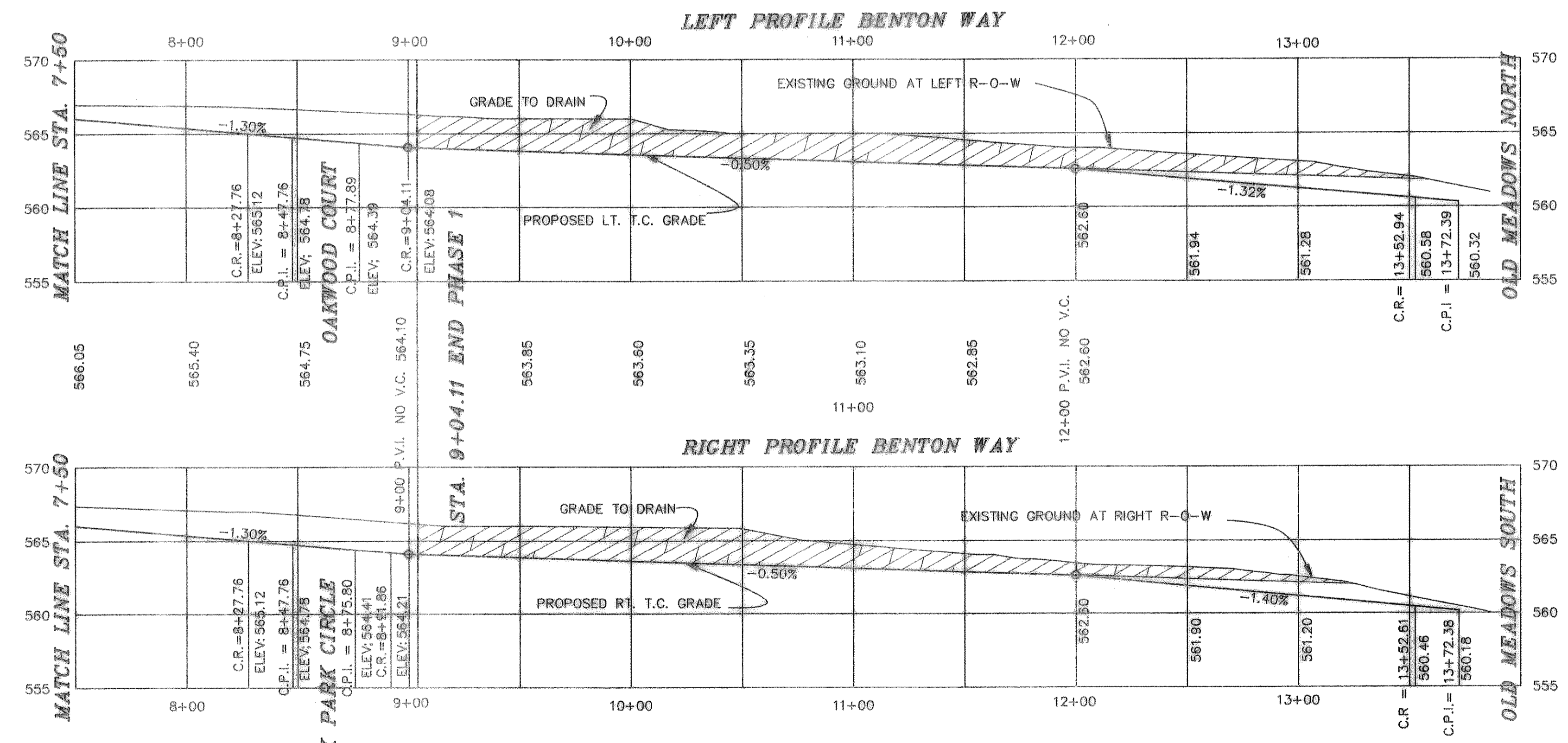

B.M.  
60 D NAIL IN P.P. #2315/443/3512  
LOCATED 35' +/- LT. OF PAV. STA. 9+41  
BENTON WAY  
ELEVATION = 560.01

B.M.  
60 D NAIL IN 15' ELM TREE 59' +/-  
S.E. OF N.E. CORNER OF LOT 8 & 9,  
BLOCK A  
ELEVATION = 564.07

AS BUILT

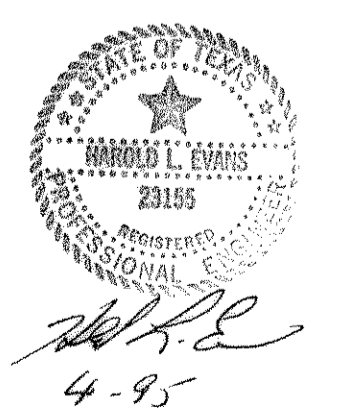

4-95

HAROLD L. EVANS CONSULTING ENGINEER P.O. BOX 28855 2331 GUS THOMASSON ROAD, SUITE 102 DALLAS, TEXAS 75228, (214) 328-8183		PAVING PLAN BENTON WAY BENTON WOODS CITY OF ROCKWALL		SHEET NO. 4 10 JOB NO. 9417
REVISION DESCRIPTION REV. PER FIRST REVIEW	DATE 7/29/94	SCALE HORIZ 1" = 40' VERT 1" = 6'	DESIGN H.L.E.	DRAWN K.E.B.