

AREA #	AREA	C	TC	I100	Q100	COMMENTS
1	0.13 AC	0.90	10 MIN	9.8 IN/HR	1.1 CFS	TO INLET 02
2	0.25 AC	1.00	10 MIN	9.8 IN/HR	2.4 CFS	TO ROOF DRAIN
3	0.22 AC	1.00	10 MIN	9.8 IN/HR	2.2 CFS	TO ROOF DRAIN
4	0.11 AC	0.90	10 MIN	9.8 IN/HR	1.0 CFS	TO INLET 03
5	0.15 AC	0.90	10 MIN	9.8 IN/HR	1.4 CFS	TO INLET 01
7	0.20 AC	0.90	10 MIN	9.8 IN/HR	1.8 CFS	TO INLET 05
8	0.29 AC	0.90	10 MIN	9.8 IN/HR	2.5 CFS	TO INLET 04
9	0.16 AC	0.90	10 MIN	9.8 IN/HR	1.4 CFS	TO INLET 06
10	0.29 AC	0.90	10 MIN	9.8 IN/HR	2.6 CFS	TO INLET 07
11	0.32 AC	0.90	10 MIN	9.8 IN/HR	2.8 CFS	TO INLET 09
12	0.32 AC	0.90	10 MIN	9.8 IN/HR	2.8 CFS	TO INLET 08
13	0.19 AC	0.90	10 MIN	9.8 IN/HR	1.7 CFS	TO 2'X2' YARD INLET
14	0.16 AC	0.90	10 MIN	9.8 IN/HR	1.4 CFS	TO 2'X2' YARD INLET
15	0.97 AC	0.90	10 MIN	9.8 IN/HR	8.6 CFS	TO OUTLET STRUCTURE
16	0.74 AC	0.90	10 MIN	9.8 IN/HR	6.5 CFS	BETA COURT TO CURB INLET
17	0.33 AC	0.90	10 MIN	9.8 IN/HR	2.9 CFS	ALPHA DRIVE TO BETA COURT
18	0.43 AC	0.90	10 MIN	9.8 IN/HR	3.8 CFS	BYPASS AREA
19	0.20 AC	0.90	10 MIN	11.5 IN/HR	2.1 CFS	TO TxDOT DRIVEWAY CULVERT

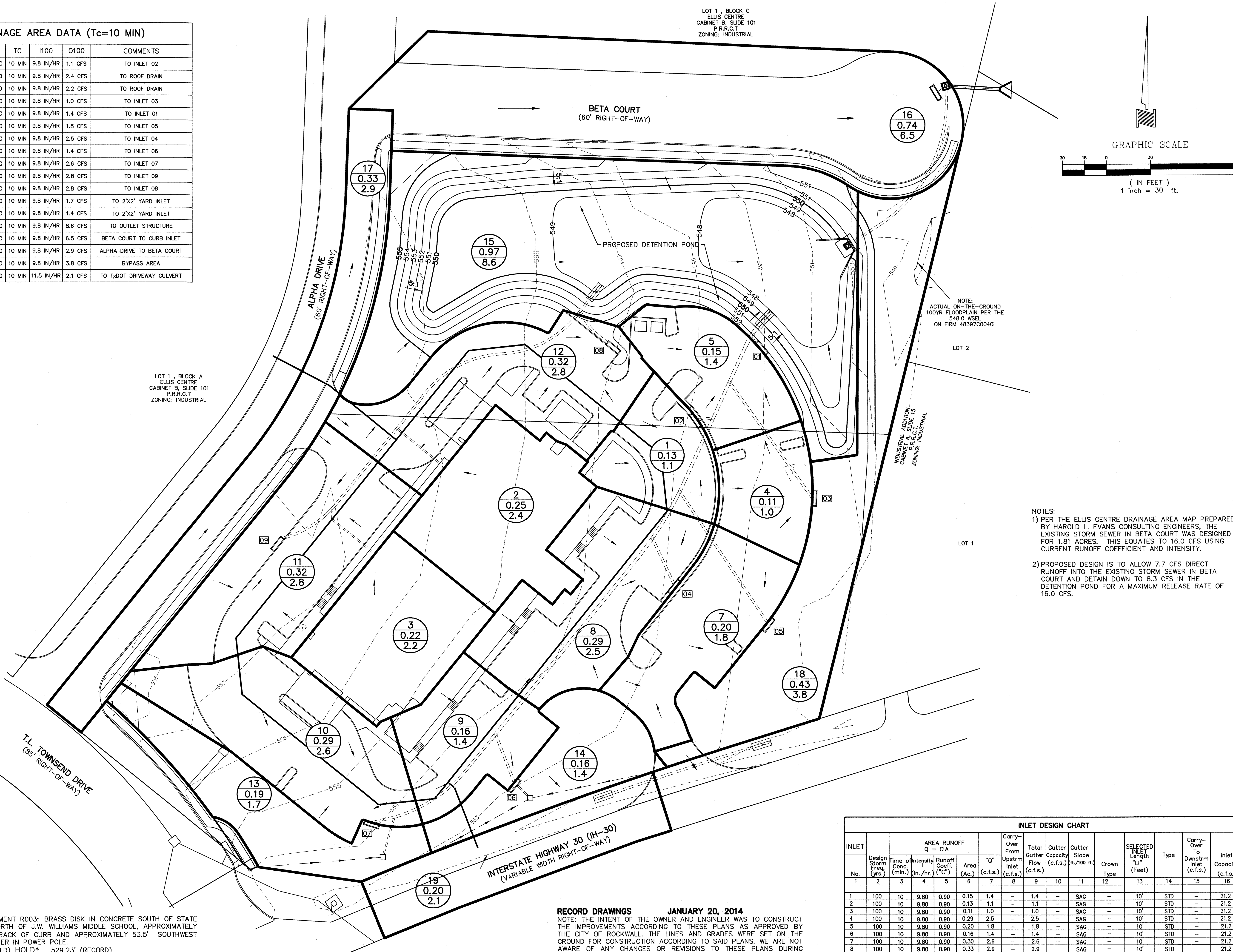

NOTE:
ACTUAL ON-THE-GROUND
100YR FLOODPLAIN PER THE
548.0 WSEL
ON FIRM 48397C0040L

- NOTES:
- PER THE ELLIS CENTRE DRAINAGE AREA MAP PREPARED BY HAROLD L. EVANS CONSULTING ENGINEERS, THE EXISTING STORM SEWER IN BETA COURT WAS DESIGNED FOR 1.81 ACRES. THIS EQUATES TO 16.0 CFS USING CURRENT RUNOFF COEFFICIENT AND INTENSITY.
 - PROPOSED DESIGN IS TO ALLOW 7.7 CFS DIRECT RUNOFF INTO THE EXISTING STORM SEWER IN BETA COURT AND DRAIN DOWN TO 8.3 CFS IN THE DETENTION POND FOR A MAXIMUM RELEASE RATE OF 16.0 CFS.

BENCHMARKS:
CITY OF ROCKWALL MONUMENT R003: BRASS DISK IN CONCRETE SOUTH OF STATE HIGHWAY NO. 66 AND NORTH OF J.W. WILLIAMS MIDDLE SCHOOL, APPROXIMATELY 21' WEST OF A CORNER BACK OF CURB AND APPROXIMATELY 53.5' SOUTHWEST OF AN 8D NAIL WITH SHINER IN POWER POLE.
ELEVATION = 529.23' (FIELD) HOLD* 529.23' (RECORD)
CITY OF ROCKWALL MONUMENT R005: BRASS DISK IN CONCRETE IN GRASS MEDIAN AT INTERSECTION OF FARM TO MARKET ROAD NO. 740 (RIDGE ROAD) AND SUMMIT RIDGE DRIVE, APPROXIMATELY 14' NORTHWEST OF A FIRE HYDRANT AND APPROXIMATELY 10' WEST OF A STREET SIGN.
ELEVATION = 578.71'(RECORD) 578.63' (FIELD)

RECORD DRAWINGS **JANUARY 20, 2014**
NOTE: THE INTENT OF THE OWNER AND ENGINEER WAS TO CONSTRUCT THE IMPROVEMENTS ACCORDING TO THESE PLANS AS APPROVED BY THE CITY OF ROCKWALL. THE LINES AND GRADES WERE SET ON THE GROUND FOR CONSTRUCTION ACCORDING TO SAID PLANS. WE ARE NOT AWARE OF ANY CHANGES OR REVISIONS TO THESE PLANS DURING CONSTRUCTION EXCEPT AS NOTED ON THE PLANS.

INLET No.	Design Storm Freq. (yrs.)	AREA RUNOFF Q = CIA				Carry-Over From Upstrm Inlet (c.f.s.)	Total Gutter Flow (c.f.s.)	Gutter Capacity (c.f.s.)	Slope (ft./100 ft.)	Crown Type	SELECTED INLET Length "L" (Feet)	Type	Carry-Over To Downstrm Inlet (c.f.s.)	Inlet Capacity (c.f.s.)
		Time of Intensity Conc. (min.)	Intensity (in./hr.)	Runoff Coeff. ("C")	Area (Ac.)									
1	100	10	9.80	0.90	0.15	1.4	1.4	SAG	10'	STD	21.2			
2	100	10	9.80	0.90	0.13	1.1	1.1	SAG	10'	STD	21.2			
3	100	10	9.80	0.90	0.11	1.0	1.0	SAG	10'	STD	21.2			
4	100	10	9.80	0.90	0.29	2.5	2.5	SAG	10'	STD	21.2			
5	100	10	9.80	0.90	0.20	1.8	1.8	SAG	10'	STD	21.2			
6	100	10	9.80	0.90	0.16	1.4	1.4	SAG	10'	STD	21.2			
7	100	10	9.80	0.90	0.30	2.6	2.6	SAG	10'	STD	21.2			
8	100	10	9.80	0.90	0.33	2.9	2.9	SAG	10'	STD	21.2			
9	100	10	9.80	0.90	0.48	4.2	4.2	SAG	10'	STD	21.2			

- MEP Engineering
Telios Corporation
12946 Dalry Ashford, Suite 130 Sugar Land, Texas 77478
- Structural Engineering
ASA Dally Structural Engineers
9800 Richmond Ave., Suite 460 Houston, Texas 77042
- Landscape Architect
Studio 13 Design Group
513 Bennett Lane, Suite 203 Lewisville, TX 75057
- Civil Engineering
DOWDEY, ANDERSON & ASSOCIATES, INC.
5225 Village Creek Drive, Suite 200 Plano, Texas 75093
Phone 972-931-0694 Fax 972-931-9538
STATE REGISTRATION NUMBER: 16399

No.	Date	Description
1	9/28/2012	ISSUED FOR REVIEW
2	10/21/2012	ISSUED FOR REVIEW
3	11/13/2012	ISSUED FOR REVIEW
4	11/16/2012	ISSUED FOR REVIEW
Δ	01/20/2014	PR. 01
Δ	01/20/2014	RECORD DRAWINGS

Emerus Emergency Hospital - Rockwall



Interstate Highway 30 and T.L. Townsend Drive
Rockwall, TX 75087

Drainage Area Map