

**DIMENSIONAL CONTROL & STRIPING PLAN**

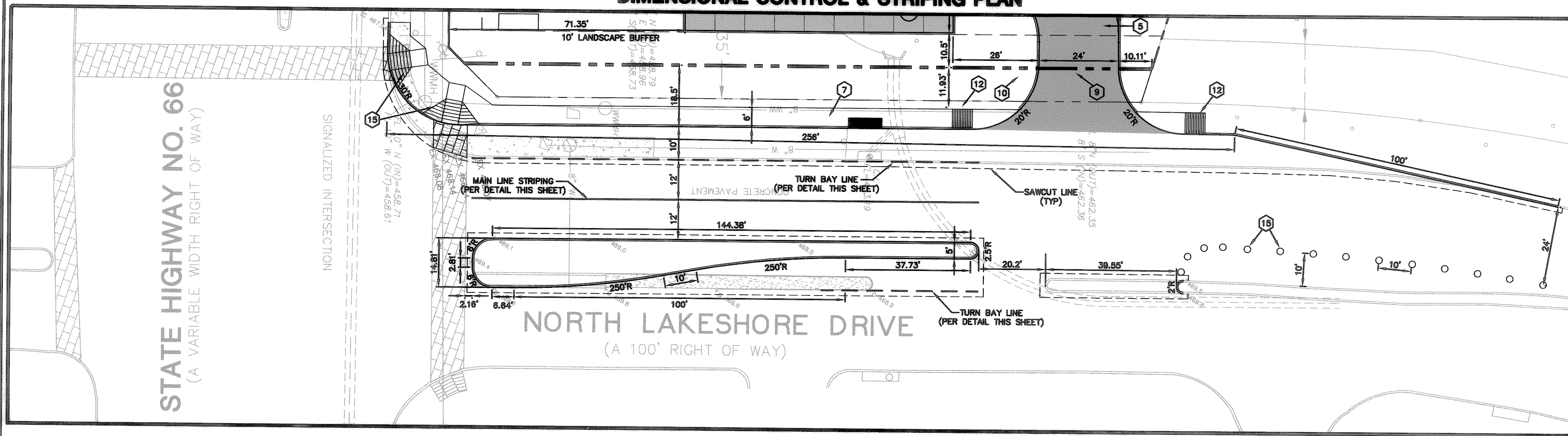

**CAUTION !!**  
 CONTRACTOR IS TO CONTACT TEXAS ONE-CALL SYSTEM (1-800-245-4848) OR OTHER UTILITY LOCATING SERVICES AT LEAST 48 HOURS PRIOR TO CONSTRUCTION ACTIVITIES. BURY & PARTNERS IS NOT RESPONSIBLE FOR KNOWING ALL EXISTING UTILITIES IN THE PROJECT AREA NOR FOR DEPICTING THE EXACT LOCATIONS OF UTILITIES ON THESE DRAWINGS.

- KEY NOTES**
- 1 BARRIER FREE RAMP (PER DETAIL C7.1.8)
  - 2 HANDICAP SYMBOL (PER DETAIL C7.1.1)
  - 3 HANDICAP SIGNAGE (PER DETAIL C7.1.2)
  - 4 4" STRIPING (WHITE) (PER DETAIL C7.1.7)
  - 5 TRAFFIC FLOW ARROW (WHITE) (PER DETAIL C7.1.5)
  - 6 INTEGRAL CURB & GUTTER (PER DETAIL C7.2.10)
  - 7 6" WIDE CONCRETE SIDEWALK
  - 8 FIRE HYDRANT
  - 9 STOP BAR (PER DETAIL C7.1.6)
  - 10 STOP SIGN (PER DETAIL C7.1.3)
  - 11 CONCRETE STREET HEADER (PER DETAIL C7.2.11)
  - 12 SIDEWALK RAMP PER TxDOT STDS (SEE DETAIL SHEET PED-02 - SHEET 2 OF 3)
  - 13 TYPE 1 RAMP PER TxDOT STDS (SEE DETAIL SHEET PED-02 - SHEET 1 OF 3)
  - 14 5' ON-SITE SIDEWALK (PER DETAIL C7.2.12)
  - 15 6" YELLOW CHANNEL MARKER ON 10 FT

SEE SHEETS C2.1, C3.1 & C8.1 FOR DIMENSIONAL CONTROL, GRADING, AND PAVING NOTES

CONTRACTOR TO COORDINATE TRAFFIC SIGNAL LOOP, CABLE AND SWITCH WORK WITH TRAFFIC OPERATIONS DEPT. OF TxDOT LOCATED IN MESQUITE. CONTACT: MAHER GHANAYEM

**GRADING PLAN**

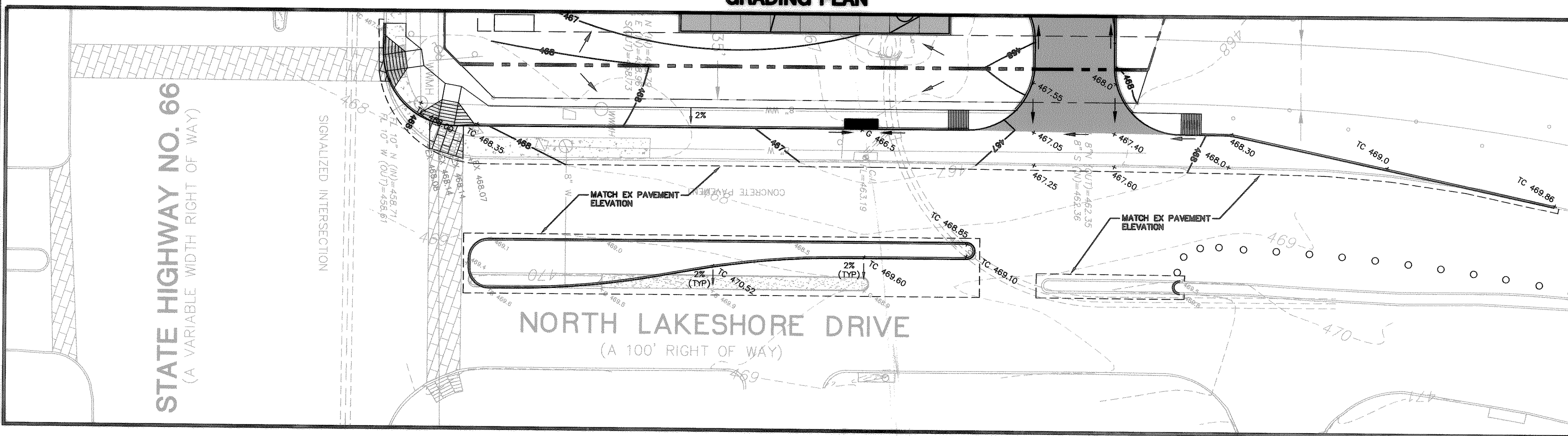

- PAVING LEGEND**
- CITY ROADWAY PAVEMENT:**  
 6" 3600 PSI CONCRETE PWMT. (6 SACK MIN MIX, 6 1/2 IF HAND POURED) WITH 6" LIME STABILIZED SUBGRADE COMPACTED TO 95% AT OR ABOVE OPTIMUM MOISTURE CONTENT. (ASTM D 698)
  - HEAVY DUTY PAVEMENT:**  
 6" 4000 PSI CONCRETE PWMT. W/#3 BARS ON 18" CENTERS BOTH WAYS, ON 8" LIME TREATED SUBGRADE (30 LBS/SY). (6 SACK MIN IF MACHINE POURED & 6 1/2 SACK MIN IF HAND POURED)
  - STANDARD DUTY PAVEMENT:**  
 5" 4000 PSI CONCRETE PWMT. W/#3 BARS ON 18" CENTERS BOTH WAYS, ON 8" LIME TREATED SUBGRADE (30 LBS/SY).
  - SIDEWALK & FLATWORK:**  
 3" 3000 PSI REINFORCED CONCRETE WITH #3 BARS AT 24" OCEW WITH 1 1/2" SAND BASE ON SUBGRADE COMPACTED TO 95% (ASTM D 698)
  - CROSSWALK PAVEMENT**  
 BOMANITE CROSSWALK (MATCH EXISTING PAVING)
  - BRICK PAVERS**  
 BRICK PAVERS BY PAVESTONE ON 1" BEDDING SAND WITH CONCRETE PAVING (SEE CITY STANDARD 2130)
  - EXISTING CONCRETE PAVEMENT
  - SAWCUT LINE

RECORD DRAWING

RECORD DRAWINGS:  
 THE INTENT OF THE OWNER AND ENGINEER WAS TO CONSTRUCT THE FACILITIES ACCORDING TO THESE PLANS AS APPROVED BY THE CITY OF ROCKWALL. THE OWNER OR ENGINEER DID NOT VERIFY LINES OR GRADES AFTER CONSTRUCTION AND IS NOT AWARE OF ANY CHANGES OR REVISIONS TO THESE PLANS DURING CONSTRUCTION EXCEPT AS NOTED BASED ON INFORMATION PROVIDED BY: CENTEX CONSTRUCTION COMPANY 3100 MCKINNON STREET, 7TH FLOOR DALLAS, TEXAS 75201 PHONE: (214) 468-4700 FAX: (214) 468-4257 CONTACT: ROBERT BOE (PROJECT MANAGER)

**PAVING PLAN**

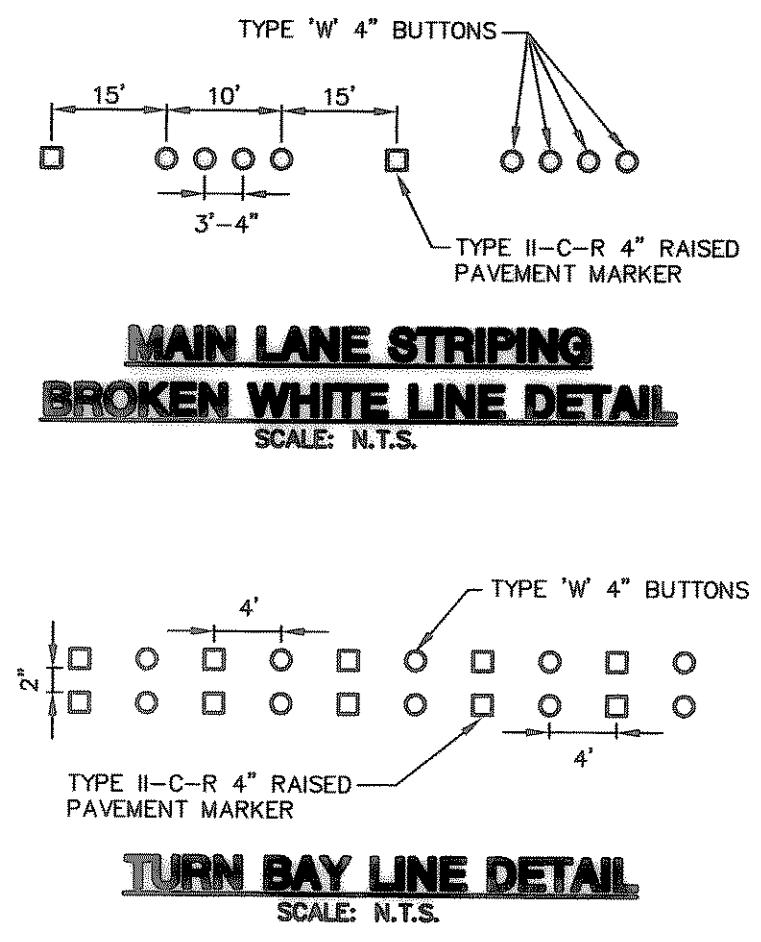
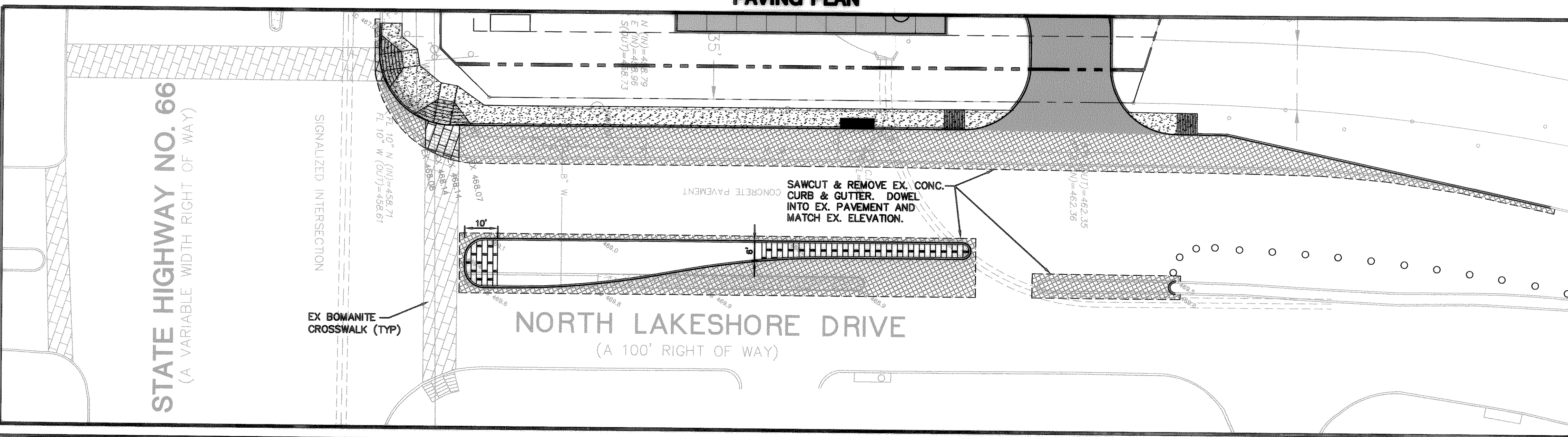

**Oculus Inc.**  
 393 NORTH EUCLID SUITE 240  
 ST. LOUIS, MO 63108 USA  
 (T) 314.367.6100  
 (F) 314.367.1489  
 WWW.OCULUSINC.COM

REFERENCE BM = 518.32  
 CITY OF ROCKWALL GEODETIC MONUMENT R011; IN MEDIAN STRIP OF NORTH LAKESHORE DR. BETWEEN STONEBROOK DR. & AMESBURY DR.

SITE BM = 467.38  
 "T" IN CENTER LINE OF INLET ON THE WEST SIDE OF SOUTH BOUND LAKESHORE DRIVE. ± 180' NORTH OF THE CENTERLINE INTERSECTION OF SH 66 & LAKESHORE DR.

SERIAL NUMBER:  
 NRSP VERSION: 2.5  
 BULLETIN:  
 Project Name  
 BANK OF AMERICA TX-0541 ROCKWALL, TX S.H. 66 & NORTH LAKESHORE DRIVE  
 PROTOTYPE LAYOUT  
 MEDIUM - TX-0541 OCULUS #  
 Issue Date & Issue Description By

PNH 12/15/04  
 BAA 11/18/04  
 BY DATE  
 REVISION  
 1 CITY COMMENTS  
 2 CITY COMMENTS  
 NO.

**Bury+Partners**  
 ENGINEERING SOLUTIONS  
 5810 Fairview Mill Road, Suite 100  
 Dallas, TX 75248-1011 Fax: (972) 961-0278  
 Bury+Partners-DPT, Inc. ©Copyright 2004

**Professional Engineer Seal:**  
 TEXAS  
 BILAL A. ALIZAI  
 LICENSE NO. 927792

**LAKESHORE DRIVE DIMENSIONAL CONTROL & STRIPING, GRADING & PAVING PLAN**

BANK OF AMERICA TX-0541  
 LOT 2, BLOCK A, BOWLES ADDN.  
 S.H. 66 & N. LAKESHORE DRIVE  
 ROCKWALL, TX

Scale: 1"=20' Date: 7-8-05  
 Designed By: BAA  
 Drawn By: DSM  
 Checked By: PMH  
 File: F:\3332-08\3320BLKS.DWG  
 Project No.: 30332-08

SHEET  
**C6.2**