

CONSTRUCTION PLANS
FOR
**BANK OF AMERICA
BOWLES ADDITION**
LOT 2, BLOCK A
IN
**THE CITY OF ROCKWALL
ROCKWALL COUNTY, TEXAS**

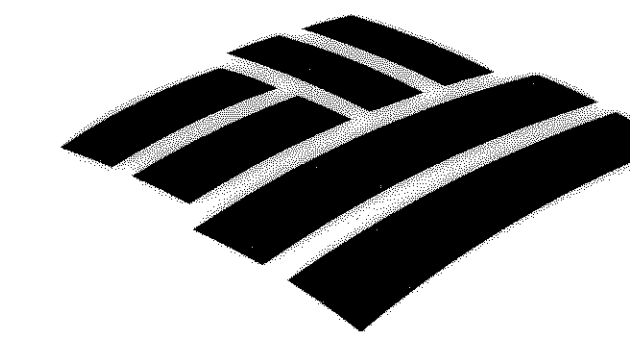

JULY, 2005

OWNER: PATMAN REALTY COMPANY
8333 DOUGLAS AVENUE
SUITE 1440, LB 51
DALLAS, TEXAS 75225
PH: (214) 691-0909
CONTACT: PAT PATMAN

DEVELOPER: TRAMMELL CROW COMPANY
400 SOUTH ZANG BOULEVARD
SUITE 1100
DALLAS, TEXAS 75208
PH: (214) 948-2163
CONTACT: THOMAS HOLLAND

CIVIL ENGINEER: BURY + PARTNERS-DFW, INC.
5310 HARVEST HILL ROAD
SUITE 100
DALLAS, TEXAS 75230
PH: (972) 991-0011
FAX: (972) 991-0278
CONTACT: PAUL M. HAMES

SURVEYOR: BURY + PARTNERS-DFW, INC.
5310 HARVEST HILL ROAD
SUITE 100
DALLAS, TEXAS 75230
PH: (972)991-0011
FAX: (972)991-0278
CONTACT: DAVID DE WEIRD, R.P.L.S.

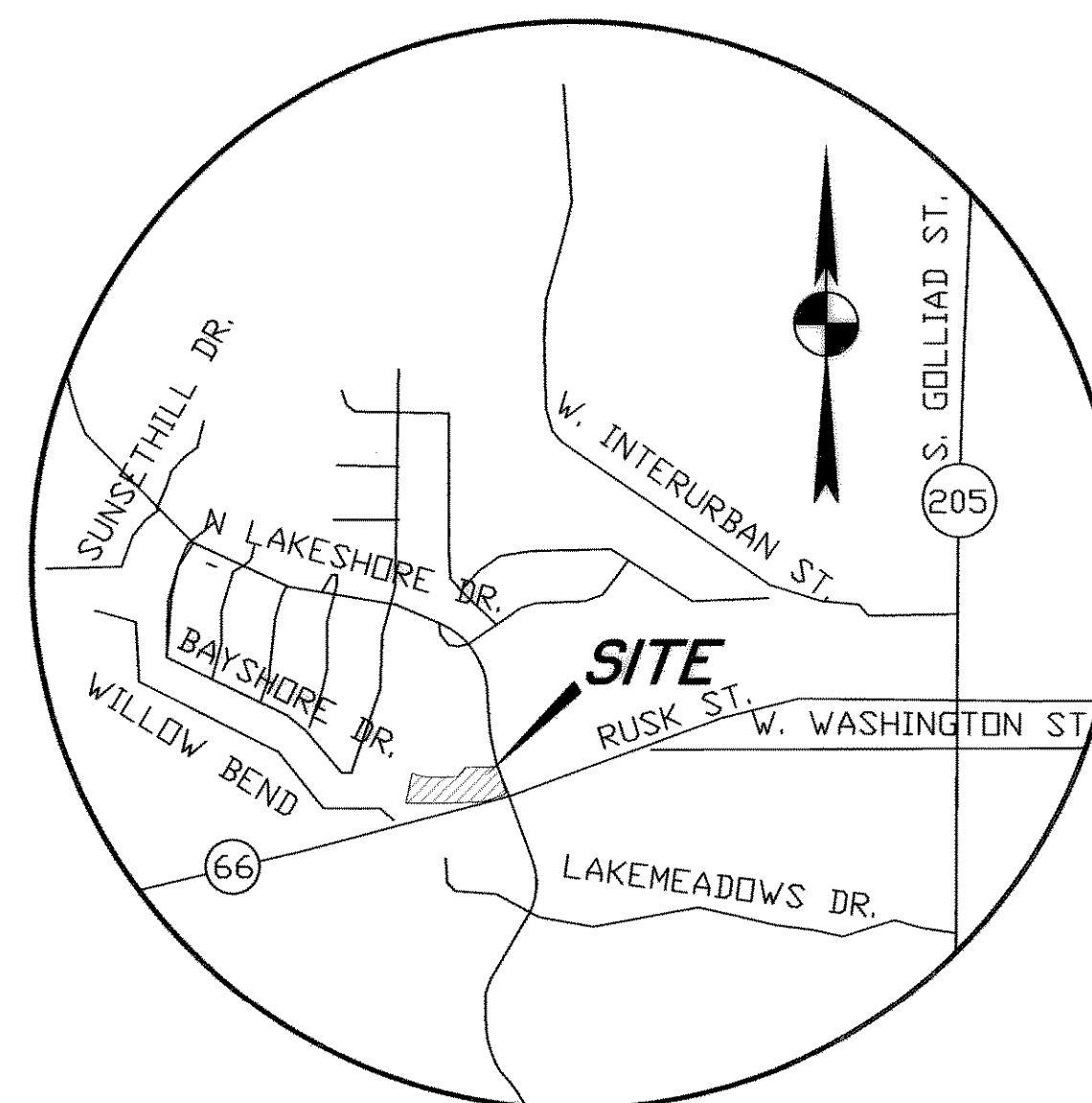

VICINITY MAP

NTS
(MAPSCO GRID 20C P)

INDEX OF SHEETS

SHEET NO.	DESCRIPTION
	COVER SHEET
C0.1	PLAT
C0.2	PLAT
C2.1	LAYOUT & DIMENSIONAL CONTROL PLAN
C3.1	GRADING PLAN
C3.2	OFFSITE GRADING PLAN
C4.1	DRAINAGE AREA MAP
C4.2	STORM DRAIN PLAN
C4.3	OFFSITE STORM DRAIN PLAN
C4.4	STORM DRAIN PROFILES
C5.1	UTILITY PLAN
C6.1	PAVING PLAN
C6.2	LAKESHORE DRIVE DIMENSIONAL CONTROL & STRIPING, GRADING & PAVING PLAN

RECORD DRAWING

*Richard Alizai
7/25/2005*

RECORD DRAWINGS:
THE INTENT OF THE OWNER AND ENGINEER WAS TO
CONSTRUCT THE FACILITIES ACCORDING TO THESE PLANS
AS APPROVED BY THE CITY OF ROCKWALL. THE OWNER
OR ENGINEER DID NOT VERIFY LINES OR GRADES AFTER
CONSTRUCTION AND IS NOT AWARE OF ANY CHANGES OR
REVISIONS TO THESE PLANS DURING CONSTRUCTION,
EXCEPT AS NOTED BASED ON INFORMATION PROVIDED BY:
CENTEX CONSTRUCTION COMPANY
3100 MCKINNON STREET, 7TH FLOOR
DALLAS, TEXAS 75201
PHONE: (214) 468-4700
FAX: (214) 468-4257
CONTACT: ROBERT BOE (PROJECT MANAGER)

Bury+Partners
ENGINEERING SOLUTIONS
5310 Harvest Hill Road, Suite 100
Dallas, Texas 75230
Tel. (972)991-0011 Fax (972)991-0278
Bury+Partners-DFW, Inc. ©Copyright 2004

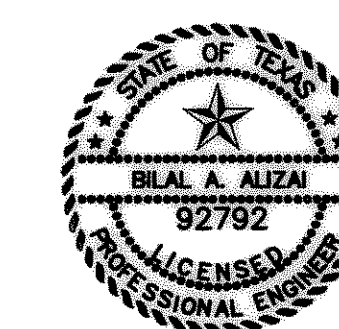

*Bilal A. Alizai
7/08/2005*

ISSUED FOR BID _____ ISSUED FOR CONSTRUCTION _____