

CONSTRUCTION PLANS FOR AUTUMN LEAVES

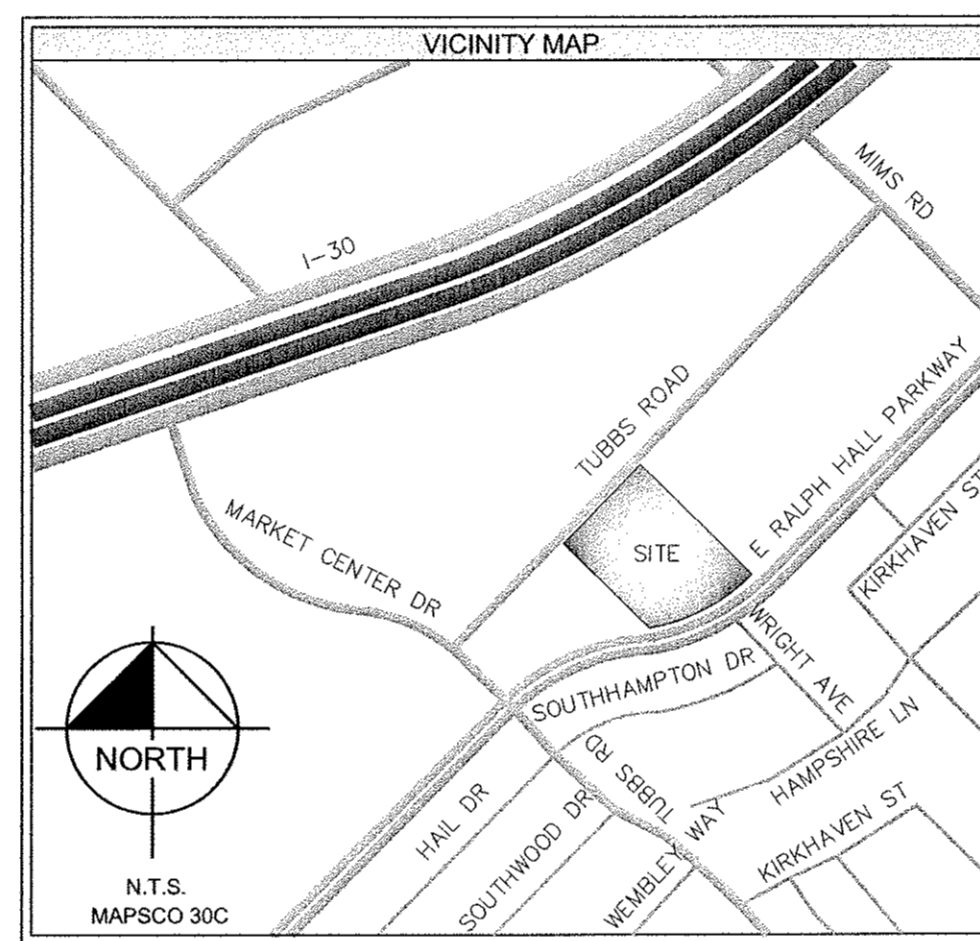

PLANS SUBMITTAL/REVIEW LOG

1st CITY SUBMITTAL -NOT FOR CONSTRUCTION	11/09/2010
2nd CITY SUBMITTAL -NOT FOR CONSTRUCTION	12/10/2010
3rd CITY SUBMITTAL FOR CONSTRUCTION	01/03/2011



INDEX OF SHEETS

SHEET NO.	DESCRIPTION	REVISION
CIVIL ENGINEERING (KIMLEY-HORN AND ASSOCIATES)		
C-001	COVER SHEET	
C-002	GENERAL NOTES	
C-101	SITE PLAN	
C-102	DIMENSION CONTROL PLAN	
C-201	GRADING PLAN	
C-202	DRAINAGE AREA MAP	
C-203	DETENTION POND PLAN	
C-204	DETENTION POND CALCULATIONS	
C-205	STORM SEWER PLAN	
C-206	STORM SEWER PROFILE	
C-301	UTILITY PLAN	
C-401	PAVING PLAN	
C-501	EROSION CONTROL PLAN	
C-502	EROSION CONTROL DETAILS	
L-101	TREESCPE PLAN	
L-100	LANDSCAPE PLAN	
L-101	LANDSCAPE ENLARGEMENTS	
L-200	LANDSCAPE DETAILS AND SPECIFICATIONS	
IR-100	IRRIGATION PLAN AND DETAILS	
	FINAL FLAT (BY OTHERS)	

PLAN REVISION LOG

NO.	DATE	DESCRIPTION

STANDARD SHEETS, SPECIFICALLY IDENTIFIED IN THIS INDEX OF SHEETS HAVE BEEN SELECTED BY ME OR UNDER MY SUPERVISION AS BEING APPLICABLE TO THIS PROJECT.

OWNER

GJ DEVELOPMENT, LP.
1500 EAST INDUSTRIAL BLVD.
MCKINNEY, TX 75069
PH. (972) 562-5555

DEVELOPER

THE LaSALLE GROUP
1900 EAST GOLF ROAD, SUITE 1120
SCHAUMBURG, IL 60173
PH. (847) 301-4145
CONTACT: KAY ADKINS

ARCHITECT

CURTIS GROUP ARCHITECTS LTD
5000 QUORUM DRIVE SUITE 300
DALLAS, TEXAS 75254
PH. (214) 378-9810 X5047
CONTACT: BEN KEYWORTH

ENGINEER

 **Kimley-Horn
and Associates, Inc.**
TEXAS REGISTERED ENGINEERING FIRM F-928
12700 PARK CENTRAL DRIVE
SUITE 1800
DALLAS, TEXAS 75251
PH. (972) 770-1300
CONTACT: HILLARY VONAHSN, P.E.

RALPH HALL PAKWAY AND MARKET CENTER DRIVE

E.P. GAINES CHISUM SURVEY ABSTRACT NO. 64
LOT 1 ROCKWALL MARKET CENTER SOUTH ADDITION

CITY OF ROCKWALL, TEXAS

CIVIL PLANS DECEMBER 2010
CONSTRUCTION JANUARY 2011

ALL RESPONSIBILITY FOR ADEQUACY OF DESIGN REMAINS WITH THE DESIGN ENGINEER. THE CITY OF ROCKWALL, IN REVIEWING AND RELEASING PLANS FOR CONSTRUCTION, ASSUMES NO RESPONSIBILITY FOR ADEQUACY OR ACCURACY OF DESIGN.

"RECORD DRAWING"
THIS DRAWING HAS BEEN REVISED TO SHOW THOSE CHANGES DURING THE CONSTRUCTION PROCESS REPORTED BY THE CONTRACTOR TO KIMLEY-HORN AND ASSOCIATES, INC. TO THE BEST OF OUR KNOWLEDGE, INFORMATION, AND BELIEF, THIS DRAWING IS CONSIDERED TO BE "AS BUILT" BUT IS BASED ON THE INFORMATION MADE AVAILABLE TO KHA BY THE CONTRACTOR AND BASED ON SURVEY DATA OBTAINED ON SEPTEMBER 14, 2011.

DATE: 10/12/2011 BY: 

 **Kimley-Horn
and Associates, Inc.**
© 2010 KIMLEY-HORN AND ASSOCIATES, INC.
12700 PARK CENTRAL DRIVE, SUITE 1800, DALLAS, TX 75251
PHONE: 972-770-1300
WWW.KIMLEY-HORN.COM
TEXAS REGISTERED ENGINEERING FIRM F-928

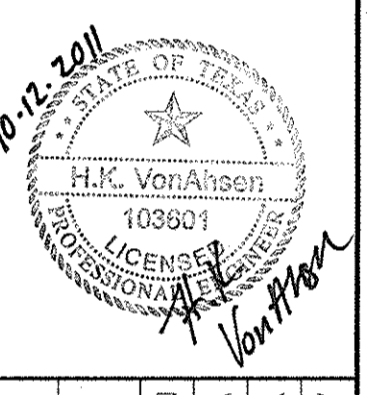

KHA PROJECT: 067773505
DATE: 01/03/2011
SCALE: AS SHOWN
DESIGNED BY: JGA
DRAWN BY: JGA
CHECKED BY: HKV

COVER SHEET

AUTUMN LEAVES
PREPARED FOR
THE LASALLE GROUP
CITY OF ROCKWALL, TEXAS

SHEET NUMBER
C-001

Plotted By: Armen@ghz, John, Sheet Set: 067773505-AutumnLeaves, Layout: C-001 COVER SHEET, October 12, 2011, 02:32:21pm, K:\gpl_civil\067773505-autumnleaves\Cad\plan sheets\C-001 COVER SHEET.dwg, This document, together with the concepts and designs presented herein, is intended only for the specific purpose and client for which it was prepared. Reuse of and improper reliance on this document without written authorization and adaptation by Kimley-Horn and Associates, Inc. shall be without liability to Kimley-Horn and Associates, Inc.