

Patrick Stephenson Subdivision
Lot 1, Block A

INTERSTATE HIGHWAY NO. 30 SERVICE ROAD

Lake Pointe Baptist Church

LOT 2 - 1.1596 ACRES

LOT 3 - 1.2500 ACRES

LOT 1 - 1.2680 ACRES

BLOCK A

Steger Toume Crossing
(Under Construction)

FILED FOR RECORD
ROCKWALL COUNTY TEXAS
37 MAY 15 PM 1:55
CITY CLERK
BY: *[Signature]* DEPUTY

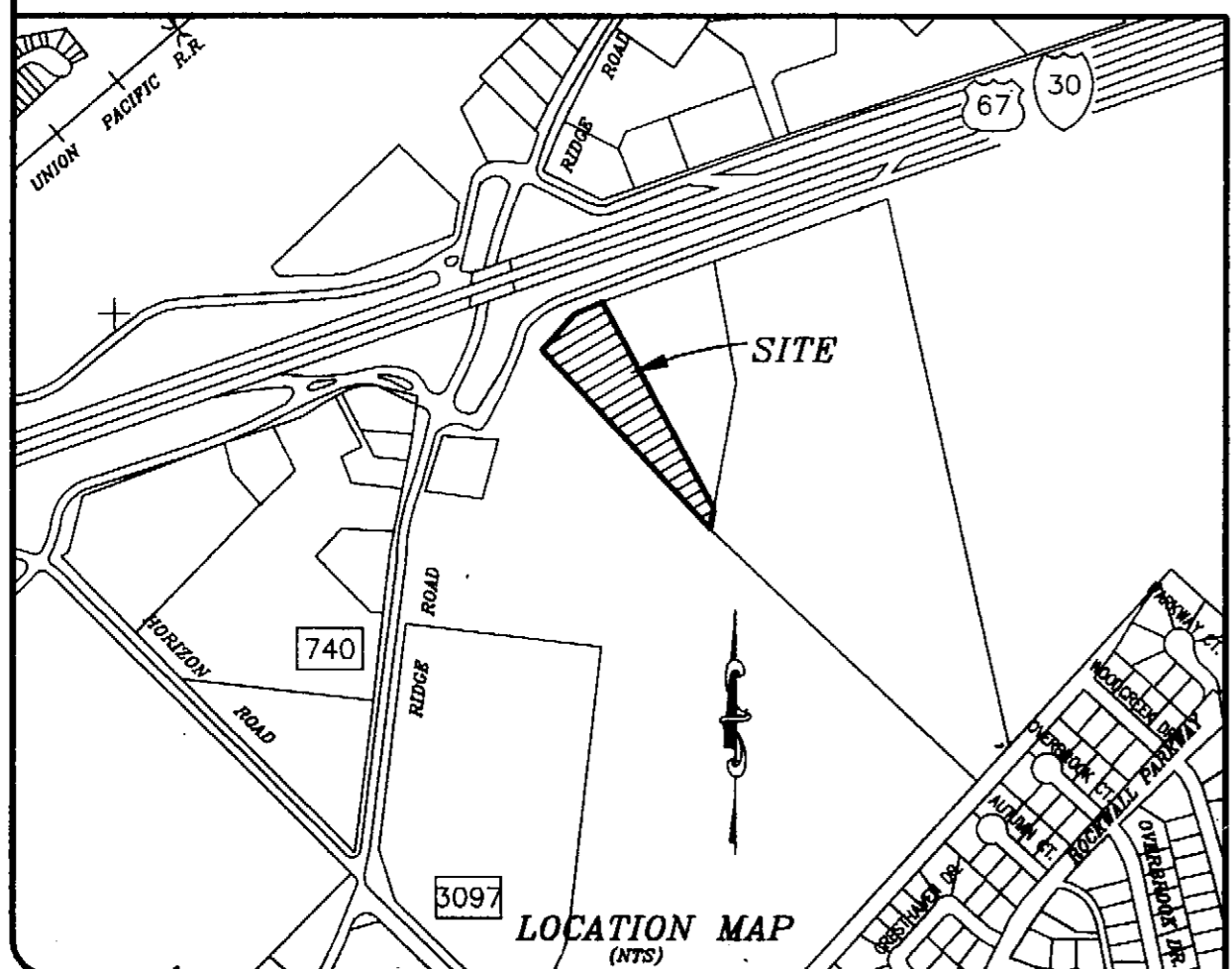
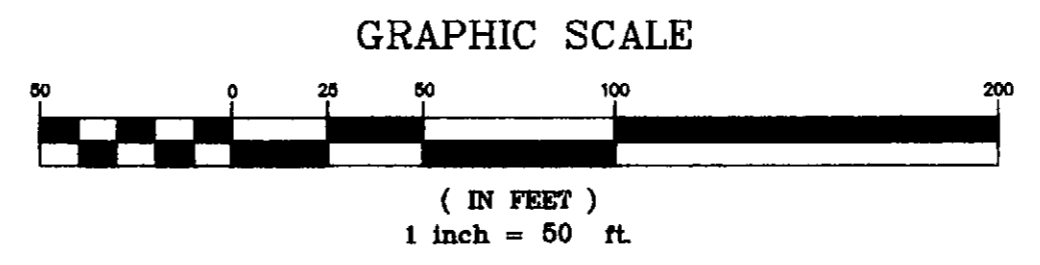
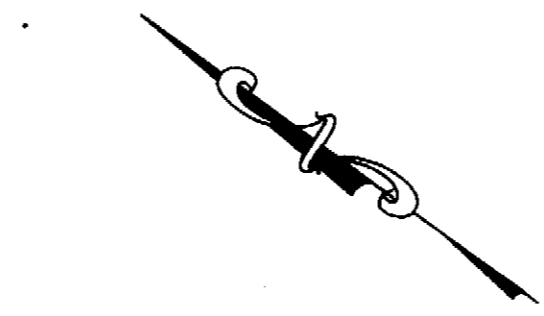

TRACT AREA = 3.6776 ACRES

8676PLT

D-1-2

HAROLD L. EVANS
CONSULTING ENGINEER
P.O. BOX 28365
2331 GUS THOMASSON ROAD, SUITE 102
DALLAS, TEXAS 75228, (214) 328-8133

SCALE	DATE	JOB No.
1"=50'	1/23/97	8676

MILLER ADDITION
A REPLAT OF
LOT 1, BLOCK A

TRIBBEY ADDITION

J. SMITH SURVEY, ABST. #200
CITY OF ROCKWALL, ROCKWALL COUNTY, TEXAS
ENMARK GAS CORP.
16415 ADDISON ROAD, SUITE 610, DALLAS, TEXAS 75248 (972 733-0011)