

NORTH

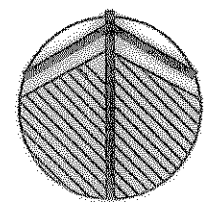

GRAPHIC SCALE



( IN FEET )  
1 inch = 1 ft.

**SANITARY SEWER GENERAL NOTES**

1. Unless otherwise noted, all material and construction shall conform to the current City of Rockwall manual, "Standard of Design, Standard Specifications for Construction, Standard Details for the City of Rockwall".
2. Whenever sanitary sewer mains are located in the street, it shall be placed 7 feet back of curb, unless otherwise shown on the plans. All water and sanitary sewer mains shall have a 10.0 feet minimum lateral separation.
3. Sewer pipe and services shall be SDR35 P.V.C gravity pipe unless shown otherwise on these plans.
4. In the event an item is not covered in the City of Rockwall "Standard Specifications for Construction", the City Engineer's decision shall apply.
5. At water and sewer main crossings, sewer pipe joints shall not be located closer than ten horizontal feet from the water main. If this condition cannot be adhered to, the sewer pipe joints shall be pressure type. (160 P.S.I. minimum) on plans.
6. Trench walls shall be constructed in strict accordance with the latest Occupational Safety and Health Administration standards and may be sloped or vertical above the pipe embedment, at the contractor's option. In some locations, the available working area may be inadequate to allow for fully sloped trench walls. In these areas, the contractor shall provide temporary sheeting, shoring or bracing of trench walls. As necessary, in strict accordance with O.S.H.A. standards, to prevent slides, cave-ins, settlement or movement of the banks and to provide safe working conditions for workmen.

**WATER LINE GENERAL NOTES**

1. Unless otherwise noted, all material and construction shall conform to the current City of Rockwall Manual, "Standard of Design, Standard Specifications for Construction, Standard Details for the City of Rockwall".
2. All ductile iron fittings shall be of the mechanical joint type or slip joint, except as noted and shall be class "D" or class 250 on sizes 12" and smaller in accordance with AWWA specifications C-111-04.
3. Water mains shall have a minimum cover of 36", water pipe shall be AWWA C900 Class
4. Fire hydrants shall be either Mueller, American Darling or an approved equivalent conforming to the requirements set forth in the City of Rockwall "Standard of Design, Standard Specifications for Construction". All fire hydrants shall be installed with a 6-inch gate valve on the hydrant lead and will be placed 2 feet - 4 feet from back of curb unless otherwise indicated on the plans or as required to clear sidewalk. Do not place fire hydrants in street curb returns.
5. Fire hydrant bonnets and caps will be painted to conform with City Specifications for color code as set forth in the "Standard Specifications for Construction."
6. Gate valves shall be manufactured by Mueller or Kennedy, or approved equivalent and shall conform to and shall be installed according to the City of Rockwall "Standard Specifications for Construction."
7. Flush valves or an approved equivalent shall be installed on all dead-end water lines and shall comply with the City of Rockwall standard details.
8. Whenever sanitary sewer mains are located in the street, it shall be placed 7 feet back of curb, unless otherwise shown on plans. All water and sanitary sewer mains shall have a 10.0 feet minimum lateral separation.
9. In the event an item is not covered in the City of Rockwall "Standard Specifications for Construction", the City Engineer's decision shall apply.

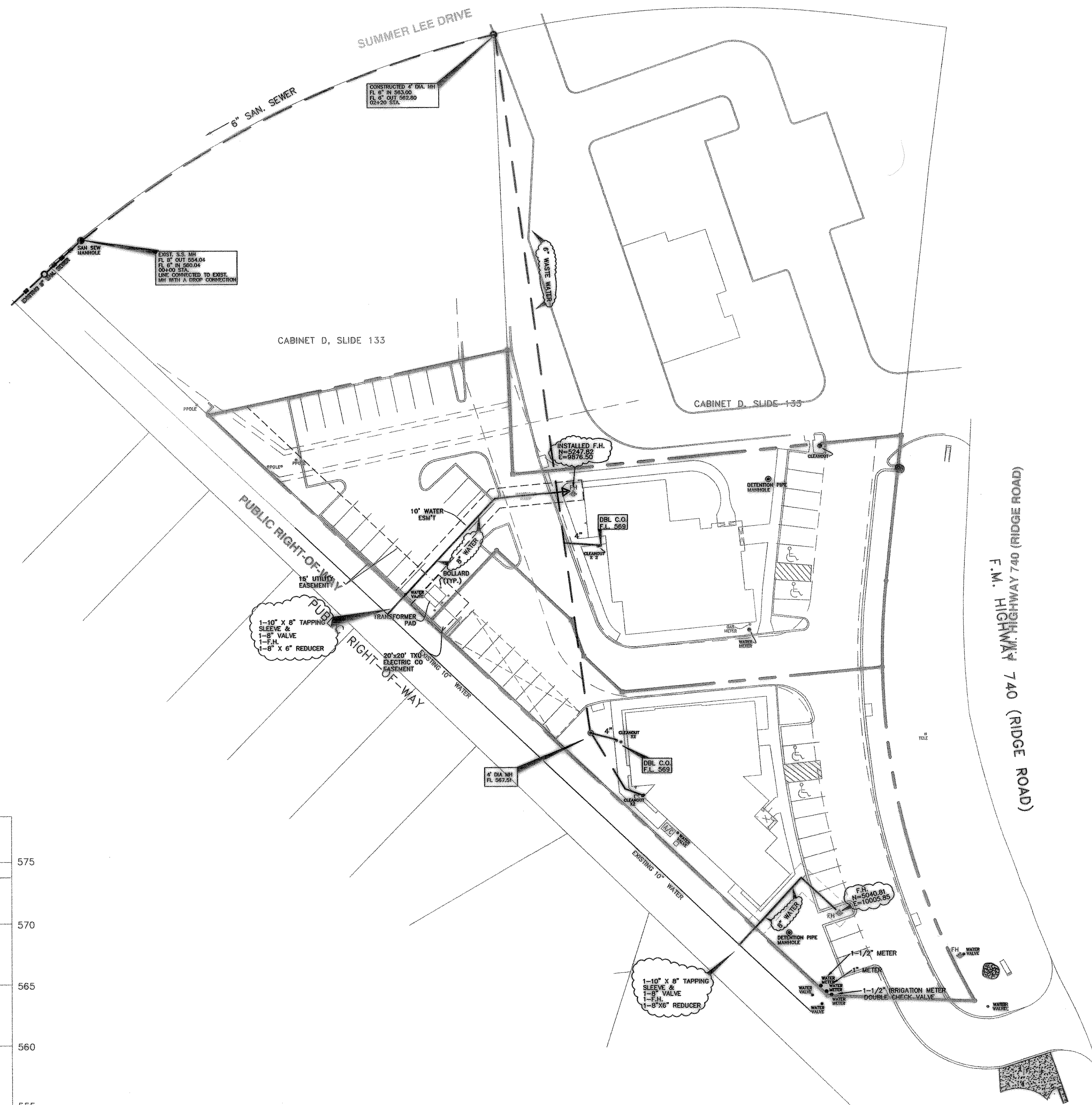
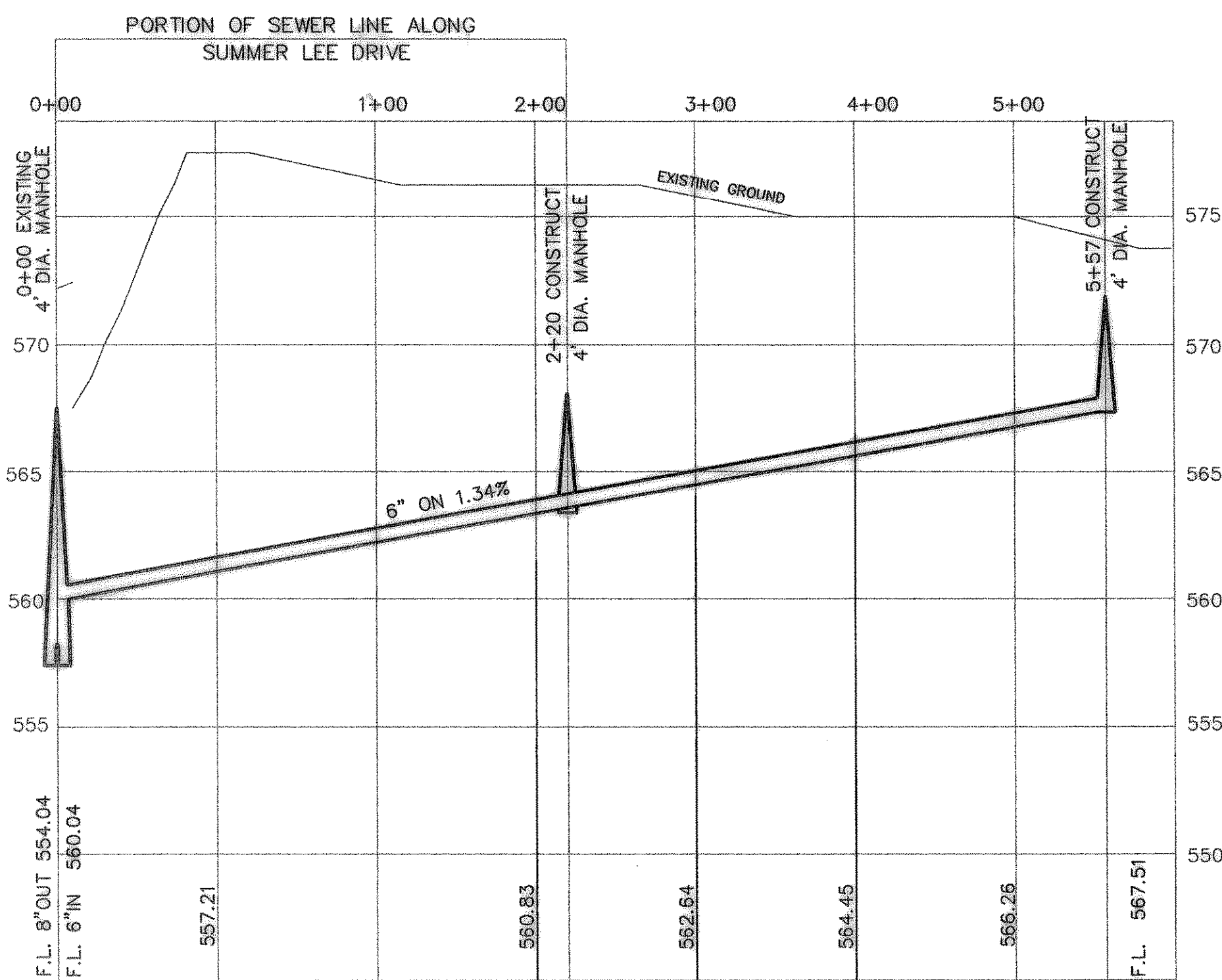

**BENCH MARK**  
B.M. "□" CUT TOP OF CURB, NORTH SIDE OF  
SUMMER LEE DRIVE AND F.M. HIGHWAY NO. 740.  
ELEVATION 565.71.

**American Title/  
Chakmakjian Office Complex**  
Ridge Road, Rockwall, Texas



Civil Engineering &  
Environmental Consulting  
11105 Fernald Avenue,  
Dallas, Texas 75218  
(214)349-7334

**AS-BUILT UTILITY  
PLAN**

DATE: February 09, 2003  
DATE: October 11, 2001  
DWG: Chakmakjian / AmTitle  
PROJECT NO. MG205  
ISSUE LOG:  
1.  
2.  
3.

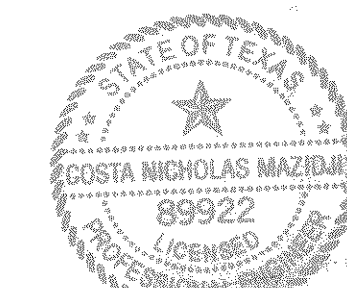

Sheet No.

**C4**

Sheet 4 of 9