

LINE TABLE

NUMBER	DIRECTION	DISTANCE
L1	S 81°31'37\"	33.87'
L2	N 49°47'37\"	8.32'
L3	N 56°59'00\"	12.48'
L4	N 12°21'55\"	26.65'
L5	S 79°09'40\"	16.18'
L6	N 81°31'37\"	15.93'
L7	N 39°39'13\"	40.13'
L8	S 12°21'55\"	12.00'
L9	S 10°36'00\"	49.49'
L10	N 79°24'00\"	17.98'
L11	S 10°13'44\"	9.78'
L12	S 79°28'58\"	10.05'
L13	S 10°36'02\"	15.00'
L14	N 79°28'58\"	9.95'
L15	S 10°13'44\"	29.95'
L16	S 79°28'59\"	45.51'
L17	N 10°36'01\"	62.64'
L18	N 79°28'59\"	27.75'
L19	S 10°36'02\"	35.50'
L20	N 79°24'00\"	18.18'
L21	S 09°32'52\"	59.70'
L22	N 88°26'07\"	34.84'
L23	N 88°26'22\"	32.06'

CURVE TABLE

NUMBER	DELTA	RADIUS	LENGTH	CHORD BEARING	CHORD
C1	00°13'48\"	3770.00'	15.14'	S 12°03'06\"	15.14'
C2	05°33'48\"	30.00'	2.91'	S 80°50'34\"	2.91'
C3	88°17'24\"	20.00'	30.82'	S 33°54'58\"	27.86'
C4	88°14'39\"	20.00'	30.80'	S 54°21'04\"	27.85'
C5	08°04'13\"	30.00'	3.18'	N 78°29'31\"	3.18'
C6	00°13'50\"	3770.00'	15.17'	S 08°24'21\"	15.17'
C7	49°46'58\"	20.00'	17.38'	N 14°39'44\"	16.84'
C8	08°59'11\"	20.00'	3.10'	S 05°47'09\"	3.10'

COORDINATE NOTE
 Coordinates shown hereon are State Plane Coordinates, Texas North Central Zone, North American Datum of 1983 (NAD83).

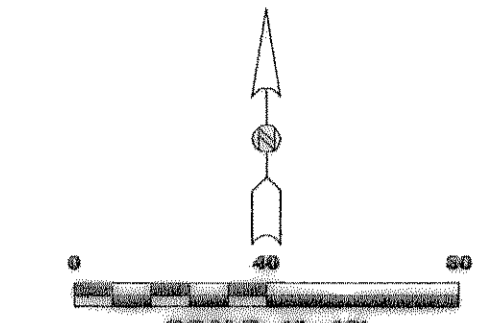

LEGEND
 5/8\" I.R.S. 5/8\" IRON ROD SET WITH PLASTIC CAP STAMPED 'R.P.L.S. 5199'
 D.R.R.C.T. DEED RECORDS, ROCKWALL COUNTY, TEXAS
 I.R.F. IRON ROD FOUND
 M.R.R.C.T. MAP RECORDS, ROCKWALL COUNTY, TEXAS
 P.O.B. POINT OF BEGINNING
 R.O.W. RIGHT-OF-WAY

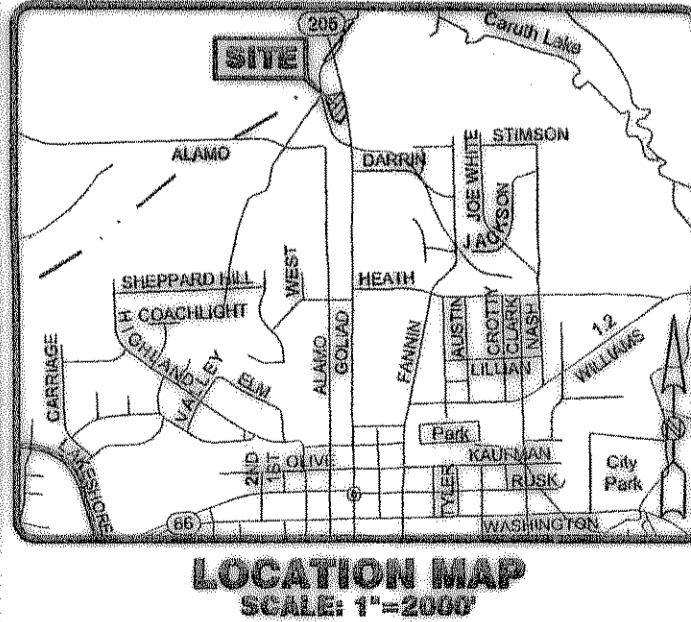

FINAL PLAT
BURKS ADDITION, LOT 2
 out of
 S.S. McCURRY SURVEY, ABSTRACT No. 146
 CITY OF ROCKWALL, ROCKWALL COUNTY, TEXAS

OWNER:
 THE AMERICAN NATIONAL
 BANK OF TEXAS
 19 W. Moore Avenue
 Terrell, Texas 75160

PROJECT INFORMATION
 Date of Survey: 02/24/2006
 Date of Drawing: 04/13/2006
 Job Number: 06101169
 Drawn By: M.M.D.
 File: Final Plat.Dwg
SHEET 1 OF 2



811 E. Plano Parkway
 Suite 117
 Plano, Texas 75074
 (972) 424-7002 Voice
 (972) 633-1702 Fax
 WWW.SurveyConsultantsInc.Com

FILED FOR RECORD
 ROCKWALL CO. TEXAS
 06 APR - 3 AM 2006
 PAUL DA CLEGG
 COUNTY CLERK

Burks Addition,
 Lot 2

F385

THILLIAMS 10/13/2006 - 10:27AM
 S:\JOBS\1200-1269\1269-06-015\DWG\1269-07A.DWG