

Revision	Date	Description
1	6/26/08	Storm Sewer Rev.

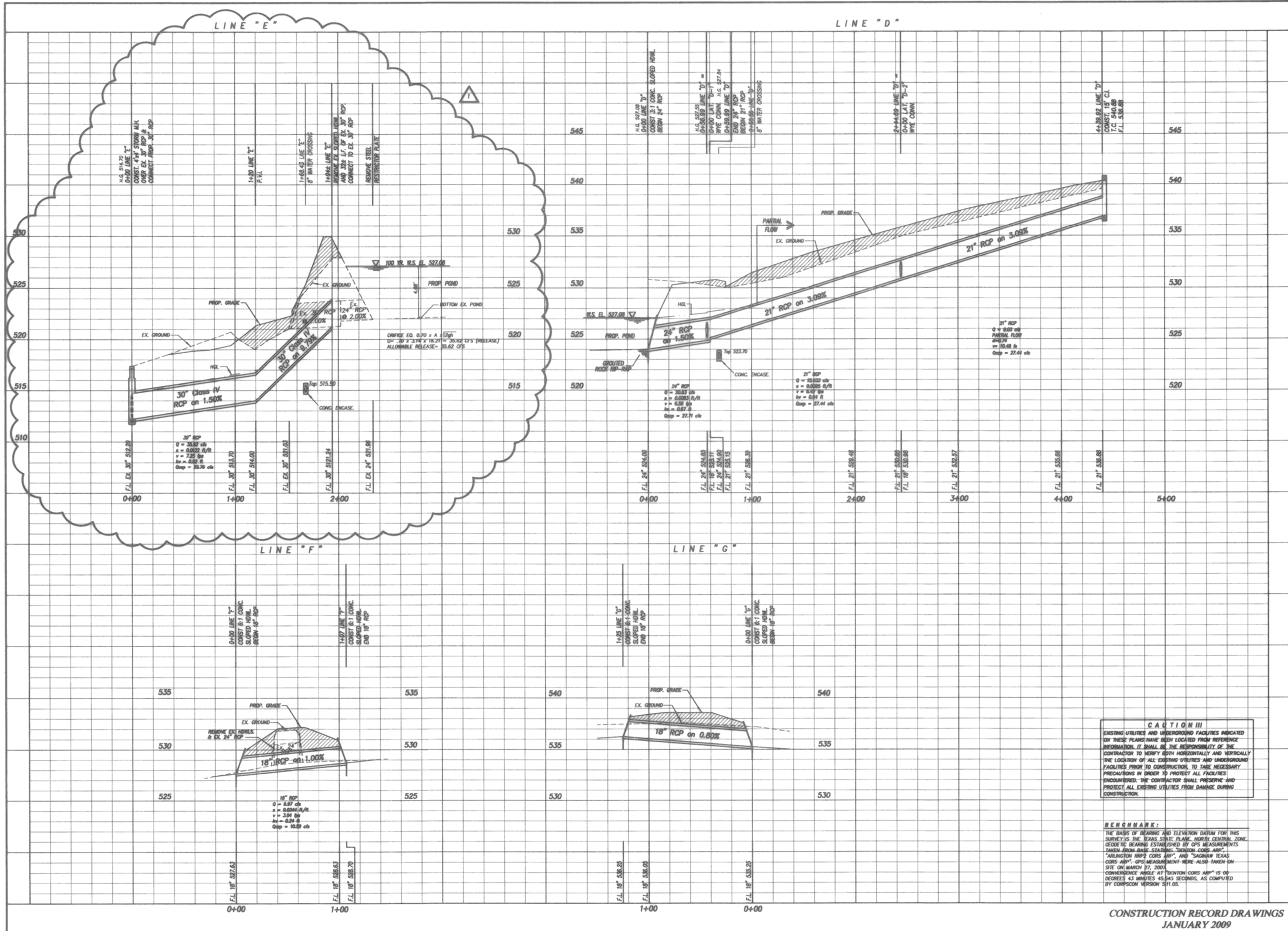

Owner:
Whittle Development Co.
 PO Box 369 • Rockwall, Texas • 75087
 Phone: 972-771-5253

**ALLIANCE
 ADDITION**

F.C. CUNY CORPORATION
 #2 Horizon Court • Ste. 500 • Heath, Texas 75032
 Phone: 469-402-7700
 Fax: 469-402-0700

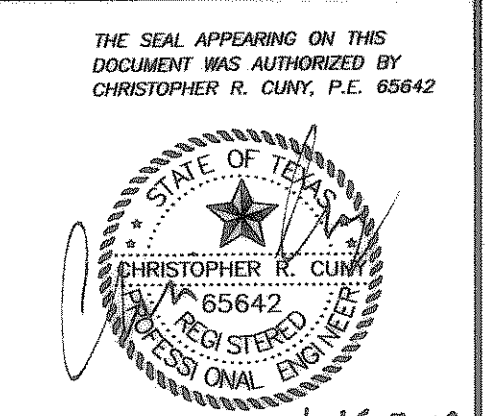

CAUTION!!!
 EXISTING UTILITIES AND UNDERGROUND FACILITIES INDICATED ON THESE PLANS HAVE BEEN LOCATED FROM REFERENCE INFORMATION. IT SHALL BE THE RESPONSIBILITY OF THE CONTRACTOR TO VERIFY BOTH HORIZONTALLY AND VERTICALLY THE LOCATION OF ALL EXISTING UTILITIES AND UNDERGROUND FACILITIES PRIOR TO CONSTRUCTION. TO THE NECESSARY PRECAUTIONS IN ORDER TO PROTECT ALL FACILITIES ENCOUNTERED. THE CONTRACTOR SHALL PRESERVE AND PROTECT ALL EXISTING UTILITIES FROM DAMAGE DURING CONSTRUCTION.

BENCHMARK:
 THE BASIS OF BEARING AND ELEVATION DATUM FOR THIS SURVEY IS THE TEXAS STATE PLANE, NORTH CENTRAL ZONE. GEODETIC BEARING ESTABLISHED BY GPS MEASUREMENTS TAKEN FROM BASE STATIONS "DENTON CORS ARP", "ARLINGTON RRP2 CORS ARP", AND "SAGINAW TEXAS CORS ARP". GPS MEASUREMENTS WERE ALSO TAKEN ON SITE ON MARCH 27, 2008. CONVERGENCE ANGLE AT "DENTON CORS ARP" IS 00 DEGREES 43 MINUTES 45.845 SECONDS, AS COMPUTED BY CORPCON VERSION 311.05.

Drawn By: F.C. CUNY	Checked By: F.C. CUNY
Date: 1-09	Project No.: 07-003
Sheet Title: Storm Sewer Profile Lines "D", "E", "F" & "G"	
Scale: 1" = 40'	Sheet No.: 12 of 15

**CONSTRUCTION RECORD DRAWINGS
 JANUARY 2009**

Z:\Projects\5-Residential\Whittle-Horizon\fcc design\hor-stomp\proj2.dwg Mon Jan 12 11:22:46 2009