

**LINE LEGEND:**

- PROPERTY LINE
- DRAINAGE FLOW
- PROPOSED WATER LINE
- ROAD CENTER LINE
- PROPOSED STORM SEWER
- PROPOSED STREET
- - - - - EXISTING CONTOUR LINE
- - - - - PROPOSED CONTOUR LINE
- - - - - BUILDING SETBACK LINE
- - - - - DRAINAGE EASEMENT
- - - - - DRAINAGE DIVIDE LINE
- - - - - ROW / LOT LINE
- - - - - PROPOSED FENCE

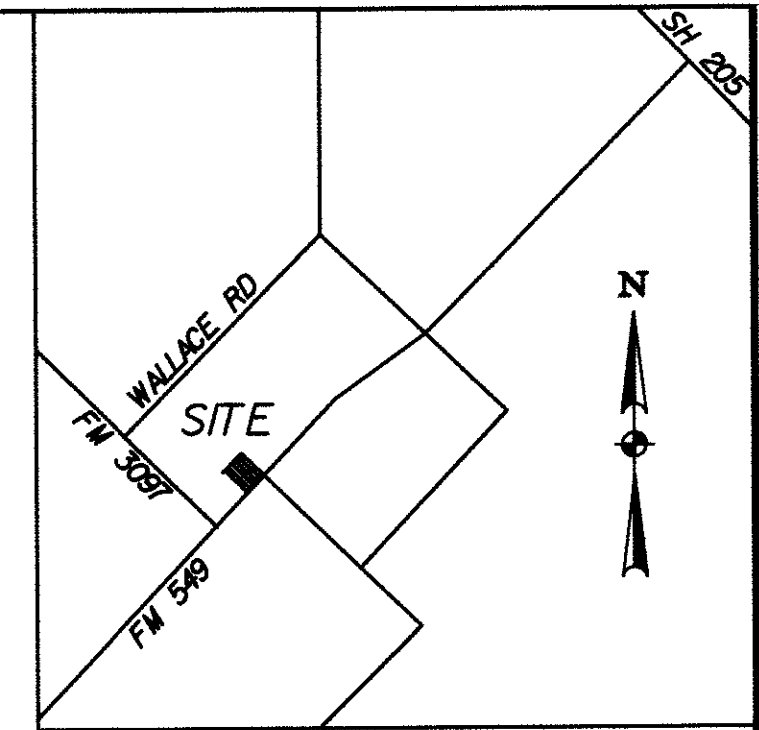

VICINITY MAP  
NOT TO SCALE

- GENERAL NOTES:**
1. EROSION CONTROL DEVICES AS SHOWN ON THE EROSION CONTROL PLAN FOR THE PROJECT SHALL BE INSTALLED PRIOR TO THE START OF LAND DISTURBING ACTIVITIES ON THE PROJECT.
  2. ALL EROSION CONTROL DEVICES ARE TO BE INSTALLED IN ACCORDANCE WITH THE APPROVED PLANS AND SPECIFICATIONS FOR THE PROJECT. CHANGES ARE TO BE APPROVED BEFORE CONSTRUCTION BY THE DESIGN ENGINEER AND THE CITY.
  3. IF THE EROSION CONTROL PLAN AS APPROVED CANNOT CONTROL EROSION AND OFF-SITE SEDIMENTATION FROM THE PROJECT THE EROSION CONTROL PLAN WILL BE REVISED AND/OR ADDITIONAL EROSION CONTROL DEVICES WILL BE REQUIRED ON SITE.
  4. IF OFF-SITE SOIL BORROW OR SPOIL SITES ARE USED IN CONJUNCTION WITH THIS PROJECT, THIS INFORMATION SHALL BE DISCLOSED AND SHOWN ON THE EROSION CONTROL PLAN. OFF-SITE BORROW AND SPOIL AREAS ARE CONSIDERED A PART OF THE PROJECT SITE AND THEREFORE SHALL COMPLY WITH THE CITY EROSION CONTROL REQUIREMENTS. THESE AREAS SHALL BE STABILIZED WITH PERMANENT GROUND COVER PRIOR TO FINAL APPROVAL OF THE PROJECT.
  5. TOTAL PROJECT AREA = 0.57 ACRES  
DISTURBED AREA = 0.57 ACRES
  6. SEE CITY EROSION AND SEDIMENT CONTROL MANUAL FOR LATEST BMP DEVICE STANDARDS AND SPECIFICATIONS.

**LEGEND:**

- SILT FENCE (NO WOODEN STAKES)
- TEMPORARY STONE CONSTRUCTION ENTRANCE/EXIT  
MIN 12" THICK WITH 4" STONE (NO CRUSHED CONCRETE PER CITY)
- INLET PROTECTION

**BMP MAINTENANCE SCHEDULE**

BMP	MAINTENANCE FREQUENCY	BY:
SILT FENCE/STONE OVERFLOW	WEEKLY/AFTER RAINS	CONTRACTOR
CONST ENTRANCE	WEEKLY/AFTER RAINS	CONTRACTOR
INLET PROTECTION	WEEKLY/AFTER RAINS	CONTRACTOR

AS-BUILT DRAWING 07-05-17

THIS DOCUMENT IS SUBMITTED AS AN "AS-BUILT DRAWING" FOR RECORD PURPOSES ONLY. TO THE BEST OF OUR KNOWLEDGE HELMBERGER ASSOCIATES, INC. STATES THAT THIS PLAN IS ASBUILT. THIS INFORMATION IS BASED ON LIMITED ASBUILT SURVEYING AT THE SITE PROVIDED BY OTHERS AND INFORMATION PROVIDED BY THE OWNER/CONTRACTOR. CONSTRUCTION SUPERVISION WAS PERFORMED BY OTHERS. TBPE FIRM NO. 000756

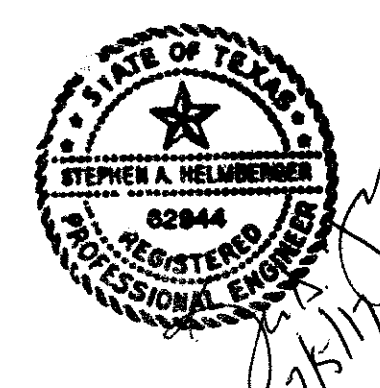

**OWNER:**  
RANDALL NOE ENTERPRISES INC.  
P.O. BOX 369  
ROCKWALL, TEXAS 75087  
MR. ROB WHITTLE  
(972) 771-5253

**ENGINEER:**  
HELMBERGER ASSOCIATES, INC.  
1525 BOZMAN ROAD  
WYLIE, TEXAS 75098  
MR. STEPHEN A. HELMBERGER, P.E.  
(972) 442-7459

REV.	BY:	REVISION

- EROSION CONTROL CONSTRUCTION PHASING:**
- PHASE 1 - TOP SOIL REMOVAL AND ROUGH GRADING
  - PHASE 2 - UTILITY INSTALLATION
  - PHASE 3 - BUILDING CONSTRUCTION
  - PHASE 4 - PAVING
  - PHASE 5 - LANDSCAPE AND IRRIGATION

**EROSION CONTROL CONSTRUCTION PLAN**

TYPE:	INSTALLATION:	REMOVAL:
CONSTRUCTION ENTRANCE	PRIOR TO STARTING	PRIOR TO PAVEMENT PLACEMENT
SILT FENCE/STONE OVERFLOW STRUCTURE	PRIOR TO STARTING	AFTER ESTABLISHING GRASS COVER
INLET PROTECTION	PRIOR TO STARTING	AFTER ESTABLISHING GRASS COVER

**EROSION CONTROL PLAN**

LOT 13 BLOCK 2 - ALLIANCE ADDITION PH 2

RANDALL NOE ENTERPRISES INC.

CITY OF ROCKWALL, TEXAS

**HELMBERGER ASSOCIATES, INC.**  
CIVIL AND ENVIRONMENTAL ENGINEERS  
1525 BOZMAN ROAD, WYLIE, TEXAS 75098 (972) 442-7459

DESIGN	DRAWN	DATE	SCALE	NOTES	FILE	NO.
HELM.	CADD	JUNE 2015	1"=30'	ERBB	1507	C5