

Curve No.	Radius	Arc Length	Delta	Chrd. Brng.	Chrd. Dist.
C1	20.50'	23.78'	66°28'12"	N46°35'02"W	22.47'
C2	20.50'	10.94'	30°34'12"	S59°33'13"E	10.81'
C3	44.50'	27.61'	35°33'00"	N62°02'37"W	27.17'
C4	20.50'	12.66'	35°23'36"	S62°07'20"E	12.46'
C5	44.50'	27.49'	35°23'36"	S62°07'20"E	27.05'
C6	49.00'	55.96'	65°25'45"	S11°42'39"E	52.96'
C7	25.00'	28.55'	65°25'45"	S11°42'39"E	27.02'
C8	112.17'	35.14'	17°57'05"	N12°01'41"E	35.00'
C9	88.17'	25.59'	16°37'46"	N12°41'21"E	25.50'
C10	10.00'	13.98'	80°05'50"	N35°40'28"W	12.87'
C11	50.00'	33.86'	38°48'06"	N16°20'55"W	33.22'

- Notes:**
- According to the Flood Insurance Rate Map of Rockwall County, Texas, Map No. 48397C0105L, Map Revised September 26, 2008, the herein described property is located in Zone "X", described by said map to be, "areas determined to be outside the 0.2% annual chance floodplain".
 - Bearings are based on the most easterly south line of ALLIANCE ADDITION PH. 2, an addition to the City of Rockwall, Rockwall County, Texas, as recorded in Cabinet G, Slides 301 and 302, of the Plat Records, Rockwall County, Texas.
 - State Plane Coordinates shown on this plat are per the plat of ALLIANCE ADDITION PH. 2, an addition to the City of Rockwall, Rockwall County, Texas, as recorded in Cabinet G, Slides 301 and 302, of the Plat Records, Rockwall County, Texas. North Central Zone (4202).
 - It shall be the policy of the City of Rockwall to withhold issuing building permits until all streets, water, sewer and storm drainage systems have been accepted by the City. The approval of a plat by the City does not constitute any representation, assurance or guarantee that any building within such plat shall be approved, authorized or permit therefore issued, nor shall such approval constitute any representation, assurance or guarantee by the City of the adequacy and availability for water for personal use and fire protection within such plat, as required under Ordinance 83-54.

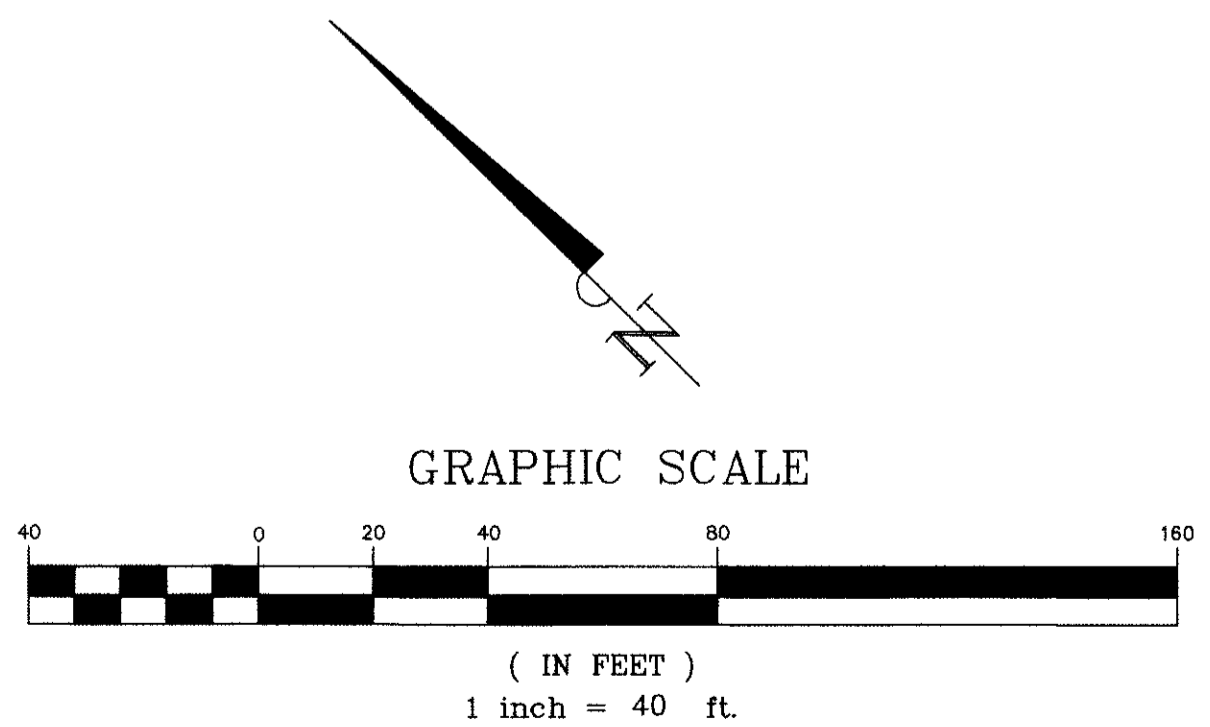
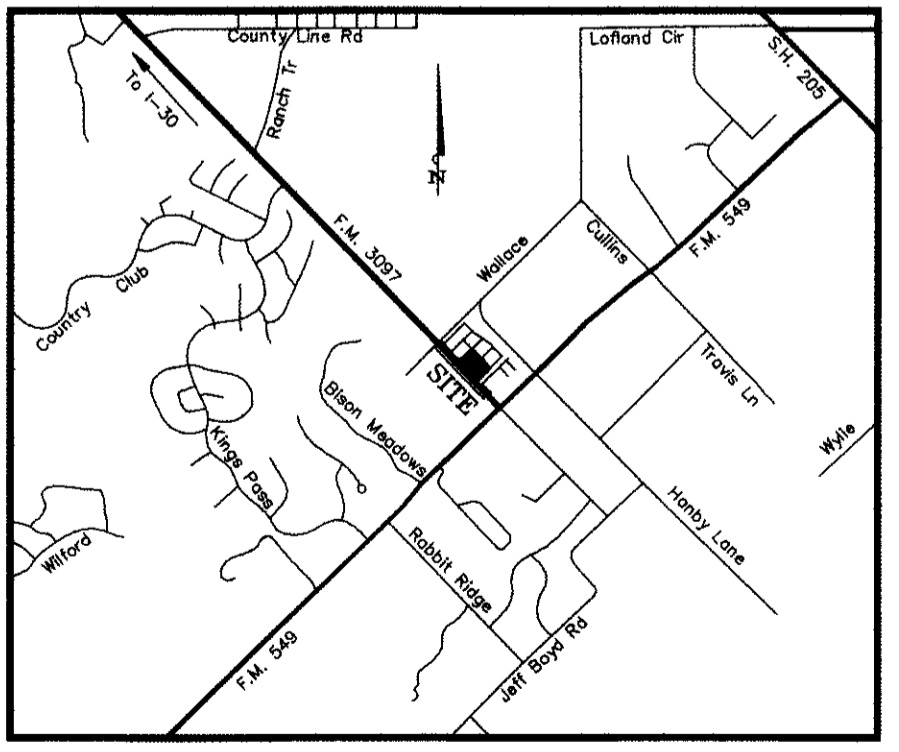

FINAL PLAT
LOT 13, BLOCK 2
ALLIANCE ADDITION PH. 2
 1 LOT
 24,876 SQ. Ft. / 0.571 ACRES
 BEING A REPLAT OF
 LOT 4, BLOCK 2
 ALLIANCE ADDITION PH. 2, AN ADDITION
 TO THE CITY OF ROCKWALL, TEXAS
 OUT OF THE
 W.W. FORD SURVEY, ABSTRACT NO. 80
 ROCKWALL COUNTY, TEXAS

Scale: 1" = 40'
 SHEET: 1 OF 2
 Date: June 2015
 CASE NO. P2015-XXX

DATE: 05/27/2015	SCALE: 1" = 40'	DRAWN BY: C.S.H.	CHK'D BY: M.B.A.	JOB NO.: 2013-0030
------------------	-----------------	------------------	------------------	--------------------