

RECORD DRAWING

THIS RECORD DRAWING TO THE BEST OF OUR KNOWLEDGED BURGESS AND NIPLE, INC. 3 SUGAR CREEK CENTER BOULEVARD, SUITE 610 SUGAR LAND, TEXAS 77478. HEREBY STATES THIS PLAN IS AS-BUILT. THIS INFORMATION PROVIDED IS BASED ON SURVEYING AT THE SITE AND INFORMATION PROVIDED BY THE CONTRACTOR.

[Signature]
THOMAS A. LUNZMAN P.E.

02/08/2021
DATE

BURGESS & NIPLE
10701 CORPORATE DR., SUITE 118
STAFFORD, TEXAS 77477
PHONE: (281) 980-7705
TXPE FIRM REGISTRATION NO. F-10884

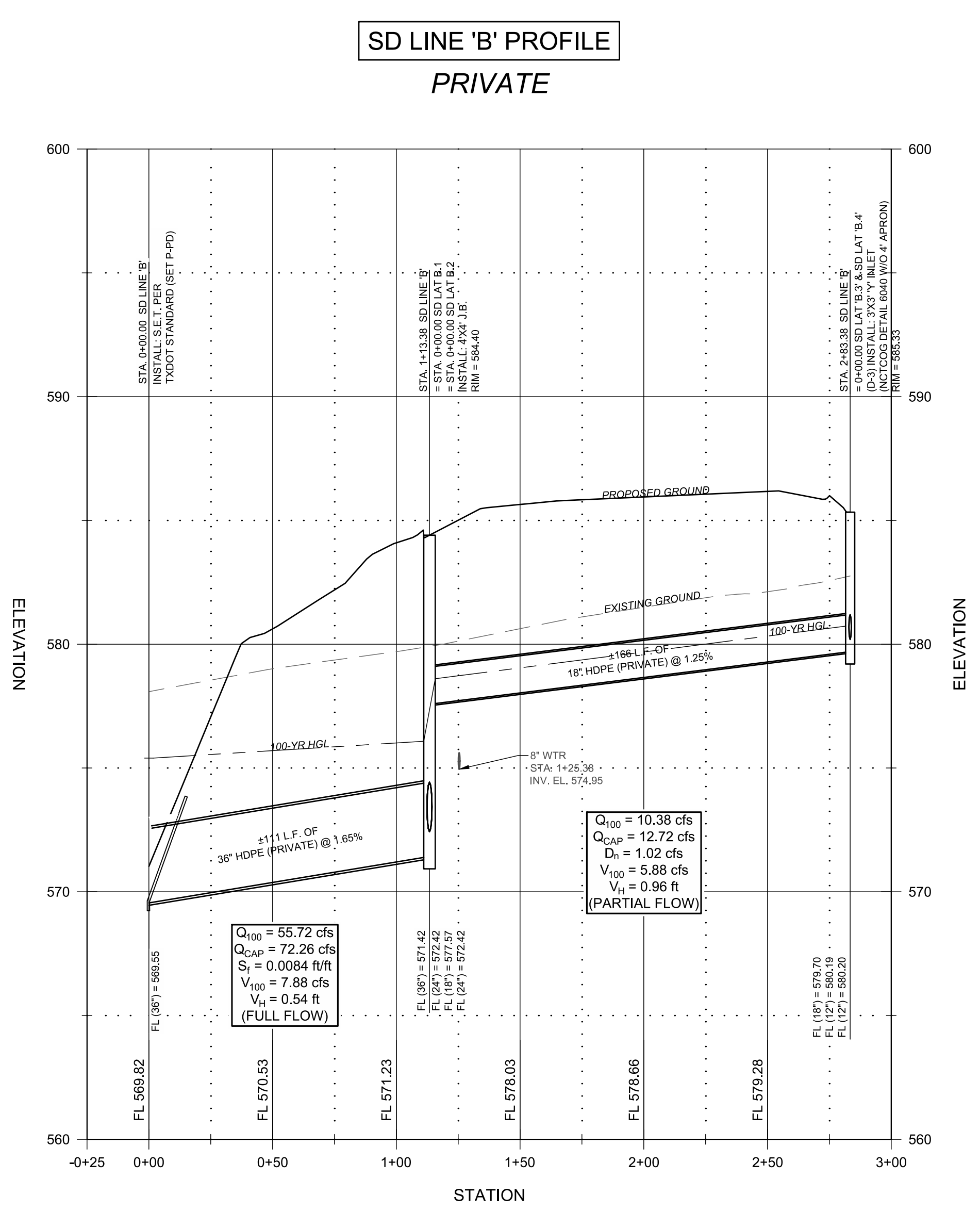
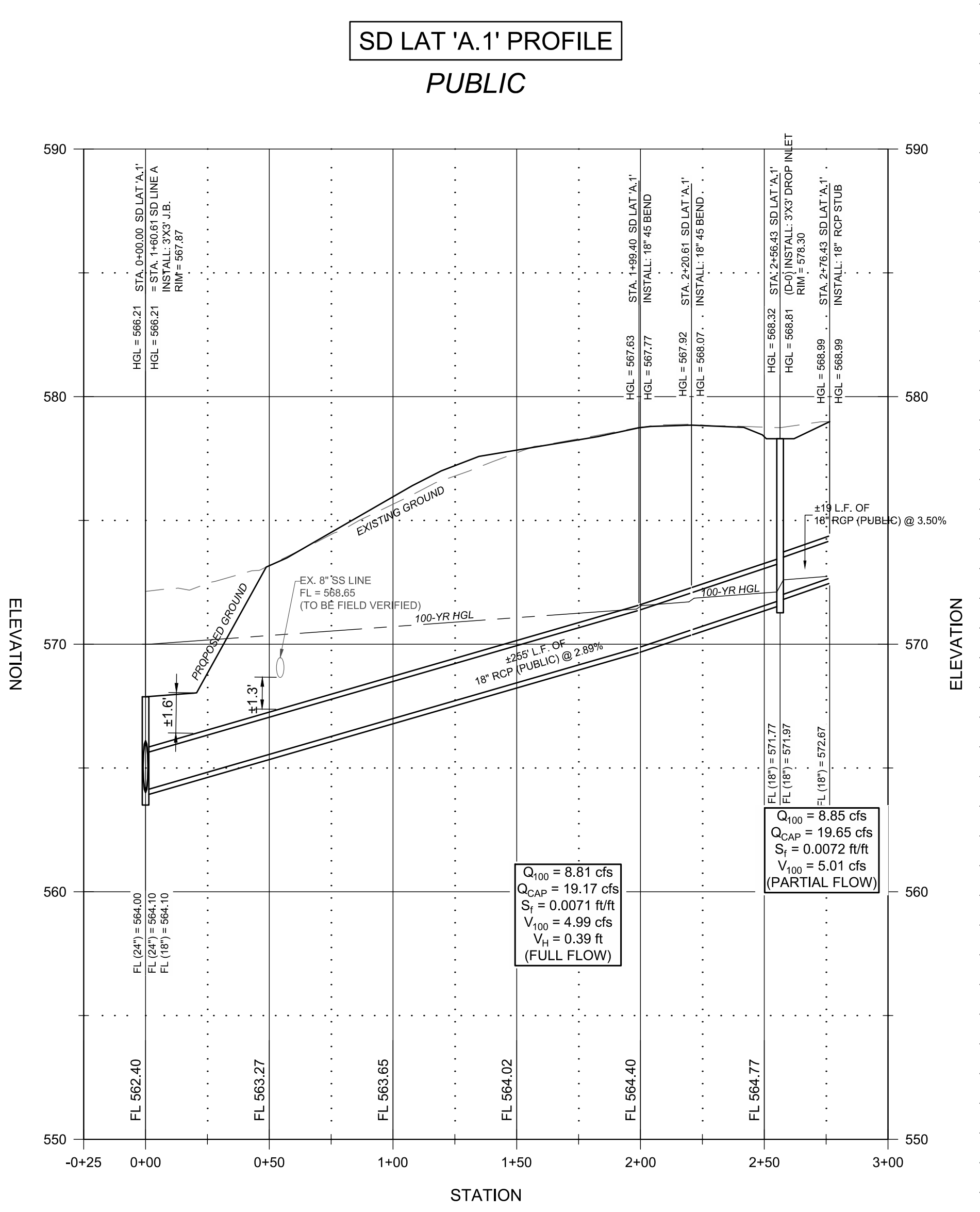
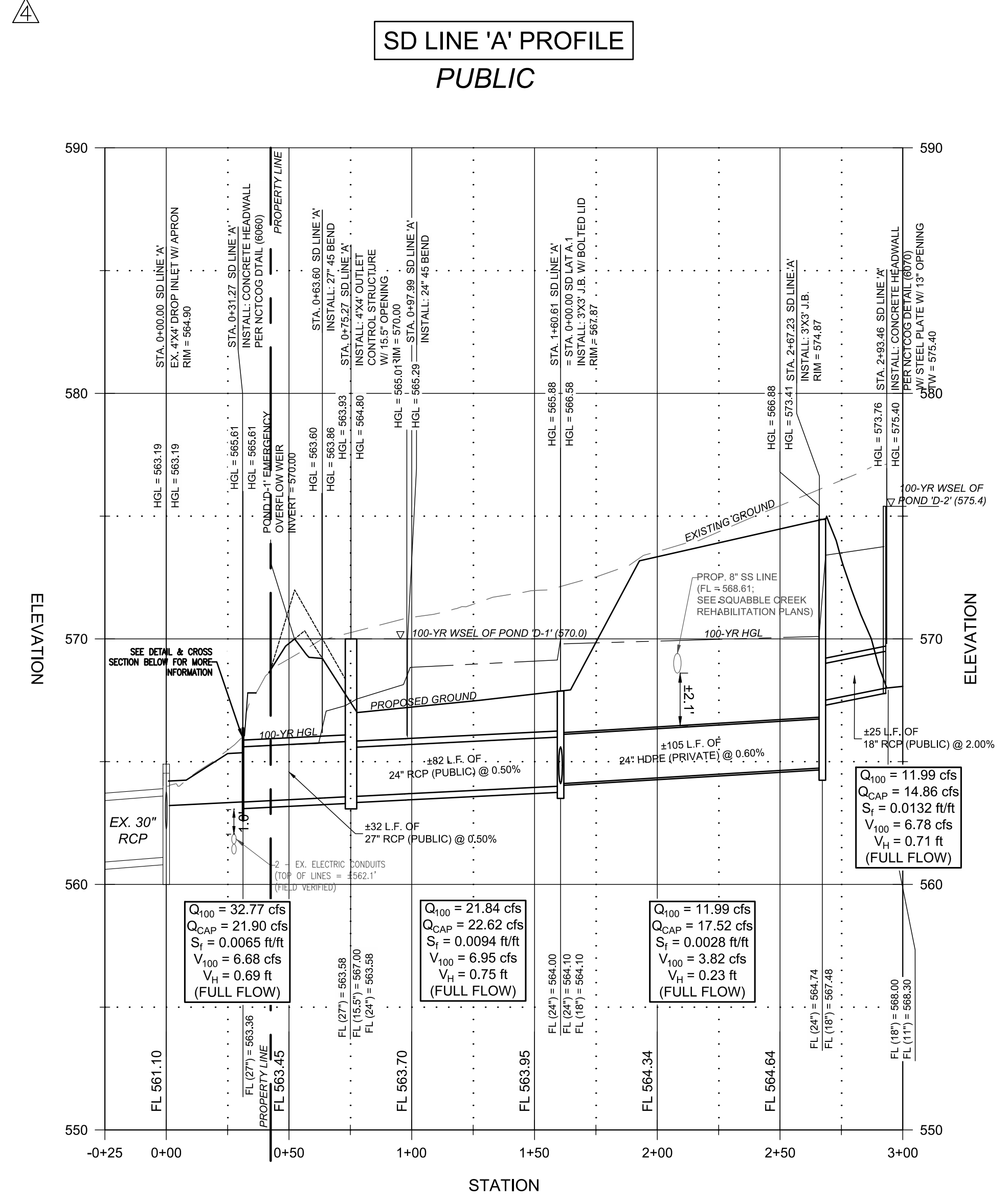

BENCHMARK
CITY 861
SITE B.M. CROSS CUT ON TOP OF CURB AT THE NORTHEAST DISTRICT BUILDING 95 SOUTH-WESTERLY FROM THE CENTER OF TOWN SQUARE & 540 SOUTH-WESTERLY FROM THE CENTER OF TOWN SQUARE
N: 1023100.873 E: 2989900.421 ELEV. = 953.32
SITE B.M. T.W.O. CROSS CUT IN SIDEWALK AT SOUTH-WESTERLY FROM THE CENTER OF TOWN SQUARE & 540 SOUTH-WESTERLY FROM THE CENTER OF TOWN SQUARE
N: 1023100.873 E: 2989900.421 ELEV. = 956.72

STORM DRAINAGE PROFILES (SHEET 1 OF 3)
ALDERS AT ROCKWALL SENIOR INDEPENDENT LIVING COMMUNITY

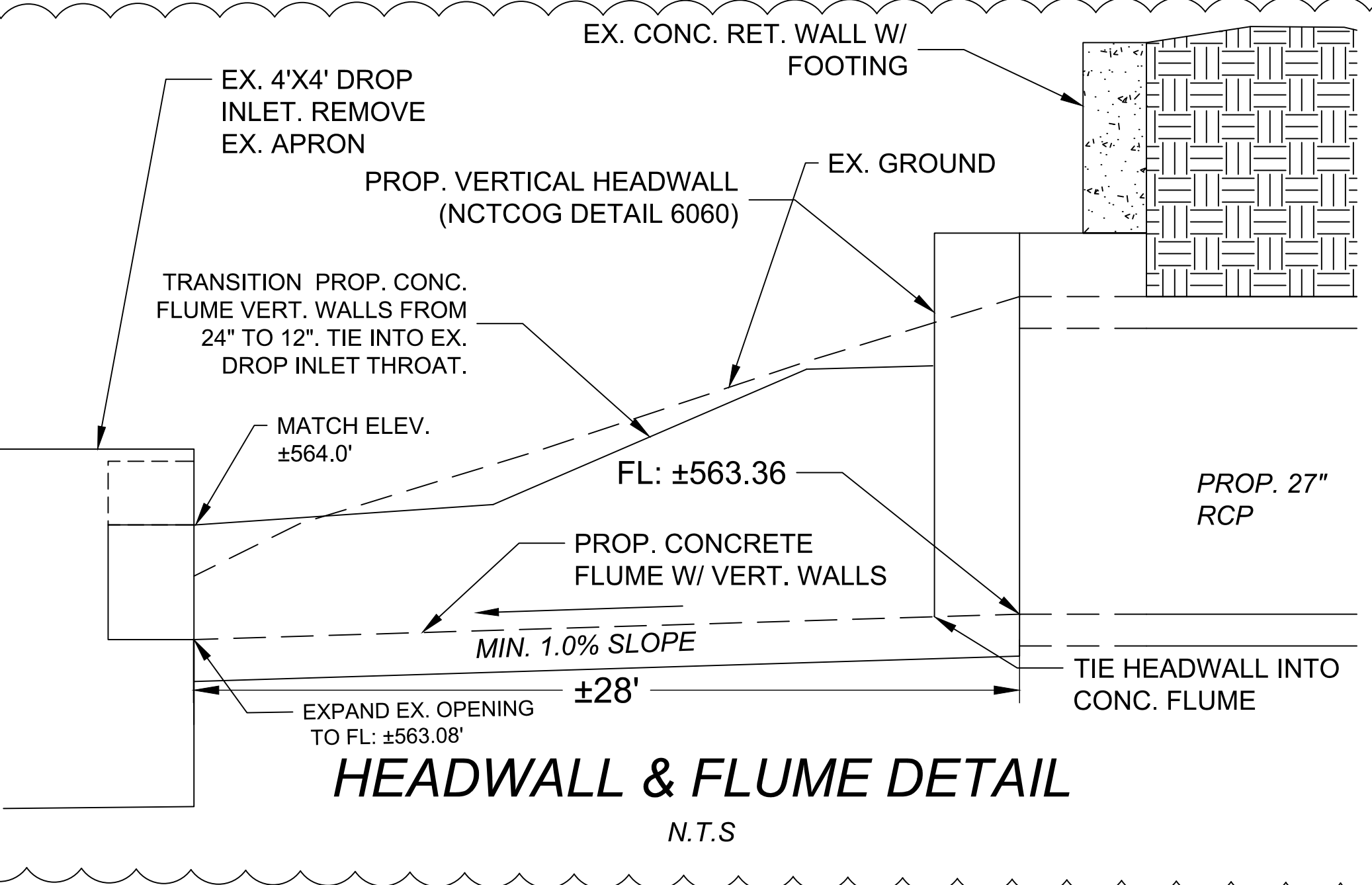
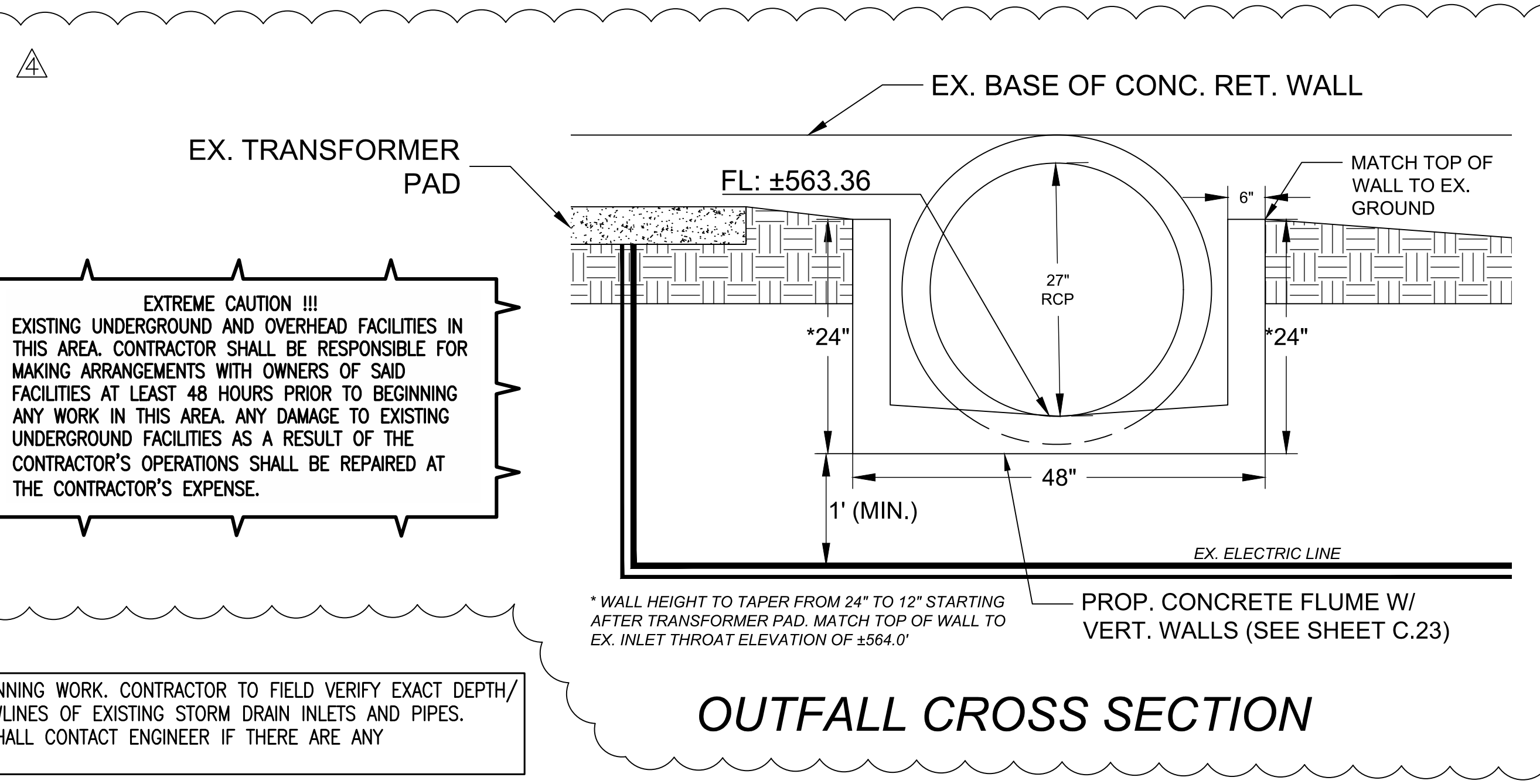

EXTREME CAUTION !!!
EXISTING UNDERGROUND AND OVERHEAD FACILITIES IN THIS AREA. CONTRACTOR SHALL BE RESPONSIBLE FOR MAKING ARRANGEMENTS WITH OWNERS OF SAID FACILITIES AT LEAST 48 HOURS PRIOR TO BEGINNING ANY WORK IN THIS AREA. ANY DAMAGE TO EXISTING UNDERGROUND FACILITIES AS A RESULT OF THE CONTRACTOR'S OPERATIONS SHALL BE REPAIRED AT THE CONTRACTOR'S EXPENSE.

PRIOR TO BEGINNING WORK, CONTRACTOR TO FIELD VERIFY EXACT DEPTH/LOCATION, FLOWLINES OF EXISTING STORM DRAIN INLETS AND PIPES. CONTRACTOR SHALL CONTACT ENGINEER IF THERE ARE ANY DISCREPANCIES.

NOTE:

1 ALL RESPONSIBILITY FOR ADEQUACY OF DESIGN REMAINS WITH THE DESIGN ENGINEER. THE CITY OF ROCKWALL, IN REVIEWING AND RELEASING PLANS FOR CONSTRUCTION, ASSUMES NO RESPONSIBILITY FOR ADEQUACY OR ACCURACY OF DESIGN.

2 ANY & ALL DETAILS NOT PROVIDED WITH THESE CONSTRUCTION DRAWINGS, SHALL COME FROM CITY OF ROCKWALL STANDARDS OF DESIGN AND CONSTRUCTION & NCTCOG PUBLIC WORKS CONSTRUCTION STANDARDS FOURTH EDITION.

NO.	REVISIONS	DATE	BY	CHK
1	UPDATE WATERLINE LAYOUT	02/21/19	TAL	TAL
2	MINOR HUD/OWNER COMMENTS	05/17/19	TAL	TAL
3	REV. TO SIDEWALKS & COURTYARD (STORM) PER LANDSCAPE	07/17/19	KTM	TAL
4	REV. TO EX. STORM TIE-IN ELEVATION AND SD LINE 'A' (PUBLIC)	09/19/19	KTM	TAL
		09/19/19		
		07/17/19		

DESIGNED BY: TAL
DRAWN BY: NRM/TAL
APPROVED BY: TAL
CHECKED BY: JTR
DATE: 01/29/2019
SCALE: H: 1"=40', V: 1"=4'
SHEET NUMBER: C.14 OF 23