

# CONSTRUCTION PLANS

## FOR

# ALDERS AT ROCKWALL

## LOT 1, BLOCK A

### IN THE

# CITY OF ROCKWALL,

# ROCKWALL COUNTY, TEXAS

ESTIMATED CONSTRUCTION START DATE: JANUARY 2019

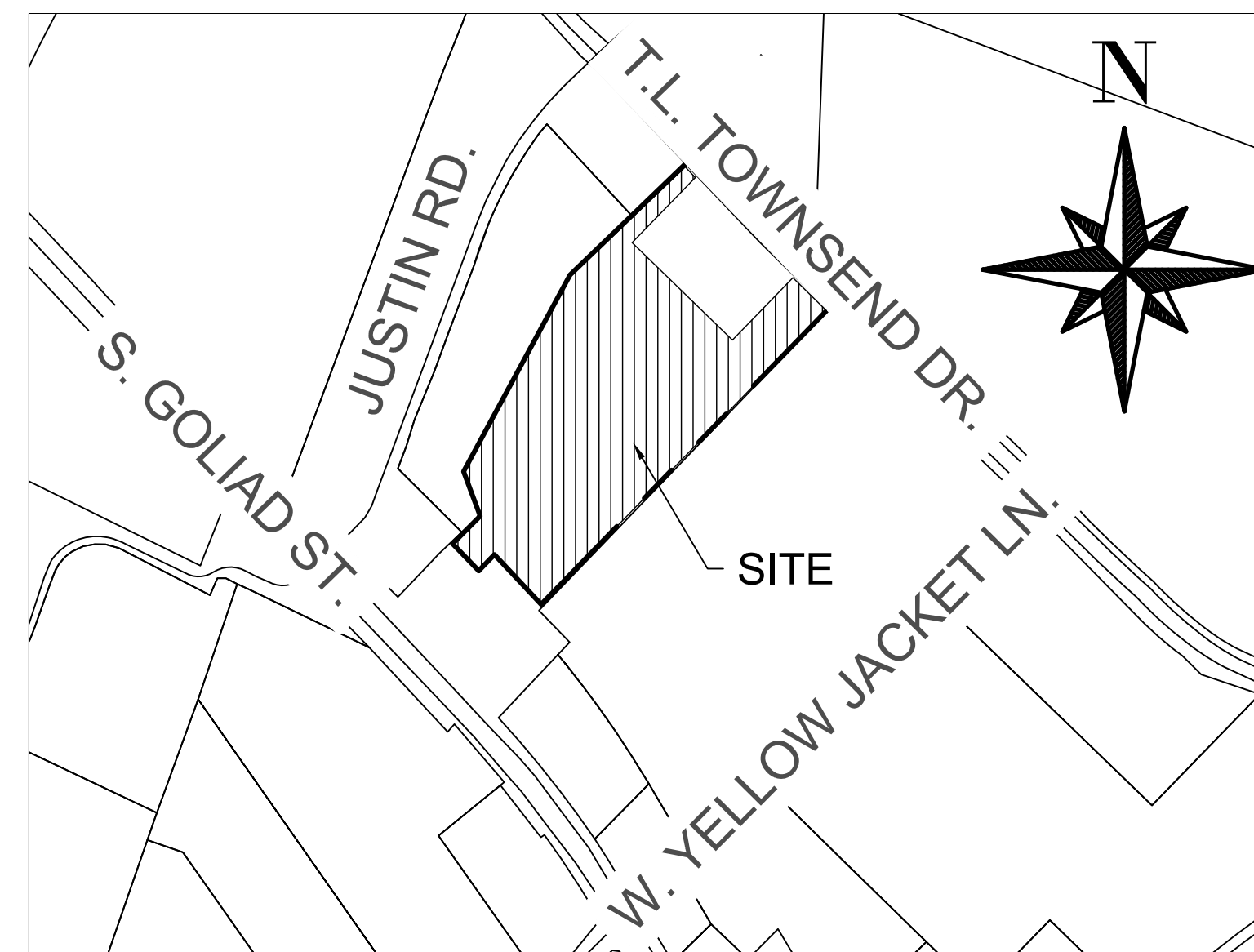

LOCATION MAP  
N.T.S.

DEVELOPER:  
ALDERS AT ROCKWALL  
PROPERTY, LLC  
1625 CLARK SPRINGS DR.  
ALLEN, TEXAS 75002  
(469) 446-1276  
CONTACT: BART TINSLEY

ARCHITECT:  
ARCHITECTURA, INC.  
808 18TH STREET  
PLANO, TEXAS 75074  
(972) 509-0088  
CONTACT: FRANK POLLACIA

OWNER:  
ALDERS AT ROCKWALL  
PROPERTY, LLC  
1625 CLARK SPRINGS DR.  
ALLEN, TEXAS 75002  
(469) 446-1276  
CONTACT: BART TINSLEY

SURVEYOR:  
MILLER SURVEYING, INC.  
430 MID CITIES BLVD. HURST,  
TEXAS 76054  
(817) 577-1052  
CONTACT: JASON RAWLINGS

CIVIL ENGINEER:

## BURGESS & NIPLE

10701 CORPORATE DRIVE, SUITE 118  
STAFFORD, TX 77477  
PHONE: (281)980-7705  
TBPE FIRM REGISTRATION NO. F-10834  
CONTACT: JOSEPH T. REU

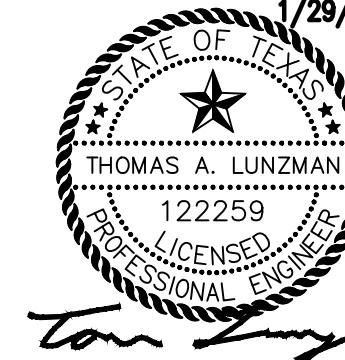

- ▲ 11/13/20
- ▲ 01/27/20
- ▲ 12/06/19
- ▲ 11/13/19
- ▲ 9/19/19
- ▲ 7/17/19
- ▲ 5/17/19
- ▲ 2/21/19
- ▲ 1/29/19

Sheet List Table	
Sheet Number	Sheet Title
C.01	COVER SHEET
C.02.A	FINAL PLAT (1 OF 3 - FOR REFERENCE ONLY)
C.02.B	FINAL PLAT (2 OF 3 - FOR REFERENCE ONLY)
C.02.C	FINAL PLAT (3 OF 3 - FOR REFERENCE ONLY)
C.03	SITE PLAN
C.04	GENERAL NOTES
C.05	DIMENSION CONTROL & PAVING PLAN
C.06	TRAFFIC CONTROL PLAN
C.07	EROSION CONTROL PLAN
C.08	GRADING PLAN (SHEET 1 OF 2)
C.09	GRADING PLAN (SHEET 2 OF 2)
C.10	DRAINAGE AREA MAP (PRE)
C.11	DRAINAGE AREA MAP (POST)
C.12	DRAINAGE CALCULATIONS
C.13	STORM DRAINAGE PLAN
C.14	STORM DRAINAGE PROFILES (SHEET 1 OF 3)
C.15	STORM DRAINAGE PROFILES (SHEET 2 OF 3)
C.16	STORM DRAINAGE PROFILES (SHEET 3 OF 3)
C.17	STORM DETENTION PLAN
C.18	SANITARY SEWER PLAN
C.19	WATER PLAN
C.20	UTILITY PROFILES (SHEET 1 OF 2)
C.21	UTILITY PROFILES (SHEET 2 OF 2)
C.22	NCTCOG EROSION CONTROL DETAILS
C.23	NCTCOG STORMWATER DETAILS

- L0.01 LANDSCAPE/TREESCAPE PLAN
- L0.02 LANDSCAPE/TREESCAPE PLAN, NOTES & SPECIFICATIONS
- L0.03 OPEN SPACE/AMENITY PLAN

**RECORD DRAWING**

THIS RECORD DRAWING TO THE BEST OF OUR KNOWLEDGED BURGESS AND NIPLE, INC. 3 SUGAR CREEK CENTER BOULEVARD, SUITE 610 SUGAR LAND, TEXAS 77478, HEREBY STATES THIS PLAN IS AS=BUILT. THIS INFORMATION PROVIDED IS BASED ON SURVEIGN AT THE SITE AND INFORMATION PROVIDED BY THE CONTRACTOR.

THOMAS A. LUNZMAN P.E.

02/08/2021  
 DATE

NO.	REVISIONS	DATE	BY	CHK.
1	UPDATE WATERLINE LAYOUT	02/21/19	TAL	TAL
2	MINOR HUD/OWNER COMMENTS	05/17/19	TAL	TAL
3	REV. TO SIDEWALKS & COURTYARD (STORM) PER LANDSCAPE	07/17/19	KTM	TAL
4	REV. TO EX. STORM TIE-IN ELEVATION AND SD LINE 'A' (PUBLIC)	09/19/19	KTM	TAL
5	REV. CTYRD DRAINS, BF, SS, GAR	11/13/19	KTM	TAL
6	REV. GARAGE LOCATIONS EAST SIDE	12/06/19	NRM	TAL
7	REVISE GRADES @ MC ENTRANCE	01/27/20	NRM	TAL
8	REVISE GRADES @ SWALE ON SOUTH PL	11/13/20	TAL	TAL

**Burgess & Niple, Inc.**      Stafford, TX