

JOHNSTON - RAMSAY

ARCHITECTURE - MANAGEMENT

637 STAFFORD CIRCLE ROCKWALL, TEXAS 75087

AS BUILT
WASHINGTON ST.

ROCKWALL, TEXAS 75087

*ALL ELEMENTS OF THIS DRAWING ARE THE
INTELLECTUAL PROPERTY OF JOHNSTON-RAMSAY

DATE
MAR. 25, 2011

PROJECT
1209

site

INTERURBAN ST.

EXISTING ASPHALT PAVING

○ EXISTING GRADE 572.51

○ EXISTING GRADE 572.33

○ EXISTING GRADE 573.85

○ EXISTING GRADE 574.00

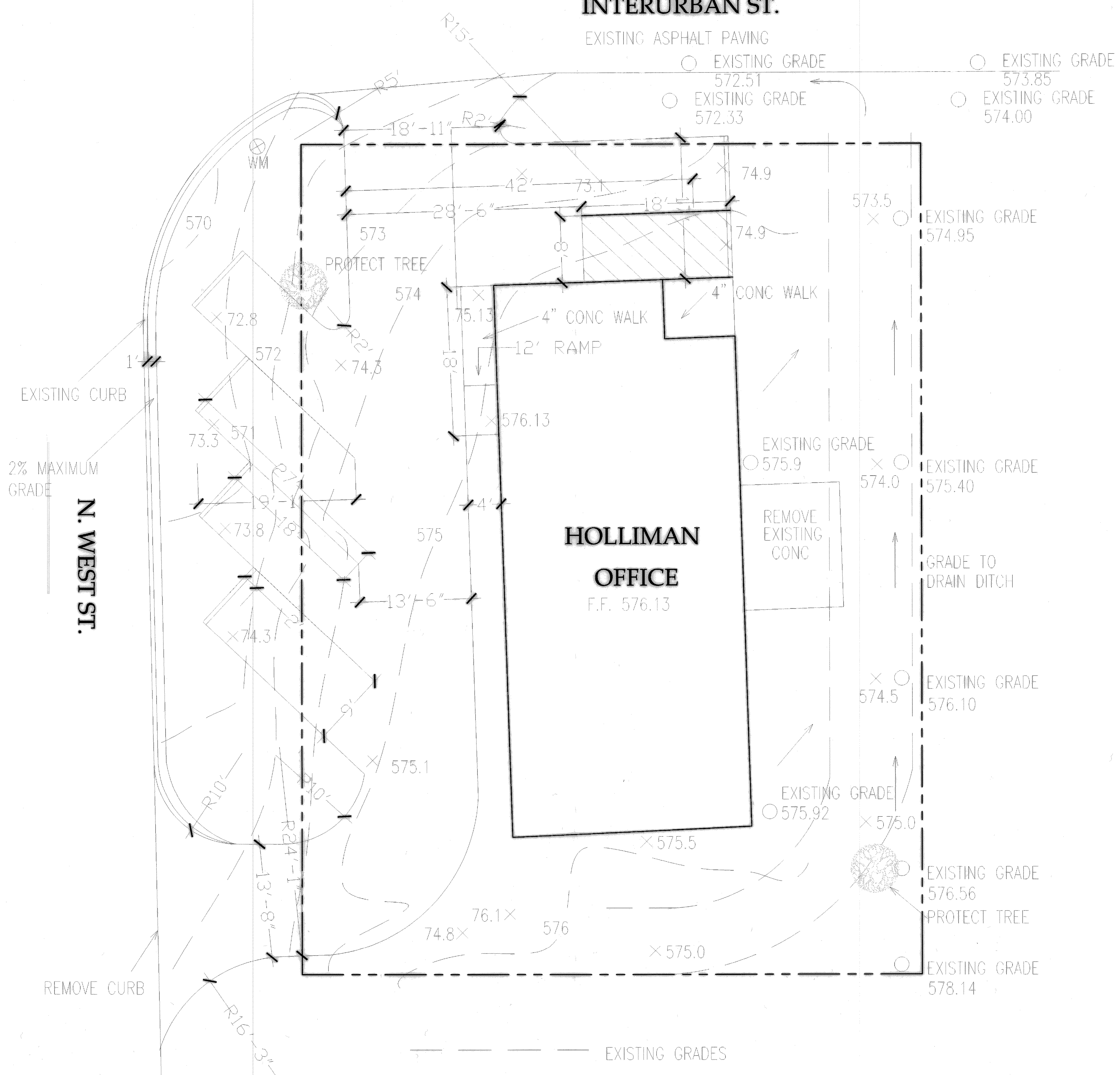

2% MAXIMUM GRADE

N. WEST ST.

HOLLIMAN OFFICE
F.F. 576.13

REMOVE EXISTING CONC

GRADE TO DRAIN DITCH

--- EXISTING GRADES

× FINAL GRADES

NOTE: PAVEMENT 5" - 3,600 PSI CONCRETE W/#3 BARS @ 18" CTRS
 SIDEWALK 4" - 3,600 PSI CONCRETE W/#3 BARS @ 18" CTRS
 6 1/2 SACK CONCRETE
 ALL FILL 95% COMPACTION

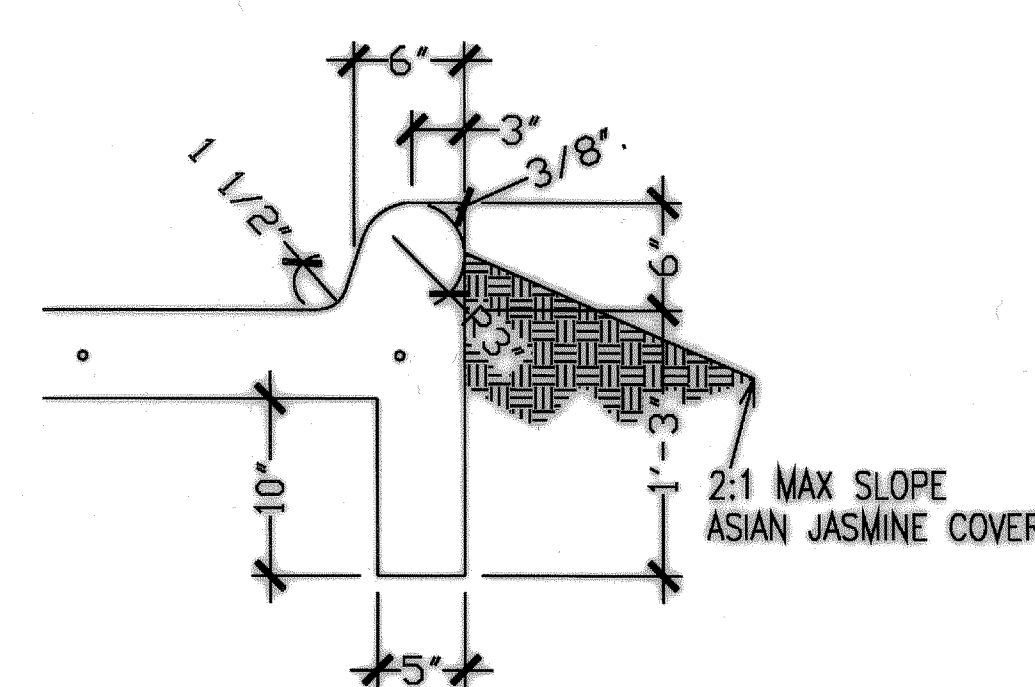

PAVEMENT SECTION WITH CURB @ PARKING

SCALE: 1/2" = 1'