

- ### UTILITY GENERAL NOTES
- THE CONTRACTOR SHALL ASSUME SOLE AND COMPLETE RESPONSIBILITY FOR HIS MEANS AND METHODS OF CONSTRUCTION, JOB SITE CONDITIONS AND JOB SITE SAFETY, INCLUDING SAFETY OF ALL PERSONS AND PROPERTY. THIS REQUIREMENT SHALL APPLY CONTINUOUSLY AND NOT BE LIMITED TO WORKING HOURS. THE CONTRACTOR SHALL SAVE, PROTECT, INDEMNIFY, DEFEND AND HOLD HARMLESS THE OWNER, THE ARCHITECT AND THE ENGINEER FROM ANY CLAIM OF LIABILITY, REAL OR ALLEGED, ARISING OUT OF THE PERFORMANCE OF ANY WORK ON THIS PROJECT. THE CONTRACTOR SHALL NAME THE OWNER, THE ARCHITECT AND THE ENGINEER AS "ADDITIONAL INSURED" ON HIS INSURANCE POLICIES.
 - EXISTING ABOVE GROUND UTILITIES HAVE BEEN SHOWN BASED ON INFORMATION SHOWN ON A SURVEY OF THE PROPERTY BY OTHERS. UNDERGROUND UTILITIES ARE SHOWN BASED ON RECORD DATA AND MAY NOT BE COMPLETE OR EXACT. THE CONTRACTOR SHALL BE RESPONSIBLE FOR VERIFYING THE LOCATIONS AND DEPTHS OF ALL ABOVE GROUND AND UNDERGROUND UTILITIES AND ESTABLISHING THEIR EXACT LOCATION AND DEPTH PRIOR TO SETTING ANY FINISH GRADE. THE CONTRACTOR SHALL BE RESPONSIBLE FOR DAMAGE TO EXISTING ABOVE GROUND OR UNDERGROUND UTILITIES, INCLUDING THOSE NOT SHOWN ON THE PLANS. THE CONTRACTOR IS ADVISED TO CONTACT THE CITY AND ALL FRANCHISE UTILITY COMPANIES, EASEMENT HOLDERS, ETC. AT LEAST 48 HOURS PRIOR TO BEGINNING EXCAVATION IN THE VICINITY OF ANY UNDERGROUND UTILITY.
 - WHEN WATER AND SEWER LINES ARE INSTALLED IN PROXIMITY TO ONE ANOTHER, SUCH INSTALLATION SHALL BE IN STRICT ACCORDANCE WITH THE RULES AND REGULATIONS OF THE TEXAS COMMISSION ON ENVIRONMENTAL QUALITY AND THE TEXAS DEPARTMENT OF HEALTH. SPECIAL ATTENTION IS CALLED TO REQUIREMENTS FOR BOTH LATERAL AND VERTICAL SEPARATION BETWEEN WATER AND SEWER FACILITIES.
 - THIS PROJECT TO BE BUILT IN ACCORDANCE WITH CITY STANDARDS, SPECIFICATIONS AND DETAILS FOR WATER AND SEWER CONSTRUCTION.
 - THE CONTRACTOR SHALL COMPLY WITH ALL BUILDING CODES AND REGULATIONS, FEDERAL STATE, COUNTY AND CITY SAFETY CODES AND INSPECTION REQUIREMENTS.
 - THE CONTRACTOR SHALL PROVIDE DUST PROTECTION DURING CONSTRUCTION. ALL TRASH AND DEBRIS SHALL BE PICKED UP AT ALL TIMES.
 - WATER METERS SHALL BE CONSTRUCTED ON CITY'S R.O.W./EASEMENT AND APPROVED BACKFLOW PREVENTION SHALL BE CONSTRUCTED ON PRIVATE PROPERTY ADJACENT TO WATER METER.
 - TRENCH SAFETY: IF ANY TRENCH ON THIS JOB SITE, INCLUDING OPEN EXCAVATIONS WHOSE DIMENSIONS CAUSE THEM TO BE CONSIDERED TRENCHES BY OSHA, REGARDLESS OF WHETHER FOR THE INSTALLATION OF UTILITIES, FOUNDATIONS OR ANY OTHER SITE ELEMENT, IS EQUAL TO OR GREATER THAN 5'00' DEPTH, THEN THE CONTRACTOR SHALL NOT PERFORM ANY TRENCHING ON THIS SITE UNTIL HE HAS FIRST OBTAINED DETAILED PLANS AND SPECIFICATIONS FOR TRENCH SAFETY SYSTEMS CONFORMING TO OSHA REQUIREMENTS. SUCH PLANS AND SPECIFICATIONS SHALL BE PREPARED BY A REGISTERED PROFESSIONAL ENGINEER EMPLOYED BY OR CONTRACTED BY THE CONTRACTOR AND SHALL BE CONSIDERED A PART OF THE CONTRACTOR'S MEANS AND METHOD'S OF CONSTRUCTION. IF THIS PROJECT IS OFFERED FOR BID, THE BIDS MUST CONTAIN A SEPERATE UNIT PRICE PAY ITEM FOR TRENCH SAFETY.
 - INSTALL 6" WIDE METALLIC TAPE ON TOP OF PIPING FOR ALL NON METALLIC WATER LINES, 12" MIN. BELOW GROUND SURFACE.
 - INSTALL 2" WIDE METALLIC TAPE ON TOP OF PIPING FOR ALL NON METALLIC SAN. SEW. LINES, 12" MIN. BELOW GROUND SURFACE.
 - POTABLE WATER LINES SHALL BE PVC IN ACCORDANCE WITH AWWA C-900, CLASS 200.
 - SANITARY SEWER LINES SHALL BE PVC IN ACCORDANCE WITH ASTM D3034.
 - VALVES UNDER 12" SHALL BE RESILJANT SEAT GATE VALVES.
 - WATER MAIN MATERIALS SHALL BE IN ACCORDANCE W/CITY OF ROCKWALL WATER SYSTEM DESIGN REQUIREMENTS.
 - SANITARY SEWER LINE MATERIAL SHALL BE IN ACCORDANCE W/CITY OF ROCKWALL SANITARY SEWER DESIGN REQUIREMENTS.

- ### NORTH TEXAS MUNICIPAL WATER DISTRICT (NTMWD) UTILITY NOTES
- FOR OPEN CUT, WHERE CROSSING UNDER THE NTMWD PIPELINE WITHIN TEN FEET EITHER SIDE OF THE CENTERLINE OF PIPELINE, THE TRNCH WIDTH TO BE CUT SHALL BE LIMITED TO FOUR-FOOT VERTICAL WALLS. NO SLOPING BANK WITH THE APPROPRIATE TRENCH SAFETY. THE ENTIRE EXCAVATION WITHIN THE LIMITS NOTED ABOVE SHALL BE BACKFILLED WITH GRAVEL TO ONE FOOT ABOVE TOP OF NTMWD PIPELINE. ONE-FOOT MINIMUM CLEARANCE IS REQUIRED BETWEEN NTMWD PIPELINE AND PROPOSED UTILITIES.
 - FOR BORING, THE LIMITS OF THE BORE SHALL BE A MINIMUM WIDTH OF THE NTMWD EASEMENT. A CASING PIPE JOINT SHALL BE CENTERED ON NTMWD'S PIPELINE.
 - THE CASING PIPE SHALL TERMINATE OUTSIDE OF NTMWD'S EASEMENT.
 - ANY EXCAVATION ADJACENT TO NTMWD PIPELINE AND APPURTENANCES TO INSTALL THE PROPOSED IMPROVEMENTS SHALL BE PERFORMED SO THAT THE PIPELINE OR APPURTENANCES ARE NOT DAMAGED. ANY DAMAGE TO THE PIPELINE OR APPURTENANCES SHALL BE REPAIRED TO THE SATISFACTION OF NTMWD. FURTHER, ANY COST FOR REPAIR OF DAMAGE TO THE PIPELINE OR APPURTENANCES RESULTING FROM CONSTRUCTION BY THE DEVELOPER OR CONTRACTOR SHALL BE THE RESPONSIBILITY OF THE DEVELOPER.
 - THE NTMWD EASEMENT RESTRICTS CONSTRUCTION OF PERMANENT STRUCTURES SUCH AS FOUNDATIONS, WALLS, POOLS AND PERMANENT STORAGE BUILDINGS. ITEMS SUCH AS DRIVEWAYS, FENCES, SPRINKLER SYSTEMS AND NORMAL LANDSCAPE PLANS THAT ENVOACH ON THE NTMWD EASEMENTS ARE ALLOWED. FENCE POST FOUNDATIONS ARE RESTRICTED TO AN INSTALLATION DEPTH OF NO DEEPER THAN 18 INCHES BELOW FINAL GROUND ELEVATION. HOWEVER, THE NTMWD ASSUMES NO RESPONSIBILITY FOR DAMAGES RESULTING FROM THE NEED TO REPAIR OR MAINTAIN THE NTMWD PIPELINES. FURTHER, ANY COST FOR REPAIR FOR DAMAGE TO THE PIPELINES RESULTING FROM CONSTRUCTION BY THE DEVELOPER, CONTRACTOR, OR OWNER WILL BE THE RESPONSIBILITY OF THE DEVELOPER, CONTRACTOR OR OWNER.
 - ALL WATER AND SANITARY SEWER CROSSINGS SHALL BE IN COMPLIANCE WITH THE TEXAS COMMISSION ON ENVIRONMENTAL RULES & REGULATIONS FOR PUBLIC WATER SYSTEMS - PARAGRAPH 290.44 (c).
- NOTE: USE TRENCH BOX IF REQUIRED FOR UTILITY INSTALLATION WORK. CONTACT PAUL LYDAY OF NTMWD ENGINEERING AT (972) 442-5405 48 IN ADVANCE TO SCHEDULE ANY WORK IN VICINITY OF NTMWD FACILITIES.

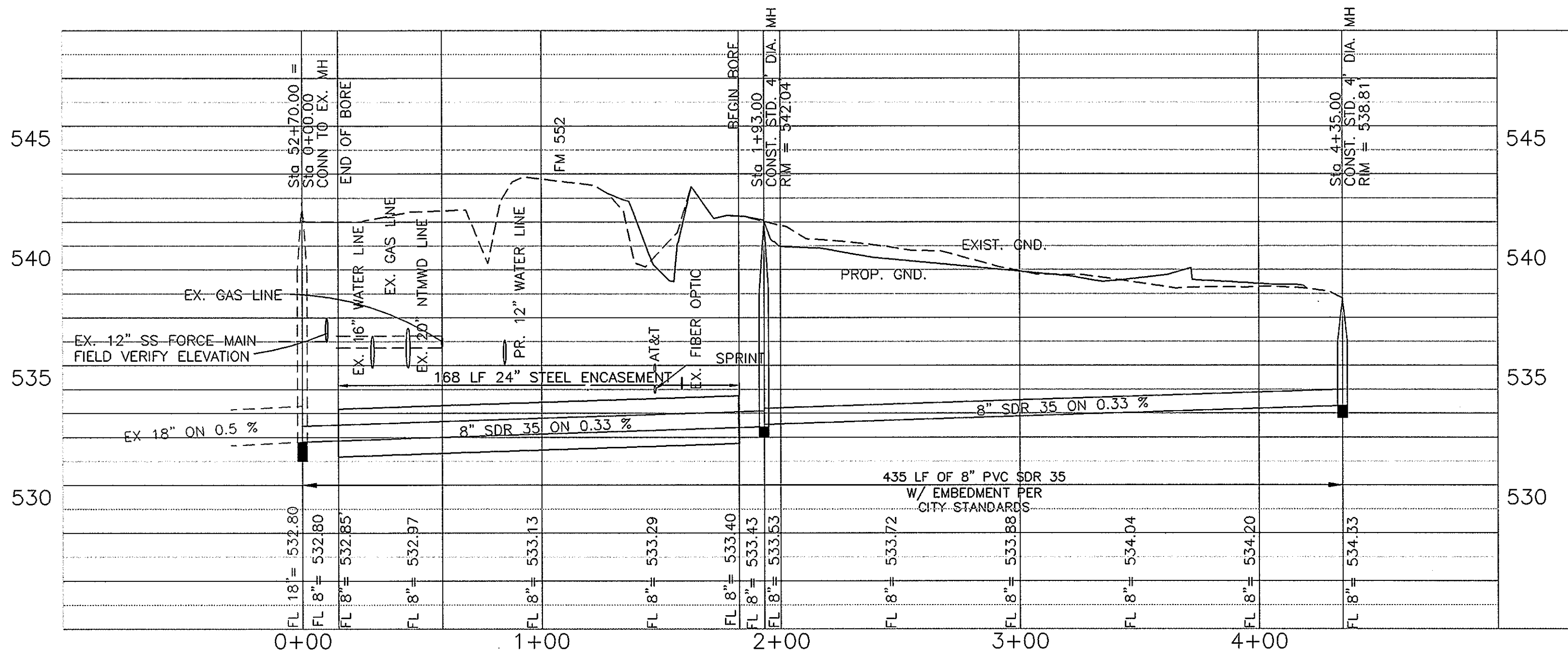

SCALE
H: 1" = 40'
V: 1" = 4'

CAUTION
UNDERGROUND FIBER OPTIC CABLES
AND OVERHEAD ELECTRICAL



THESE PLANS ARE INSTRUMENTS OF PROFESSIONAL SERVICE AND ARE PROTECTED BY COMMON LAW, STATUTORY AND OTHER RESERVED RIGHTS INCLUDING COPYRIGHT. THEY MAY NOT BE REPRODUCED OR USED FOR ANY PURPOSE WITHOUT THE WRITTEN CONSENT OF THE DIMENSION GROUP.	No.	DATE	REVISION / DESCRIPTION	BY	No.	DATE	REVISION / DESCRIPTION	BY			
 CIVIL ENGINEERING • LAND DEVELOPMENT • PLANNING • ARCHITECTURE • CONSTRUCTION MANAGEMENT 10755 SANDHILL ROAD, DALLAS, TEXAS 75238 TEL: 214-343-9400 FAX: 214-341-9060					PROJECT INFO. 7-ELEVEN N.E.C. OF N. GOLIAD STREET & FM 552 ROCKWALL, TEXAS			DRAWING INFO. AS-BUILT OFFSITE WATER LINE & SANITARY SEWER PLAN & PROFILE		PROJECT No. 06127 DATE: 05/18/07 DRAWN BY: CS CHECKED BY: RA	SHEET NUMBER C6.1

7-ELEVEN-N.E.C. OF N. GOLIAD STREET (SH 205) & FM 552, ROCKWALL, TEXAS