

# OFFICE BUILDING SITE DEVELOPMENT

1.082 ACRES OF LAND BEING LOT 6, BLOCK A OF TEMUNOVIC ADDITION, AN ADDITION TO THE CITY OF ROCKWALL, ROCKWALL COUNTY, TEXAS

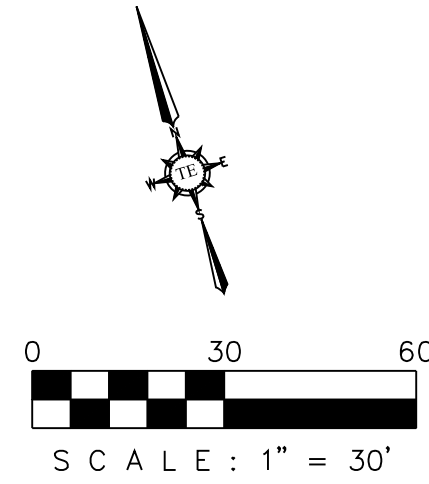

## SITE EROSION CONTROL SUMMARY

**PROJECT NAME & LOCATION:** MEDICAL OFFICE  
1306 SUMMER LEE DRIVE  
ROCKWALL, TEXAS

**OWNER NAME & ADDRESS:** 1306 SUMMER LEE LLC  
1020 W RALPH PARKWAY, # 101  
ROCKWALL, TEXAS 75032

**PROJECT DESCRIPTION:** SITE GRADING OF 1.082 +/- ACRES OUT OF CONSTRUCTION OF PARKING LOT, UNDERGROUND AND ABOVE GROUND UTILITIES, & PROPOSED 6,454 SF +/- BUILDING.

**SEQUENCE OF MAJOR ACTIVITIES:** THE CONTRACTOR WILL SCHEDULE THE PROJECT IN A SERIES OF PHASES. IN GENERAL, THE SEQUENCE OF THESE PHASES WILL CONSIST OF 1. INSTALL EROSION CONTROL BMP 2. EARTHWORK 3. UTILITIES 4. SITE GRADING 5. TEMPORARY/PERMANENT DRIVEWAY, PARKING LOT 6. BUILDING FOUNDATION PAD 7. VERTICAL BUILDING CONSTRUCTION 8. FINALIZE UTILITIES 9. REMOVAL OF EXISTING EROSION CONTROL BMP & INSTALLATION OF PERMANENT EROSION CONTROL BMP.

**SOIL DISTURBING ACTIVITIES:** SOIL DISTURBING ACTIVITIES WILL INCLUDE CLEARING & GRUBBING, GRADING, TRENCHING IN PREPARATION FOR INSTALLING UTILITIES, BUILDING PAD, PARKING LOT, EROSION & SEDIMENTATION CONTROLS AND TOPSOIL WORK FOR FINAL PLANTING AND SEEDING.

**PRE-DEVELOPMENT RUNOFF COEFFICIENT:** 0.30

**POST-DEVELOPMENT RUNOFF COEFFICIENT:** 0.90

**TOTAL PROJECT AREA:** 1.10 ACRES

**TOTAL AREA TO BE DISTURBED:** 2.4 ACRES

**ESTIMATED PROJECT START DATE:** 01/15/2019

**ESTIMATED PROJECT END DATE:** 12/15/2019

## LEGEND

- SILT FENCE
- CONSTRUCTION ENTRANCE (50'X24'X1')
- CONCRETE WASHOUT AREA (30'X20'X1')
- INLET PROTECTION.

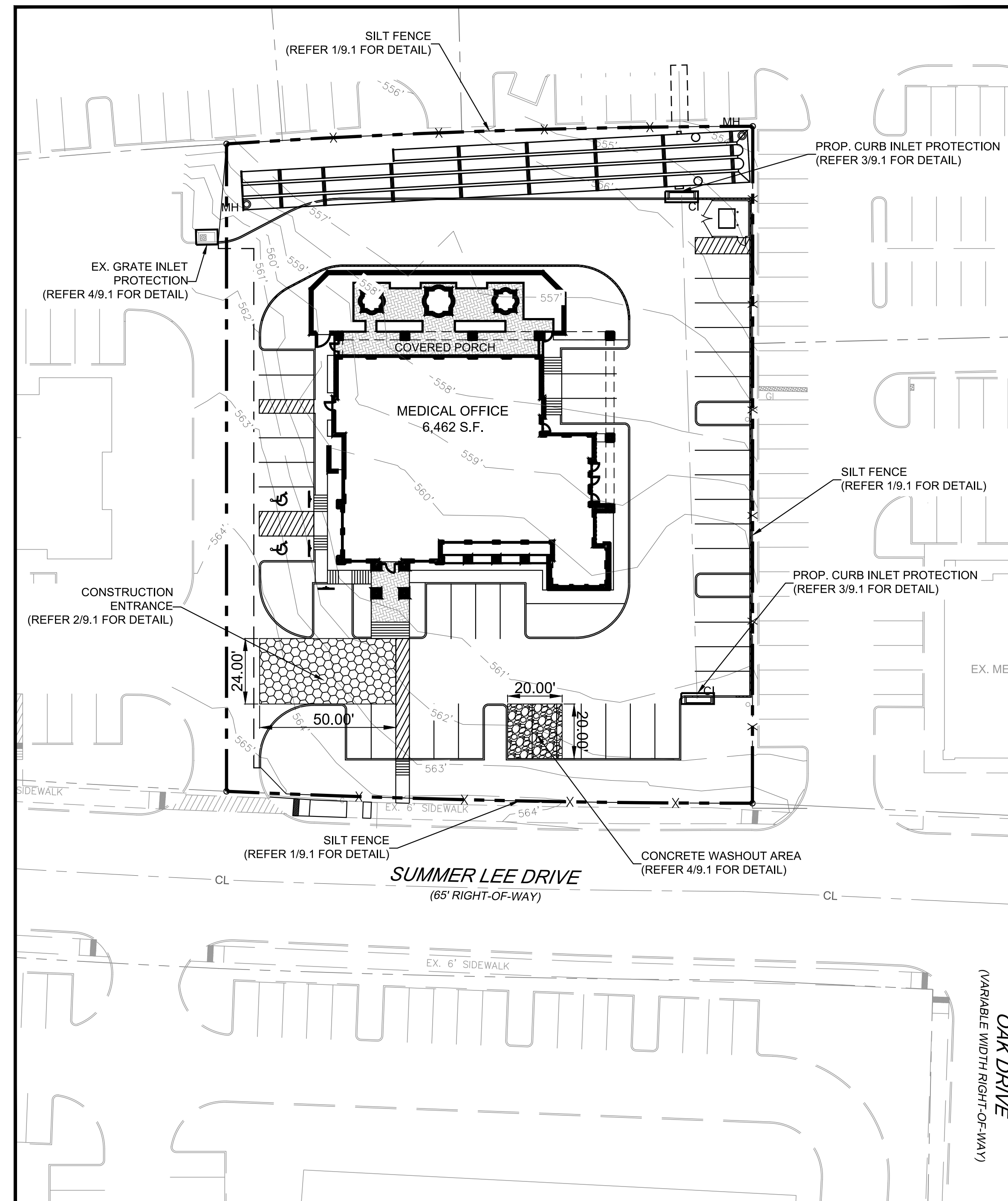

## EROSION CONTROL NOTES:

- EVERY SOIL DISTURBING ACTIVITY SHALL HAVE AN ACCOMPANYING EROSION CONTROL PLAN (ECP), AND EITHER CONSTRUCTION SITE NOTICE (CSN) FOR THOSE ACTIVITIES DISTURBING MORE THAN 1 BUT LESS THAN 5 ACRES, OR NOTICE OF INTENT (NOI) FOR THOSE ACTIVITIES DISTURBING 5 OR MORE ACRES INCLUDING THOSE ACTIVITIES LESS THAN 5 ACRES, BUT A PART OF A COMMON PLAN OF DEVELOPMENT TOTALING 5 OR MORE ACRES. A COPY OF THE APPROPRIATE CSN OR NOI SHALL BE PROVIDED TO THE CITY OF ROCKWALL PRIOR TO ISSUANCE OF A GRADING PERMIT. THE ECP SHALL BE PROVIDED TO CITY OF ROCKWALL'S EROSION CONTROL OFFICER (ECO) PRIOR TO GRADING.
- THE CSN OR NOI SHALL BE POSTED IN A LOCATION VIEWABLE TO THE PUBLIC UNTIL CONSTRUCTION IS COMPLETE AND NOTICE OF TERMINATION (NOT) SUBMITTED. THE STORM WATER POLLUTION PREVENTION PLAN (SWP3) SHALL BE READILY AVAILABLE FOR REVIEW BY FEDERAL, STATE, OR LOCAL OFFICIALS.
- NO SOIL DISTURBING ACTIVITIES WILL OCCUR PRIOR TO THE SWP3, ECP, AND ASSOCIATED BEST MANAGEMENT PRACTICES (BMP) BEING FULLY IMPLEMENTED, AND THEN INSPECTED BY CITY OF ROCKWALL'S ECO.
- THE CONTRACTOR SHALL COMPLY WITH THE CITY OF ROCKWALL'S STORM WATER ORDINANCE, THE TPDES GENERAL CONSTRUCTION PERMIT TXR150000 AND ANY OTHER STATE AND/OR LOCAL REGULATIONS.
- THE SITE SHALL BE REVIEWED BY THE OPERATOR OR HIS REPRESENTATIVE WEEKLY, AND AFTER ANY MAJOR STORM. ADJUSTMENTS/REPAIRS TO THE EROSION CONTROL MEASURES WILL BE MADE AS NEEDED. THE CONTRACTOR SHALL NOTIFY CITY OF ROCKWALL ECO OF ADJUSTMENTS/REPAIRS SUCH THAT THE ADJUSTMENTS/REPAIRS MAY BE INSPECTED AND APPROVED BY THE ECO.
- CONTRACTOR SHALL VEGETATE ALL DISTURBED AREAS IMMEDIATELY UPON COMPLETION OF GRADING ACTIVITIES. FINAL ACCEPTANCE OF A SITE SHALL BE CONTINGENT UPON VEGETATION BEING ESTABLISHED IN ALL DISTURBED AREAS, AND PROPER NOT SUBMITTED TO THE STATE. A COPY OF THE NOT SHALL BE PROVIDED TO THE CITY OF ROCKWALL.
- ALL NON-IMPERVIOUS AREAS AFTER CONSTRUCTION SHALL BE COVERED WITH SOD OR LANDSCAPED IN ACCORDANCE WITH THE LANDSCAPE DRAWINGS. ALL OTHER REMAINING AREAS SHALL BE HYDROMULCHED OR COVERED WITH CURLEX BLANKET (WHERE SHOWN OR PROVIDE MAP SHOWING) AND MAINTAINED UNTIL ESTABLISHED.
- TEMPORARY STONE STABILIZED CONSTRUCTION ENTRANCE SHALL HAVE THE FOLLOWING MINIMUM DIMENSIONS: 24' WIDE X 50' LONG X 12" DEEP. (4"-8" OPEN GRADED ROCK). PLACE FILTER FABRIC UNDER STONE. NO CRUSHED OR RECYCLED CONCRETE ALLOWED.
- THE STABILIZED CONSTRUCTION ENTRANCE IS TO BE USED AS A VEHICLE WASH DOWN AREA FOR DEBRIS AND SOIL REMOVAL PRIOR TO EXITING THE SITE. THIS STABILIZED ENTRANCE SHALL BE TOP DRESSED WITH ADDITIONAL STONE AS NECESSARY. LOCATION OF STABILIZED ENTRANCE MAY BE MODIFIED IF APPROVED BY THE CITY OF ROCKWALL AND THE DESIGN ENGINEER.
- THE CONTRACTOR SHALL BE RESPONSIBLE, AS THE ENTITY EXERCISING OPERATIONAL CONTROL, FOR ALL PERMITTING AS REQUIRED BY THE EPA/TCEQ. THIS INCLUDES, BUT IS NOT LIMITED TO, PREPARATION OF NOI AND NOT PAYMENT OF ALL ASSOCIATED FEES.
- 75% TO 80% OF ALL DISTURBED AREA TO HAVE 1" STAND OF GRASS (NOT WEEDS) PRIOR TO CITY'S ACCEPTANCE.
- ALL CITY RIGHT-OF-WAY TO BE SODDED PRIOR TO CITY'S ACCEPTANCE.

## EROSION & SEDIMENT CONTROLS

### 1. SOIL STABILIZATION PRACTICES:

(Select T = Temporary or P = Permanent, as applicable)

- |  |  |
|--|--|
| <input type="checkbox"/> T TEMPORARY SEEDING     | <input type="checkbox"/> PRESERVATION OF NATURAL RESOURCES |
| <input type="checkbox"/> MULCHING (Hay or Straw) | <input type="checkbox"/> FLEXIBLE CHANNEL LINER            |
| <input type="checkbox"/> BUFFER ZONES            | <input type="checkbox"/> RIGID CHANNEL LINER               |
| <input type="checkbox"/> P PLANTING              | <input type="checkbox"/> SOIL RETENTION BLANKET            |
| <input type="checkbox"/> SEEDING                 | <input type="checkbox"/> COMPOST MANUFACTURED TOPSOIL      |
| <input type="checkbox"/> P SODDING               | <input type="checkbox"/> EROSION CONTROL BLANKET           |

### 2. STRUCTURAL PRACTICES:

(Select T = Temporary or P = Permanent, as applicable)

- |   |  |
|---|--|
| <input type="checkbox"/> T SILT FENCES      | <input type="checkbox"/> DIVERSION, INTERCEPTOR, OR PERIMETER DIKES  |
| <input type="checkbox"/> HAY BALES          | <input type="checkbox"/> DIVERSION, INTERCEPTOR, OR PERIMETER SWALES |
| <input type="checkbox"/> ROCK FILTER DAMS   | <input type="checkbox"/> DIVERSION DIKE AND SWALE COMBINATIONS       |
| <input type="checkbox"/> PIPE SLOPE DRAINS  | <input type="checkbox"/> ROCK BEDDING AT CONSTRUCTION EXIT           |
| <input type="checkbox"/> PAVED FLUMES       | <input type="checkbox"/> TIMBER MATTING AT CONSTRUCTION EXIT         |
| <input type="checkbox"/> CHANNEL LINERS     | <input type="checkbox"/> STONE OUTLET STRUCTURES                     |
| <input type="checkbox"/> SEDIMENT TRAPS     | <input type="checkbox"/> VELOCITY CONTROL DEVICES                    |
| <input type="checkbox"/> SEDIMENT BASINS    | <input type="checkbox"/> P CURBS AND GUTTERS                         |
| <input type="checkbox"/> P STORM SEWERS     | <input type="checkbox"/> STORM INLET SEDIMENT TRAP                   |
| <input type="checkbox"/> T INLET PROTECTION | <input type="checkbox"/> T CONSTRUCTION ENTRANCE                     |

### AS-BUILT DRAWINGS:

TO THE BEST OF OUR KNOWLEDGE TRIANGLE ENGINEERING LLC., HEREBY STATES THAT THIS PLAN IS AS-BUILT. THE INFORMATION PROVIDED IS BASED ON SURVEYING AT THE SITE AND INFORMATION PROVIDED BY THE CONTRACTOR.

KARTAVYA S. PATEL, P.E. NO. 97534

NO.	DATE	DESCRIPTION	BY
1	12/13/2019	AS-BUILT RECORD DRAWING	KP

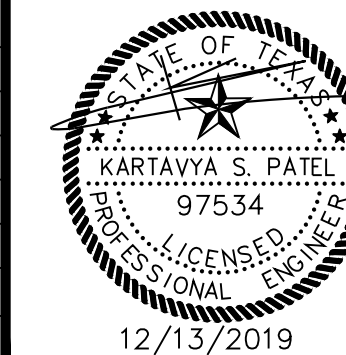

## RECORD DRAWING

CASE # SP2017-023  
**EROSION CONTROL PLAN**  
 OFFICE BUILDING  
 1306 SUMMER LEE DRIVE  
 CITY OF ROCKWALL  
 ROCKWALL COUNTY, TEXAS



T: 214.609.9271 | F: 469.359.6709 | E: kpatel@triangle-engr.com  
 W: triangle-engr.com | O: 1784 W. McDermott Drive, Suite 110, Allen, TX 75013

Planning | Civil Engineering | Construction Management

DESIGN/DRAWN	DATE	SCALE	PROJECT NO.	SHEET NO.
KP DS	07/04/17	SEE SCALE BAR	018-17	9

TX PE FIRM #11525