

OFFICE BUILDING SITE DEVELOPMENT

1.082 ACRES OF LAND BEING LOT 6, BLOCK A OF TEMUNOVIC ADDITION, AN ADDITION TO THE CITY OF ROCKWALL, ROCKWALL COUNTY, TEXAS

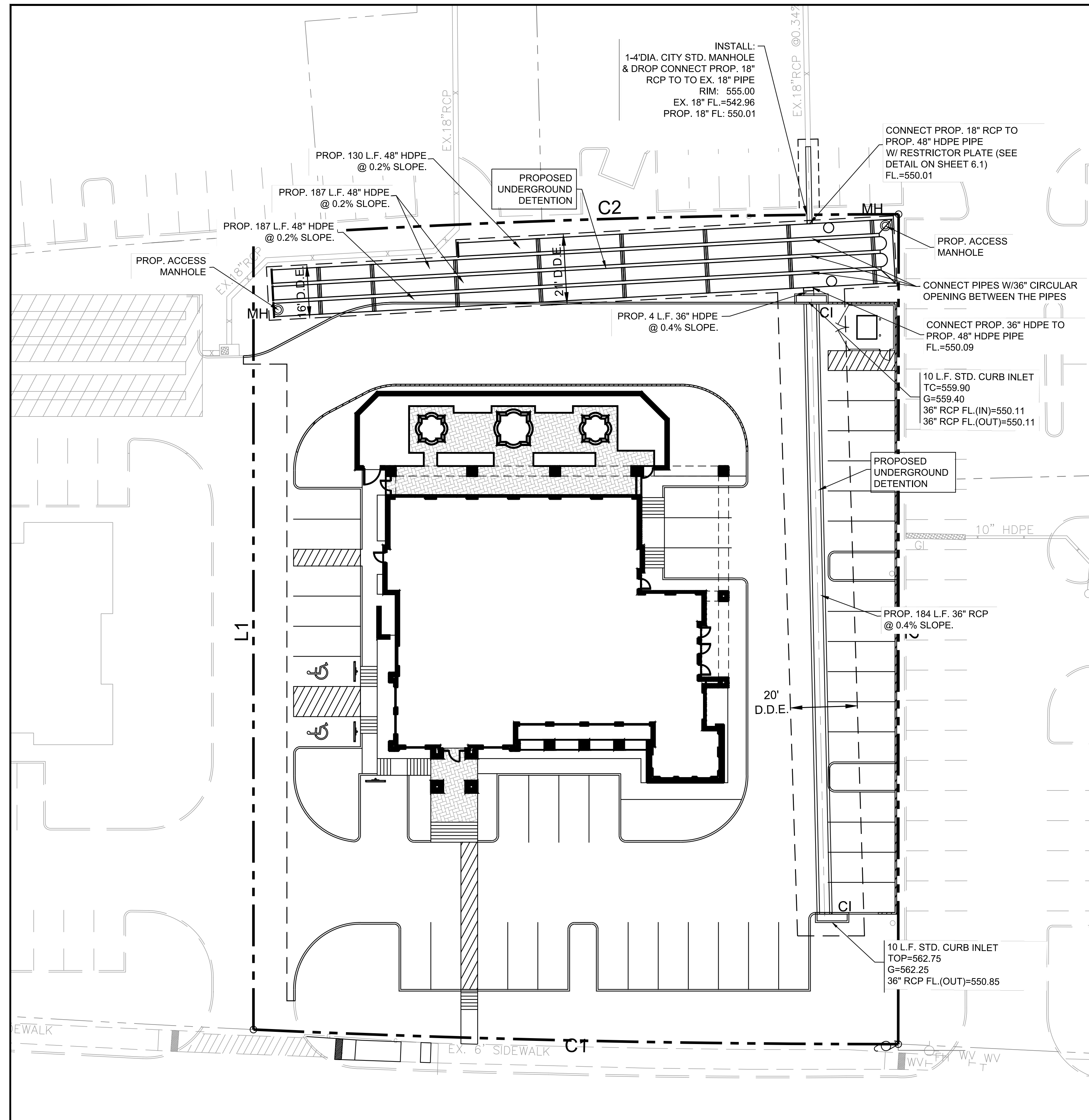
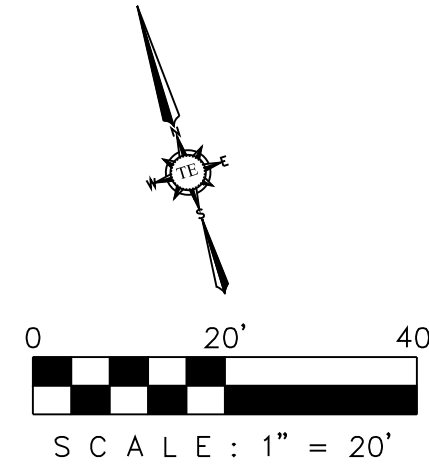

AS-BUILT DRAWINGS:
 TO THE BEST OF OUR KNOWLEDGE TRIANGLE ENGINEERING LLC.,
 HEREBY STATES THAT THIS PLAN IS AS-BUILT. THE INFORMATION
 PROVIDED IS BASED ON SURVEYING AT THE SITE AND INFORMATION
 PROVIDED BY THE CONTRACTOR.

Kartavya S. Patel
 KARTAVYA S. PATEL, P.E. NO. 97534

RECORD DRAWING

CASE # SP2017-023
PROPOSED DETENTION
 OFFICE BUILDING
 1306 SUMMER LEE DRIVE
 CITY OF ROCKWALL
 ROCKWALL COUNTY, TEXAS



T: 214.609.9271 | F: 469.359.6709 | E: kpatel@triangle-engr.com
 W: triangle-engr.com | O: 1784 W. McDermott Drive, Suite 110, Allen, TX 75013

Planning | Civil Engineering | Construction Management

DESIGN DRAWN	DATE	SCALE	PROJECT NO.	SHEET NO.
KP	DS	07/04/17	SEE SCALE BAR	018-17

TX PE FIRM #11525

6.3

NO.	DATE	DESCRIPTION	BY
1	12/13/2019	AS-BUILT RECORD DRAWING	KP

