

DATE: _____
 BY: _____
 SURVEYED: _____
 ALIGNED: _____
 CHECKED: _____
 RT. OF WAY CHECKED: _____
 NO. _____

DATE: _____
 BY: _____
 SURVEYED: _____
 GRADES CHECKED: _____
 B. M.'S NOTED: _____
 STRUCTURE NOTATIONS: _____
 NO. _____

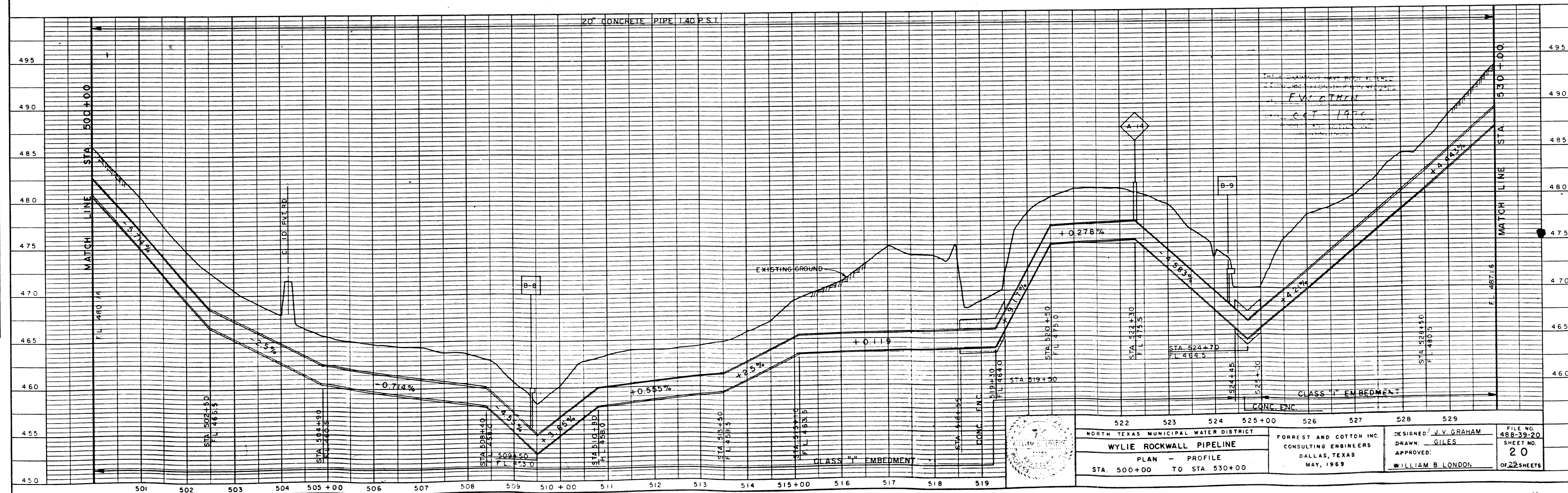
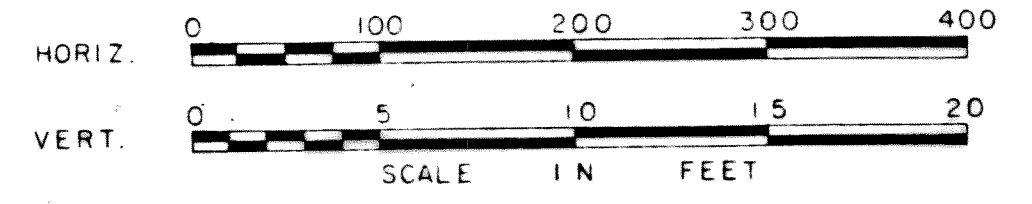
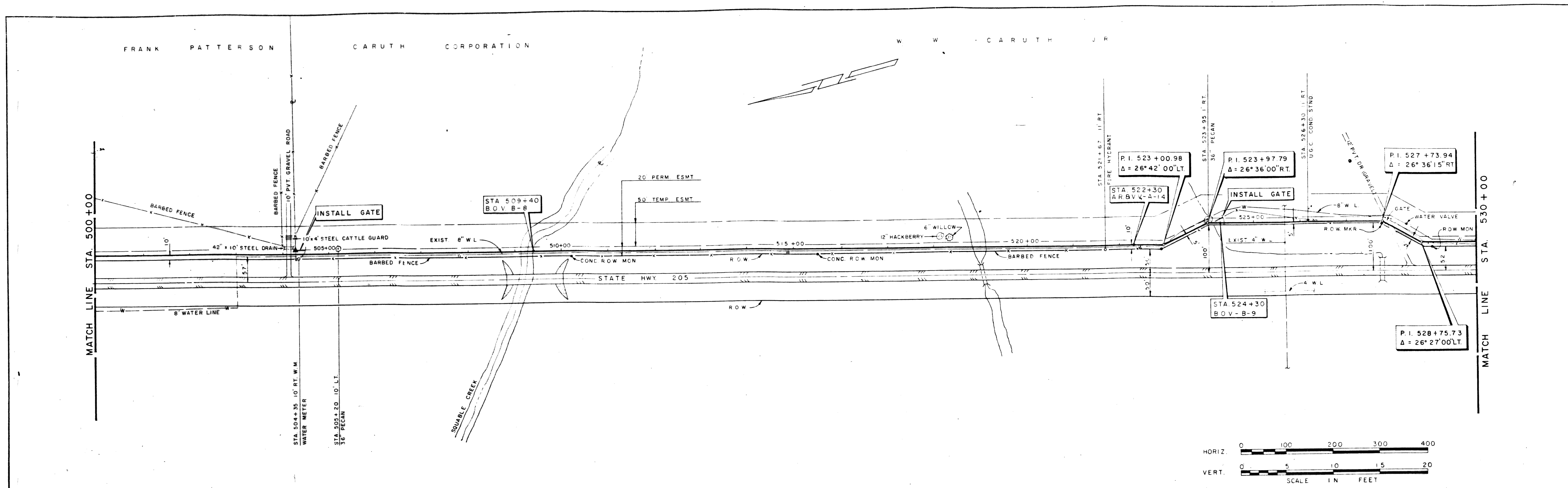

	NORTH TEXAS MUNICIPAL WATER DISTRICT WYLIE ROCKWALL PIPELINE PLAN - PROFILE STA. 500+00 TO STA. 530+00	FORREST AND COTTON INC. CONSULTING ENGINEERS DALLAS, TEXAS MAY, 1969	DESIGNED: J. V. GRAHAM DRAWN: GILES APPROVED: WILLIAM B. LONDON	FILE NO. 488-39-20 SHEET NO. 20 OF 22 SHEETS
--	--	---	---	--