

PROFILE
 SURVEYED
 GRADES CHECKED
 R.M.'S NOTED
 IN SLOPE, WHAT'S CORRECT

PLAN
 LOCATED
 PLOTTED
 RECORDED
 21 OF MAY CHE' 51

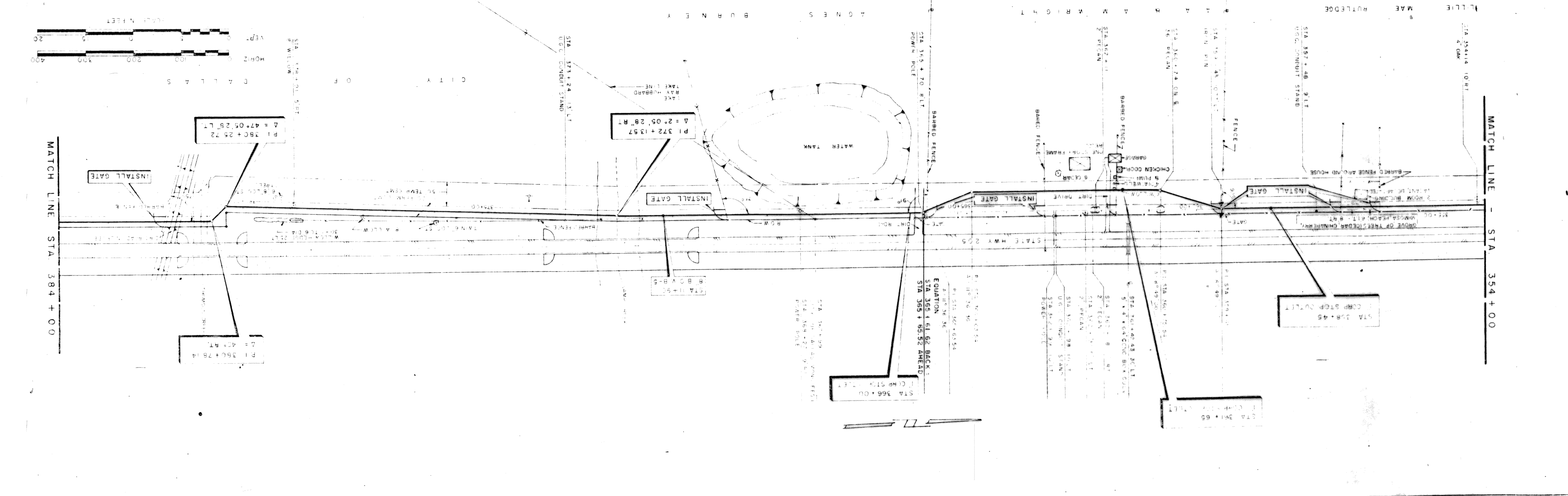
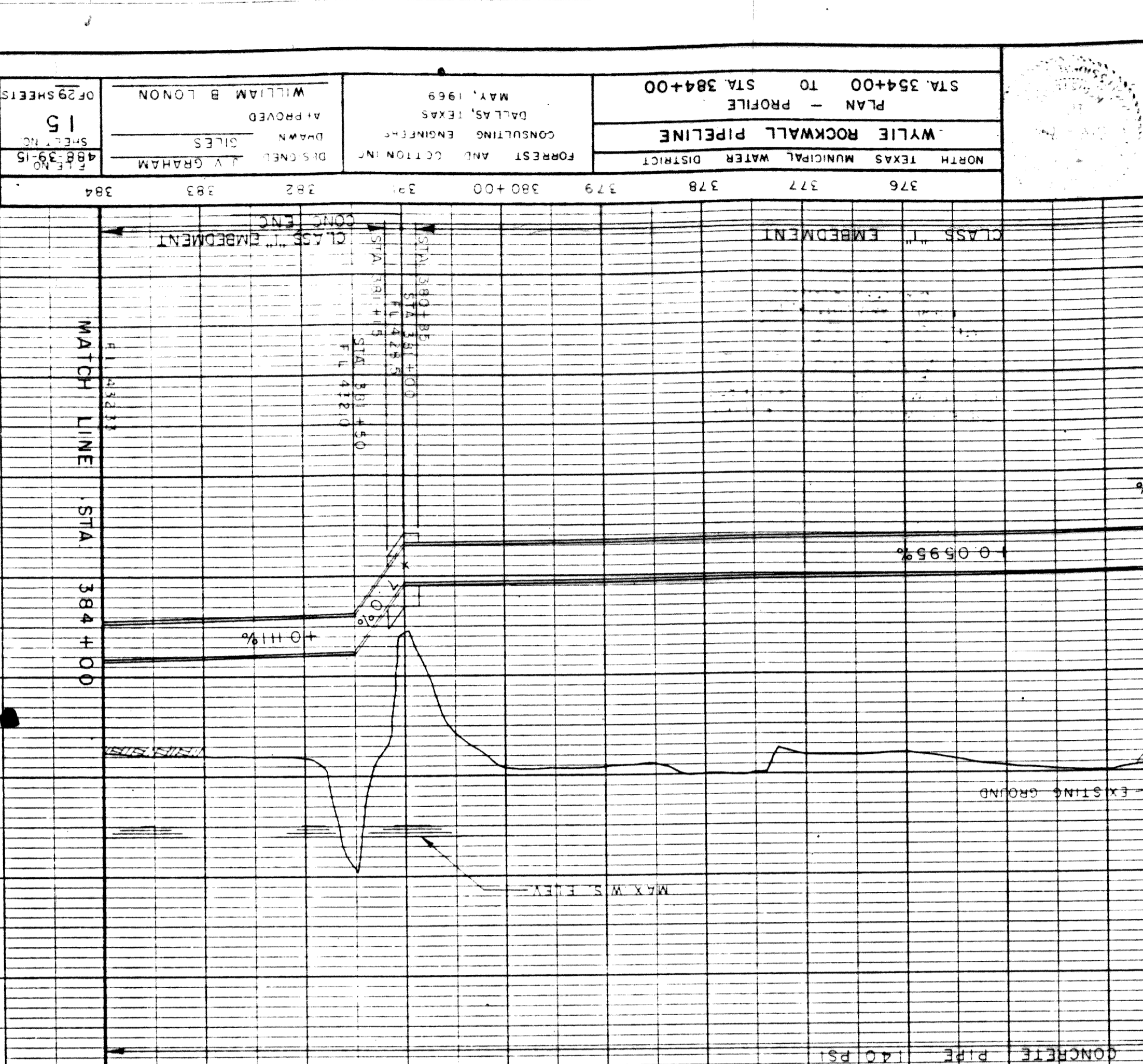
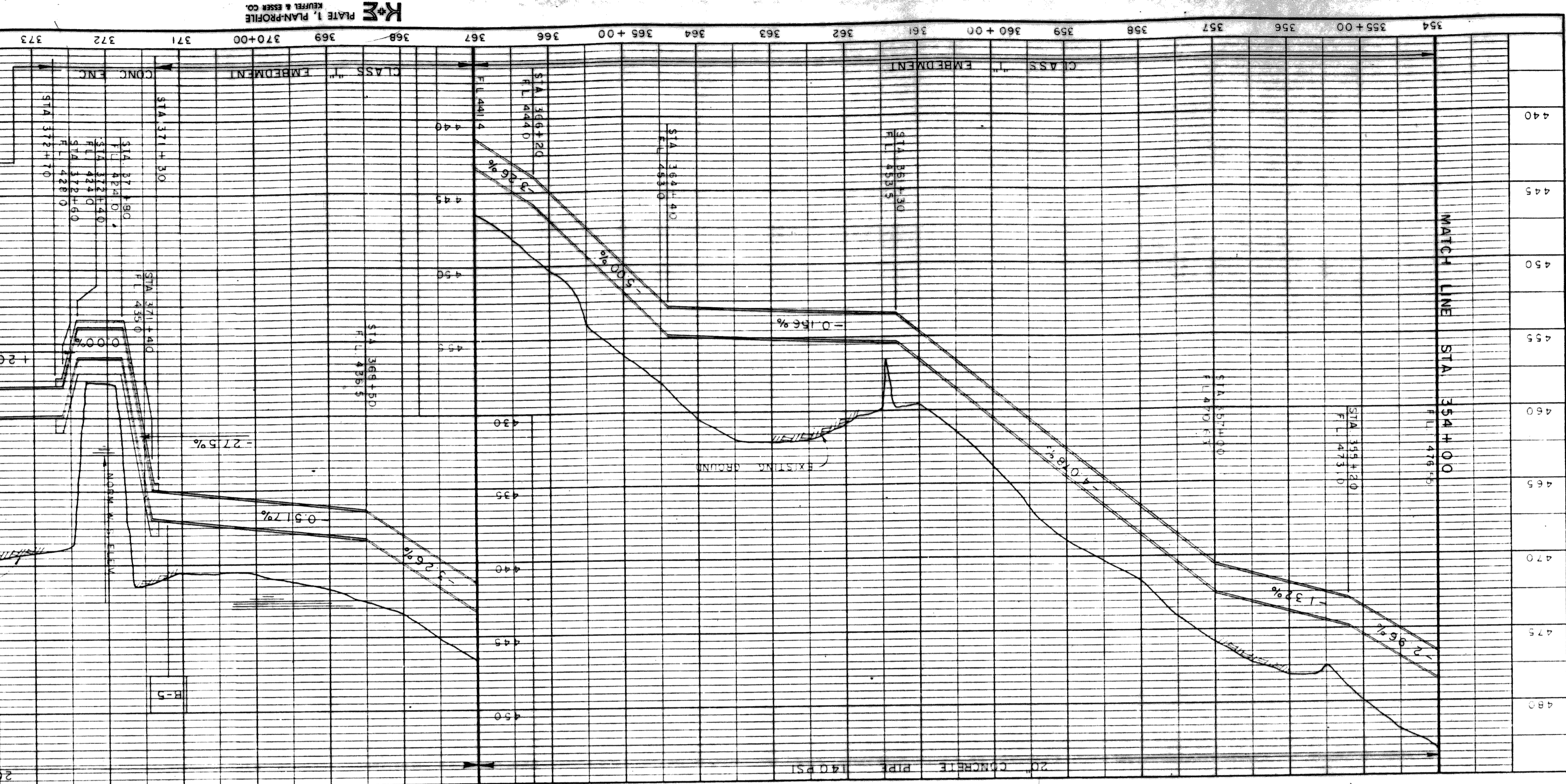

WYLIE ROCKWALL PIPELINE
 NORTH TEXAS MUNICIPAL WATER DISTRICT
 CONSULTING ENGINEER
 DATE: MAY, 1969
 DRAWN: GILES
 DESIGNED: V. GRAHAM
 APPROVED: WILLIAM B. LONON

K&E
 PLATE 1, PLAN PROFILE
 KEFFER & ESSER CO.
 487012 IMPERIAL, HOUSTON, TEXAS

PLAN - PROFILE
 STA 354+00 TO STA 384+00
 SHEET NO. 15
 OF 29 SHEETS