

HORIZONTAL CONTROL DATA			
COORDINATES			
MH STATION	NORTH	EAST	DELTA
707+30.56	7006176.07	2595266.27	23° 46' 19" RT
712+81.84	7006558.99	2595662.32	67° 18' 22" LT
713+62.46	7006649.61	2595627.40	10° 36' 32" RT

SURVEY CONTROL			
COORDINATES			
POINT NO	NORTH	EAST	ELEVATION
524	7006159.52	2595532.00	475.82
265 (IR)	7006668.07	2595631.21	482.88
286 (IR)	7006642.12	2595532.33	484.60

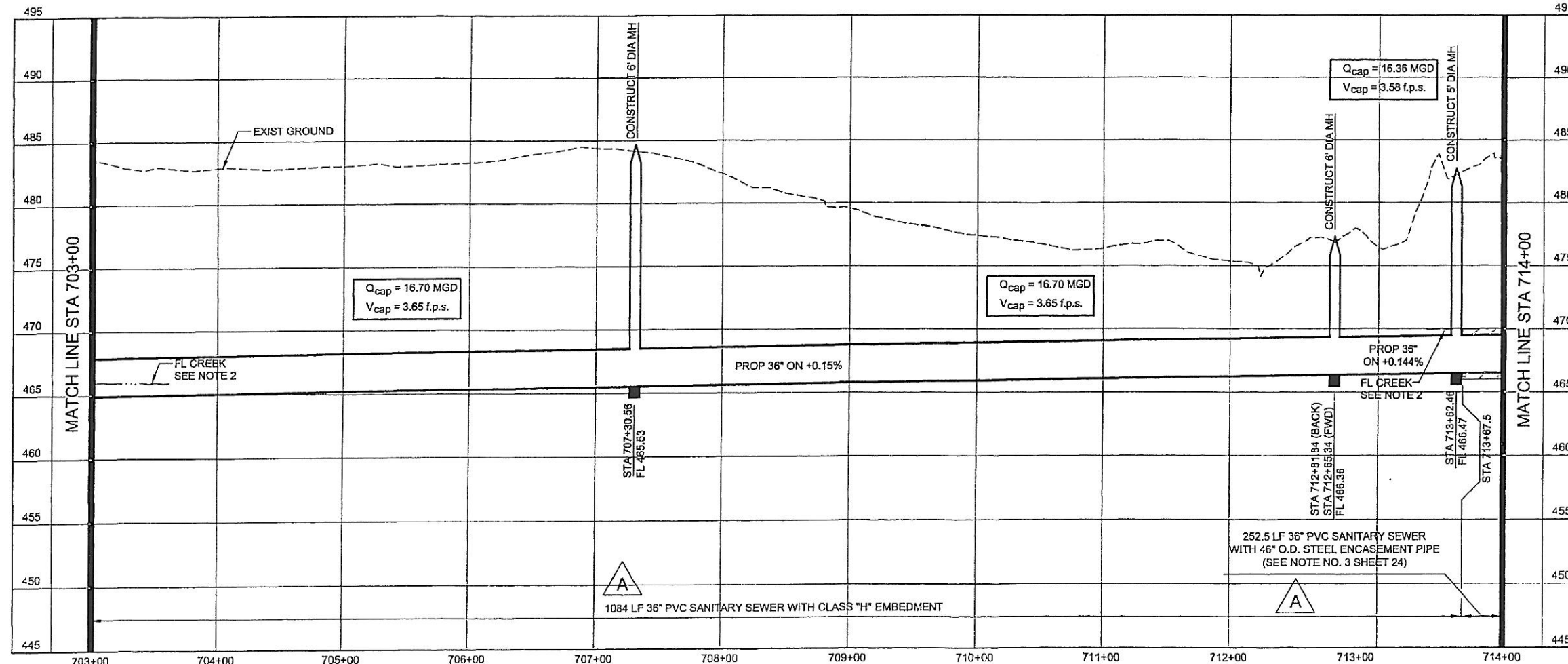

- NOTES:**
- SEE SHEET NO. 2 FOR GENERAL PROJECT NOTES.
 - FLOW LINE AT BUFFALO CREEK SHOWN FOR REFERENCE ONLY.
 - CONTRACTOR SHALL INSTALL EROSION CONTROL SILT FENCING PRIOR TO CONSTRUCTION AND SHALL BE RESPONSIBLE FOR PREVENTING CONSTRUCTION ACTIVITIES FROM DISTURBING POND.
 - CART PATHS DAMAGED OR REMOVED BY THE CONSTRUCTION SHALL BE RESTORED TO EQUAL OR BETTER THAN THEIR PRE-CONSTRUCTION CONDITION.
 - CONTRACTOR SHALL INSTALL EROSION CONTROL SILT FENCING ON BOTH SIDES OF THE EASEMENT ACROSS THE GOLF COURSE PRIOR TO STARTING CONSTRUCTION ACTIVITIES.
 - CONTRACTOR MAY ONLY CONSTRUCT THE PROPOSED SANITARY SEWER FACILITIES ON B.C. GOLF LIMITED PROPERTY DURING THE MONTHS OF JANUARY AND FEBRUARY. ALL CONSTRUCTION AND RESTORATION ACTIVITY FOR THE WHOLE LENGTH OF THE PROPOSED SEWER THROUGH THE GOLF COURSE PROPERTY MUST BE STARTED AND TOTALLY COMPLETED IN THAT SINGLE TWO MONTH TIME FRAME.
 - THE CONTRACTOR SHALL REPLACE ALL GRASS DISTURBED BY THE CONSTRUCTION ON B.C. GOLF LIMITED PROPERTY WITH GRASS SOD APPROVED BY B.C. GOLF LIMITED.

NORTH TEXAS MUNICIPAL WATER DISTRICT
ROCKWALL-HEATH TRANSFER SEWER RHC# 01-1, SECTION 2
SANITARY SEWER PLAN AND PROFILE 703+00 TO 714+00

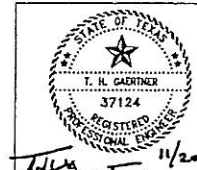

NO	DATE	REVISIONS	MADE CKD	JOB NO.	CM-0148	DWG. NO.	23 OF 36
A	11/10/03	Corrected pipe length.	THG	THG			
A	11/10/03	Added manhole at 713+62.46 to Horizontal Control Data.	THG	THG			
A	11/10/03	Corrected Horizontal Control Data.	THG	THG			
A	11/10/03	Added encasement pipe size and wall thickness.	THG	THG			