

NOTES:
 1. MARKER SHALL BE LOCATED ON BOTH SIDES OF ALL ROADS AND RAILROADS AT THE R.O.W. LINES OVER THE CENTER OF THE PIPELINE.
 2. EACH MARKER SHALL HAVE A STICKER WITH THE FOLLOWING INFORMATION "CAUTION WASTEWATER PIPELINE - CONTACT NTMWD (972) 442-5405, STA. XXX+XX" (SEE TEXT DETAIL THIS SHEET).
 3. CONTRACTOR SHALL PROVIDE THE OWNER A POST DRIVER (PART #PDR1), A POST PULLER, AND 5 ADDITIONAL PIPELINE MARKERS.

HORIZONTAL CONTROL DATA			
COORDINATES			
MH STATION	NORTH	EAST	DELTA
631+82.84	6999523.18	2596038.85	90° 00' 00" LT
633+79.37	6999661.41	2595899.16	61° 21' 04" RT

SURVEY CONTROL			
COORDINATES			
POINT NO	NORTH	EAST	ELEVATION
552	6999674.53	2596049.85	466.72
554	6999248.97	2595691.96	468.98
1382	6999892.77	2596050.56	462.13

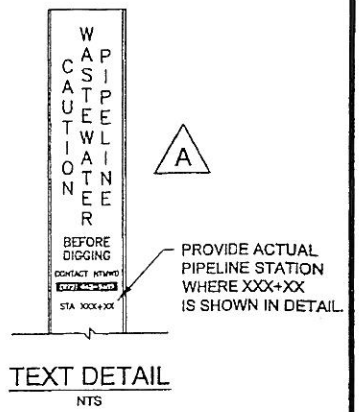

- NOTES:
- SEE SHEET NO. 2 FOR GENERAL PROJECT NOTES.
 - FLOW LINE AT BUFFALO CREEK SHOWN FOR REFERENCE ONLY.
 - CONTRACTOR SHALL INSTALL EROSION CONTROL SILT FENCING PRIOR TO CONSTRUCTION AND SHALL BE RESPONSIBLE FOR PREVENTING CONSTRUCTION ACTIVITIES FROM DISTURBING POND.
 - CONTRACTOR SHALL UTILIZE TRENCH SAFETY AND WELL POINT SYSTEMS AS REQUIRED TO MAINTAIN TRENCH INTEGRITY DURING INSTALLATION OF THE SEWER RUNNING ALONG THE EDGE OF THE POND.
 - MINIMUM WALL THICKNESS FOR THE STEEL ENCASUREMENT PIPE SHALL BE 5/8".

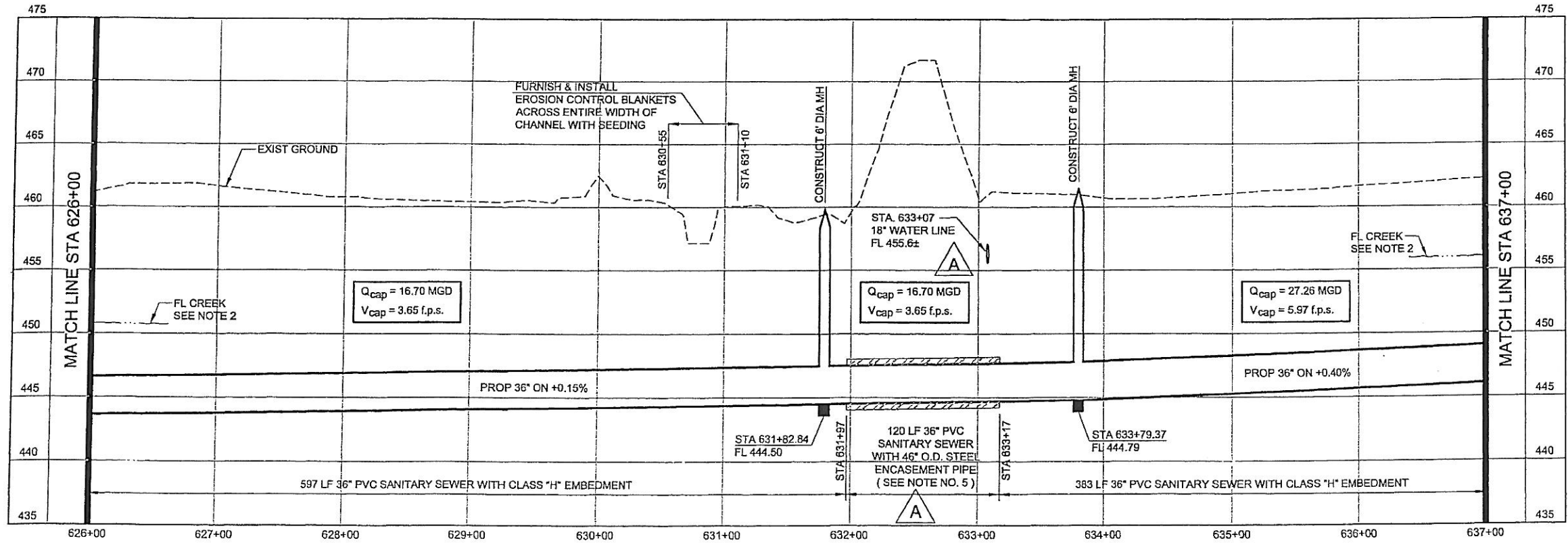

A

NORTH TEXAS MUNICIPAL WATER DISTRICT
ROCKWALL-HEATH TRANSFER SEWER RHC# 01-1, SECTION 2
SANITARY SEWER PLAN AND PROFILE 626+00 TO 637+00

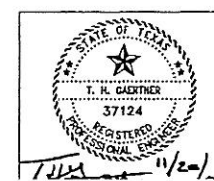

NO.	DATE	REVISIONS	MADE BY	CHECKED BY	JOB NO.
A	11/6/03	Added 18" water line to profile.	THG	THG	
A	11/6/03	Added encasement pipe size and wall thickness.	THG	THG	
A	11/11/03	Added Pipeline Marker details and notes.	THG	THG	

DESIGNED		KBR		HORIZ. SCALE	1"=50'
		KBR		VERT. SCALE	1"=5'
CHECKED		THG		DATE	SEPTEMBER 26, 2003
JOB NO.		CM-0148		DWG. NO.	16 OF 36