

NOTE:  
6" BLOWOFF LINE AT STA. 100+20  
SHALL EXTEND TO CHANNEL SLOPE  
AT APPROXIMATE STA. 100+65 AND  
APPROX. ELEVATION 440.0'

- NOTE:
1. CONTRACTOR TO VERIFY LOCATION AND DEPTH OF ALL UTILITIES.
  2. LIMITS OF TEMPORARY AND PERMANENT EASEMENTS HAVE NOT BEEN TIED TO SURVEYED BASE LINE. CONTRACTOR SHALL DETERMINE EXACT LIMITS OF EASEMENTS IN THE FIELD AS NECESSARY.
  3. FROM STA. 99+77 TO STA. 128+78, THE CONTRACTOR SHALL NOT CUT OR REMOVE ANY PECAN TREES WITHOUT THE CONSENT OF THE PROPERTY OWNER.

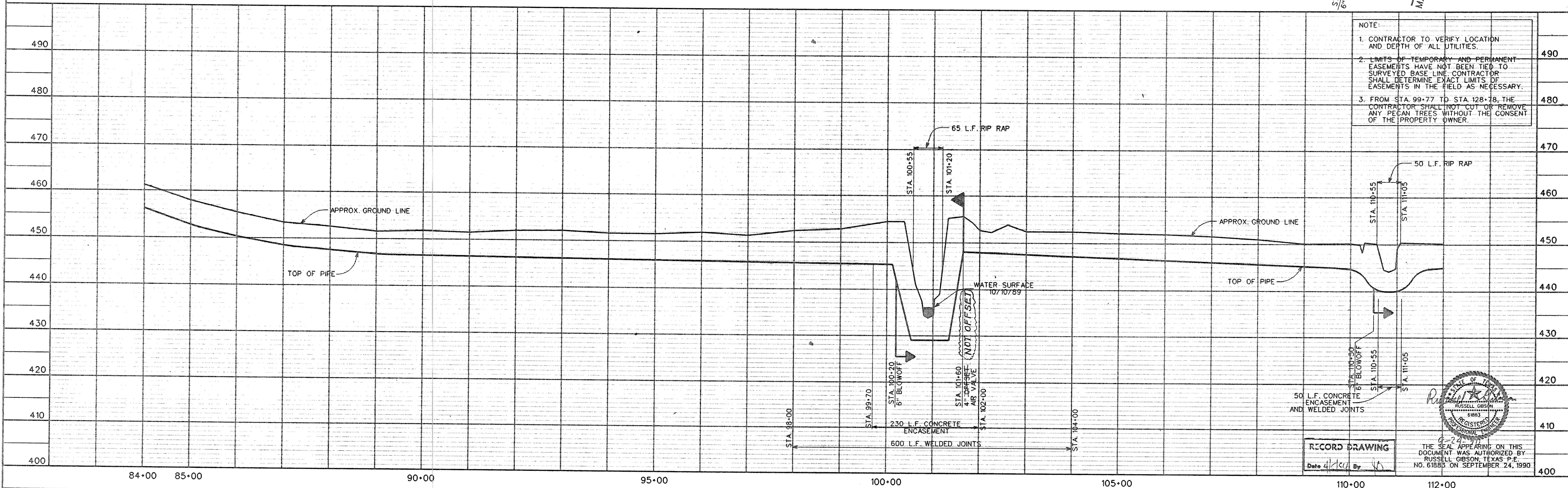

RECORD DRAWING  
Date 4/15/91 By [Signature]

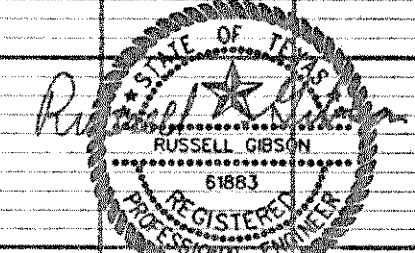

THE SEAL APPEARING ON THIS DOCUMENT WAS AUTHORIZED BY RUSSELL GIBSON, TEXAS P.E. NO. 61885 ON SEPTEMBER 24, 1990.

NS: NORSWORTHY, D:\INTEREST\NTD88047.DWG

DESIGNED	J.W.G.	JOB NO.	NTD88047
DRAWN	D.A.N.	DATE	SEP. 1990
TRACED		H. SCALE	H. 1"=100'
CHECKED	J.D.W.	V. SCALE	V. 1"=10'

**FREESE AND NICHOLS INC.**  
CONSULTING ENGINEERS  
FORT WORTH - ARLINGTON - AUSTIN, TEXAS

**NORTH TEXAS MUNICIPAL WATER DISTRICT**  
WYLIE - ROCKWALL - FARMERSVILLE PIPELINE

**30-INCH PIPELINE**  
PLAN AND PROFILE  
STA. 84+00 TO STA. 112+00

SH. 6  
OF 28  
CF 88-3