

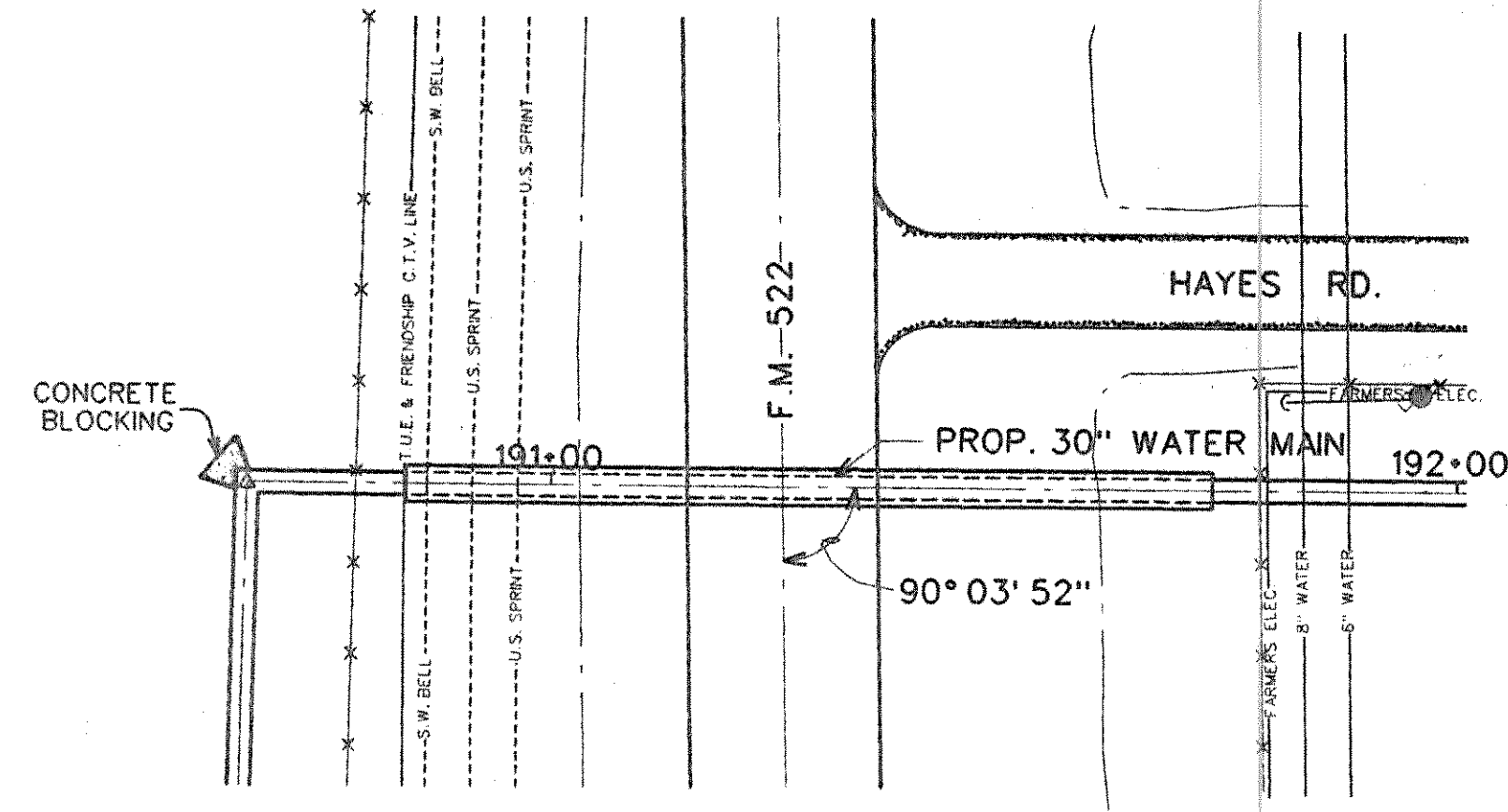

SCALE
HORIZ. 1" = 100'
VERT. 1" = 10'

- 190-79 - CROSS BARBED WIRE FENCE
- 190-85 - OVERHEAD T.U.E. LINE
- 190-85 - OVERHEAD FIBER OPTIC CABLE LINE
- 190-86 - UNDERGROUND S.W. BELL CABLE
- 190-89 - UNDERGROUND U.S. SPRINT CABLE
- 190-94 - UNDERGROUND U.S. SPRINT CABLE
- 191-02 - & DITCH
- 191-15 - EDGE OF PAVEMENT
- 191-36 - EDGE OF PAVEMENT
- 191-60 - & DITCH
- 191-78 - GUY WIRE - 12' LT.
- 191-78 - FARMERS ELEC. LINE - 12' LT.
- 191-78 - CROSS-BARBED WIRE FENCE
- 191-78 - FENCE CORNER - 12' LT.
- 191-83 - 8" WATER
- 191-88 - 6" WATER
- 191-95 - POWER POLE - 12' LT.



PLAN - F.M. 522 CROSSING

SCALE - 1" = 20'

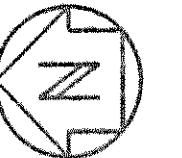

SCALE
HORIZ. 1" = 100'
VERT. 1" = 10'

- 308-16 - BARBED WIRE FENCE - 3' LT.
- 308-17 - TEL. PED. (S.W. BELL) - 4' LT.
- 308-25 - CROSS BARBED WIRE FENCE
- 308-30 - S.W. BELL CABLE
- 308-89 - EDGE OF ASPH.
- 309-04 - N.T.M.W.D. 20" WATER LINE
- 309-15 - N.T.M.W.D. 12" WATER LINE
- 309-28 - S.W. BELL CABLE
- 309-55 - & OF S.H. 66
- 309-65 - EDGE OF ASPH.
- 309-75 - S.W. BELL CABLE
- 309-76 - T.U.E. LINE
- 309-77 - BELL CABLE T.V. LINE
- 309-83 - APPROX. R.O.W.
- 309-83 - BARBED WIRE FENCE
- 309-85 - POWER POLE - 3' LT.
- 309-85 - POWER LINE

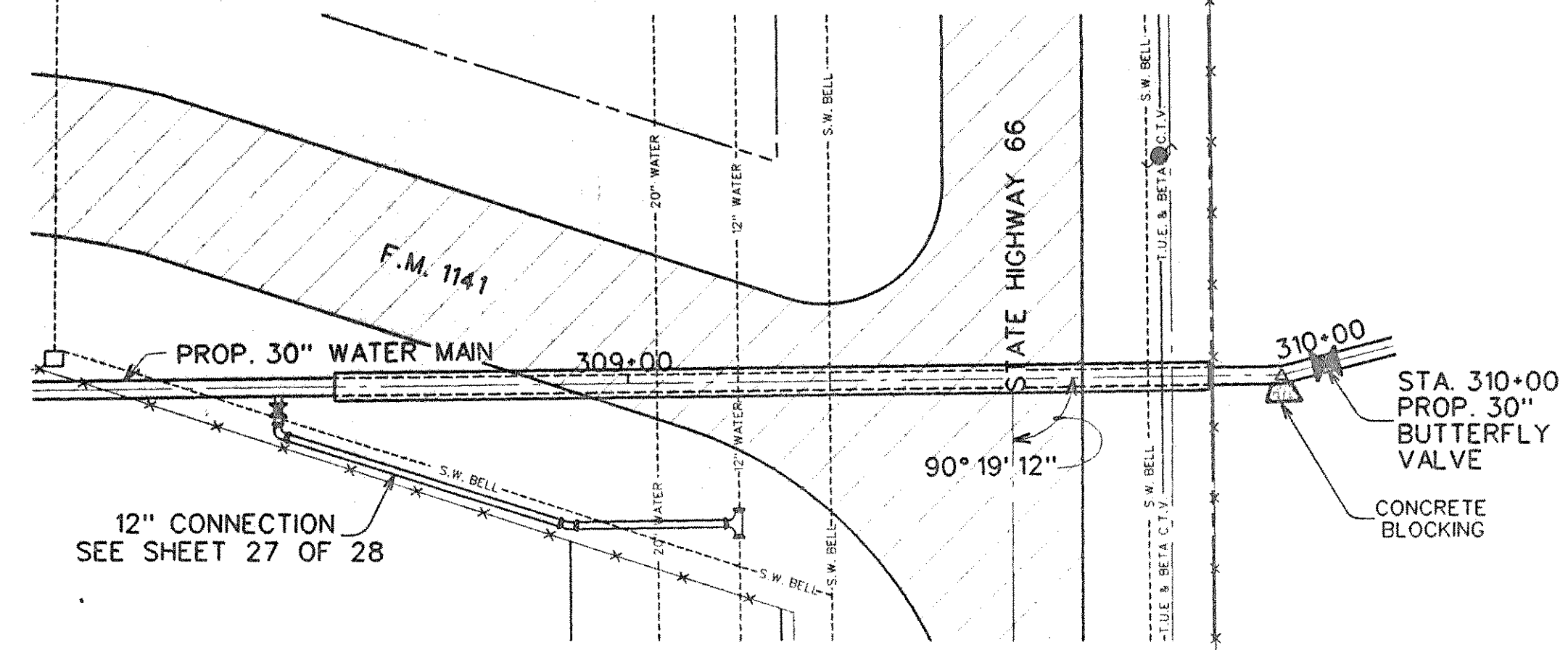

PLAN - STATE HIGHWAY 66 CROSSING

SCALE - 1" = 20'

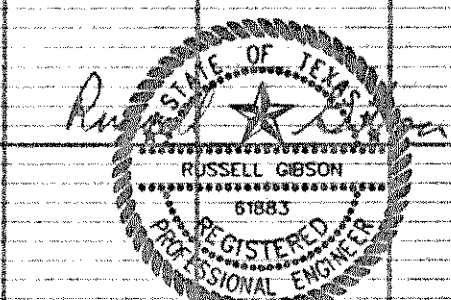
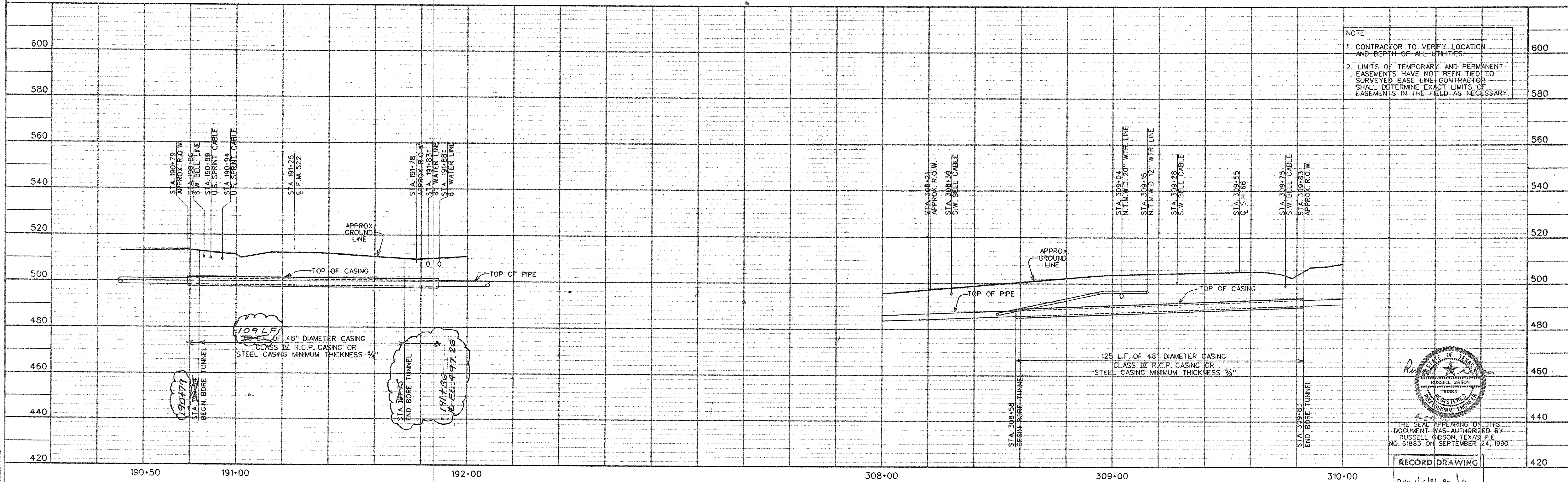

THE SEAL APPEARING ON THIS DOCUMENT WAS AUTHORIZED BY RUSSELL GIBSON, TEXAS P.E. NO. 61883 ON SEPTEMBER 24, 1990

RECORD DRAWING
Date 11/14/94 By [Signature]

DESIGNED R.L.G.
DRAWN D.A.N.
TRACED J.W.G.
CHECKED J.W.G.

JOB NO. NTD88047
DATE JULY 1990
SCALE H. 1"=20'
V. 1"=20'

FREESE AND NICHOLS INC.
CONSULTING ENGINEERS
FORT WORTH - ARLINGTON - AUSTIN, TEXAS

NORTH TEXAS MUNICIPAL WATER DISTRICT
WYLIE - ROCKWALL - FARMERSVILLE PIPELINE

30-INCH PIPELINE
HIGHWAY CROSSING DETAILS

CF 88-3

SH. 18
OF 28