

VICINITY MAP
NOT TO SCALE

0.427 ACRES
INEZ R. SMITH
TO
SHANNON MCCORD
VOL. 3451, PG. 103

0.50 ACRES
C. A. & DORTHY SEABOLT
TO
CRAIG MERRITT
VOL. 2263, PG. 21

0.46 ACRES
CRAIG MERRITT
TO
WILLIAM H. & MELINDA MIGNEAULT
VOL. 2933, PG. 260

TRACT 2
NAN L. SMARTT &
JULIANA BOND
VOL. 879, PG. 14

TRACT 1
NAN L. SMARTT &
JULIANA BOND
VOL. 879, PG. 14

APPROVED FOR
CONSTRUCTION

AUG 2 2007

City of Rockwall Engineering Dept.
City Engineer: CAE

AMENDED
SITE PLAN
503 S. GOLIAD STREET
LOT 1, BLOCK A
CARABAJAL ADDITION
CITY OF ROCKWALL
ROCKWALL COUNTY, TEXAS

OWNER:
IRMA CARABAJAL
5930 LBJ SUITE 250
DALLAS, TEXAS 75240
972-788-9188

R.S.C.I.
ROCKWALL SURVEYING CO., INC. LAND SURVEYING
1984 S. FM 551 ROYSE CITY, TX 75189 972-772-5434 PHONE 972-772-5443 FAX

SYMBOL LEGEND	
	TELEVISION CABLE RISER
	GAS RISER
	PHONE RISER
	FIRE HYDRANT
	POWER POLE
	ELECTRIC METER
	TU ELEC BOX
	SUBSURFACE JUNCTION BOX
	FENCE
	WATER METER
	1/2" IRF
	AIR COND. UNIT
	PROPANE TANK

SURVEY DATE JULY 29, 2007
SCALE 1" = 20' FILE # 20061466-SP
CLIENT CARABAJAL GF# NONE

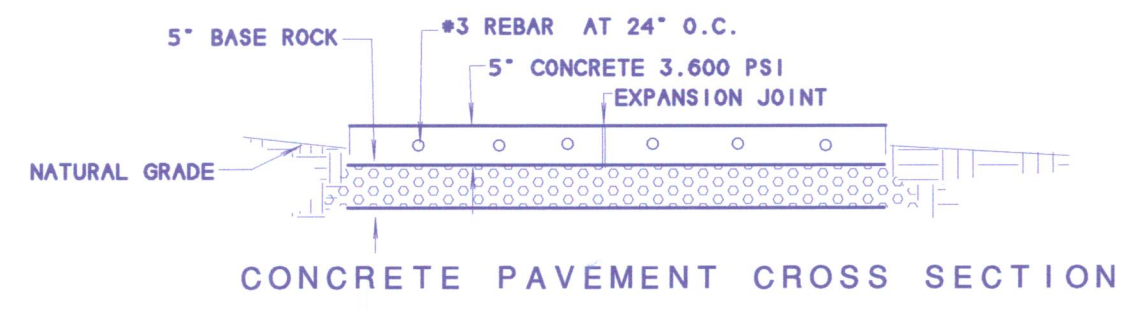

THIS AREA NOT CONTAINED
IN EXISTING DEEDS