

Concrete parking lot for 5811 FM 3097  
-3000 PSI  
-5" Thick pour  
-3/8" Steel reinforcing bar on 14" centers

Contact: Craig Stevenson  
972.839.1240

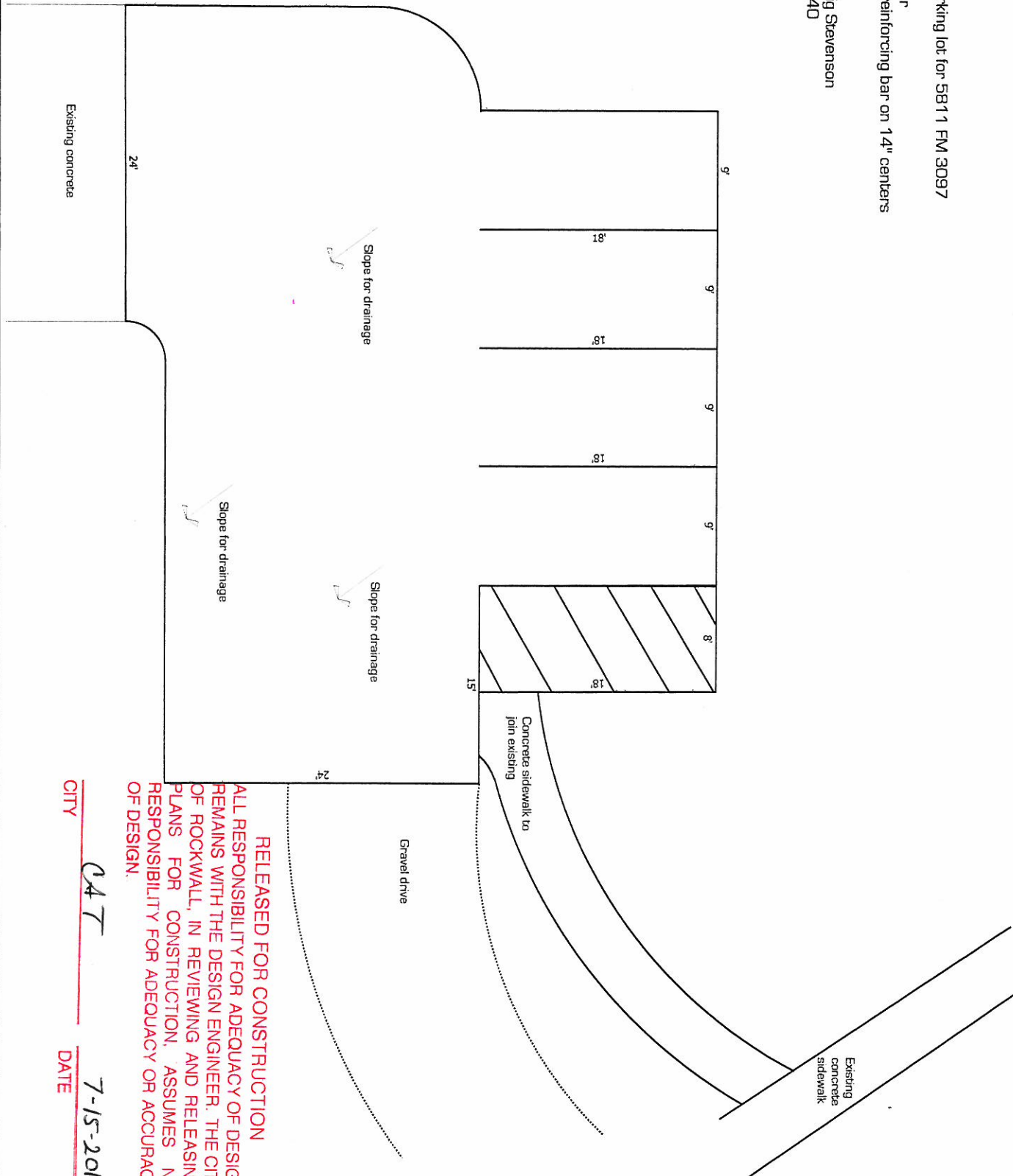

**RELEASED FOR CONSTRUCTION**  
ALL RESPONSIBILITY FOR ADEQUACY OF DESIGN  
REMAINS WITH THE DESIGN ENGINEER. THE CITY  
OF ROCKWALL, IN REVIEWING AND RELEASING  
PLANS FOR CONSTRUCTION, ASSUMES NO  
RESPONSIBILITY FOR ADEQUACY OR ACCURACY  
OF DESIGN.

CITY   CAT   DATE   7-15-2011