

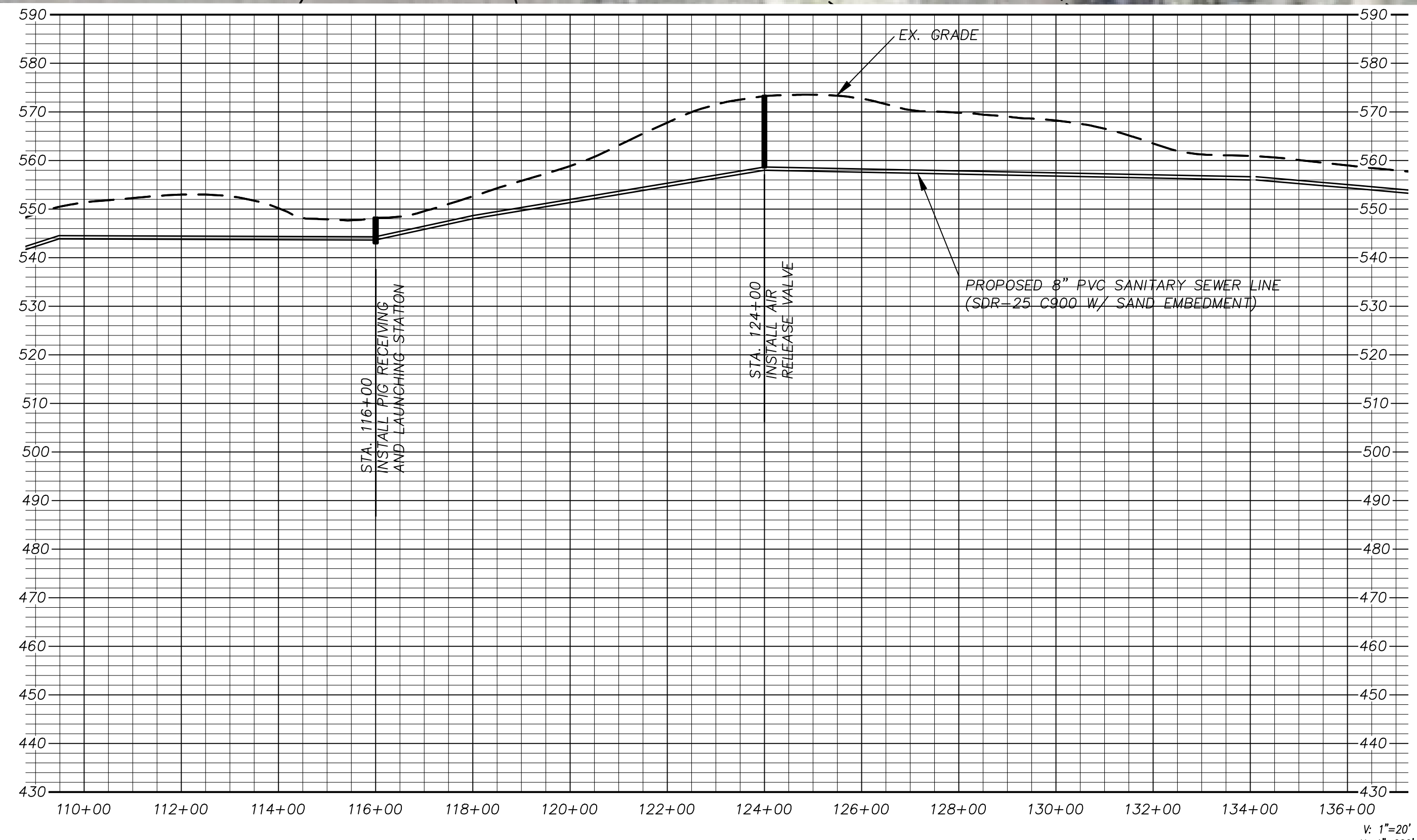

LEGEND

	EX. CONTOURS
	PROPOSED SANITARY SEWER MAIN
	EX. RIGHT-OF-WAY



Revision	Date	Description

Owner:
City of McLendon-Chisholm
 1248 S. Hwy. 205 • McLendon-Chisholm, TX • 75032
 Phone: 972-524-2077

City of McLendon-Chisholm
SANITARY SEWER MAIN

F.C. CUNY CORPORATION
 #2 Horizon Court • Ste. 500 • Heath, Texas 75032
 Phone: 469-402-7700
 Fax: 469-402-0700
 Texas Registered Engineering Firm F-7449

THE SEAL APPEARING ON THIS DOCUMENT WAS AUTHORIZED BY CHRISTOPHER R. CUNY, P.E. 65642

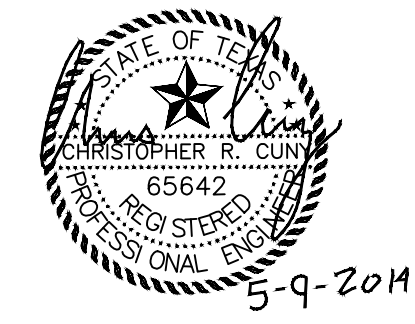

Drawn By: FC CUNY	Checked By: FC CUNY
Date: 12-12	Project No.: 08-007

Sheet Title:
Offsite Sanitary Sewer
Sta. 110+00 to Sta. 136+00

Scale: 1"=100'	Sheet No.: 6 of 12
-------------------	-----------------------

RECORD DRAWING