

LEGEND

- EX. CONTOURS
- PROPOSED SANITARY SEWER MAIN
- EX. RIGHT-OF-WAY

Scale: 1" = 100'

North Arrow: N, S, E, W

EX. STA. 586+67.81
STA. -2+73
CONNECT TO EX. NTMWD 5' DIA. TYPE "S" M.H.
CONTRACTOR TO VERIFY TIE IN AT MANHOLE TO AVOID
CORING MANHOLE AT AN EXISTING JOINT.
EX. FL = ±433.00
FL 10" = 436.00

STA. -2+68
INSTALL:
2-22.5' BEND
FL 10" = 436.02

STA. -2+33
INSTALL:
2-22.5' BEND
FL 10" = 436.16

STA. 2+00
INSTALL:
1-10"x8" REDUCER
FL 10" = 437.90
FL 8" = 438.06

DRY BORE UNDER RABBIT RIDGE ROAD. SANITARY SEWER LINE TO BE STEEL ENCASED 10' ON EITHER SIDE OF RABBIT RIDGE ROAD PAVEMENT LIMITS. (SEE DETAIL ON SHEET 1 FOR BORE UNDER NON-TXDOT ROAD.)

STA. 27+00
INSTALL 4' DIA. RAVEN LINED MANHOLE WITH AN ODOR CONTROL UNIT. RE: DETAIL ON SHEET 12 OF 12.
END 12" SANITARY SEWER GRAVITY MAIN
RIM EL. = ±524.4
FL 8" (OUT) = 520.00
FL 8" (IN) = 520.10

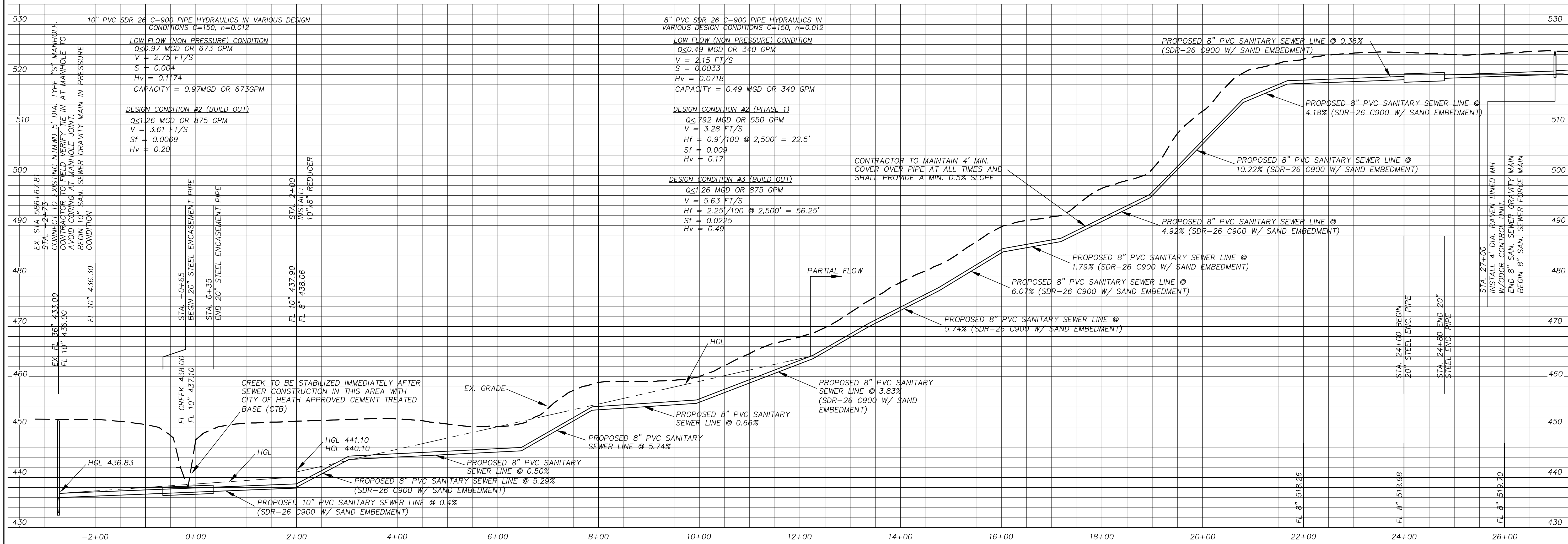

10" PVC SDR 26 C-900 PIPE HYDRAULICS IN VARIOUS DESIGN CONDITIONS C=150, n=0.012

LOW FLOW (NON PRESSURE) CONDITION
Q ≤ 0.97 MGD OR 673 GPM
V = 2.75 FT/S
S = 0.004
Hv = 0.1174
CAPACITY = 0.97MGD OR 673GPM

DESIGN CONDITION #2 (BUILD OUT)
Q ≤ 1.26 MGD OR 875 GPM
V = 3.61 FT/S
Sf = 0.0069
Hv = 0.20

8" PVC SDR 26 C-900 PIPE HYDRAULICS IN VARIOUS DESIGN CONDITIONS C=150, n=0.012

LOW FLOW (NON PRESSURE) CONDITION
Q ≤ 0.49 MGD OR 340 GPM
V = 2.15 FT/S
S = 0.0033
Hv = 0.0718
CAPACITY = 0.49 MGD OR 340 GPM

DESIGN CONDITION #2 (PHASE 1)
Q ≤ 792 MGD OR 550 GPM
V = 3.28 FT/S
Hf = 0.9' / 100' @ 2,500' = 22.5'
Sf = 0.009
Hv = 0.17

DESIGN CONDITION #3 (BUILD OUT)
Q ≤ 1.26 MGD OR 875 GPM
V = 5.63 FT/S
Hf = 2.25' / 100' @ 2,500' = 56.25'
Sf = 0.0225
Hv = 0.49

CONTRACTOR TO MAINTAIN 4' MIN. COVER OVER PIPE AT ALL TIMES AND SHALL PROVIDE A MIN. 0.5% SLOPE

CREEK TO BE STABILIZED IMMEDIATELY AFTER SEWER CONSTRUCTION IN THIS AREA WITH CITY OF HEATH APPROVED CEMENT TREATED BASE (CTB)

PARTIAL FLOW

Revision	Date	Description

Owner:
City of McLendon-Chisholm
1248 S. Hwy 205 • McLendon-Chisholm, TX • 75032
Phone: 972-524-2077

City of McLendon-Chisholm
SANITARY SEWER MAIN

F.C. CUNY CORPORATION
#2 Horizon Court • Ste. 500 • Heath, Texas 75032
Phone: 469-402-7700
Fax: 469-402-0700
Texas Registered Engineering Firm F-7449

THE SEAL APPEARING ON THIS DOCUMENT WAS AUTHORIZED BY CHRISTOPHER R. CUNY, P.E. 65642

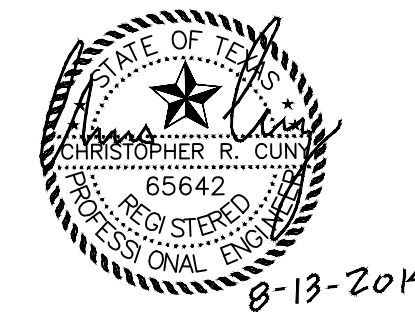

Drawn By: FC CUNY
Checked By: FC CUNY
Date: 12-12
Project No.: 08-007

Sheet Title:
Offsite Sanitary Sewer Sta. 0+00 to Sta. 28+00

Scale: 1"=100'
Sheet No.: 2 of 12

RECORD DRAWING