

CURVE	DELTA	LENGTH, FT	RADIUS, FT	TANGENT, FT	CHORD BR	CHORD, FT
C30	90°27'53"	46.58	29.50	29.74	S89°50'50"W	41.89
C31	90°15'11"	46.47	29.50	29.63	N00°30'42"W	41.81
C65	12°46'29"	56.41	253.00	28.32	S38°13'39"W	56.29
C66	12°46'29"	56.19	252.00	28.21	S38°13'39"W	56.07

MATCHLINE STA 14+00

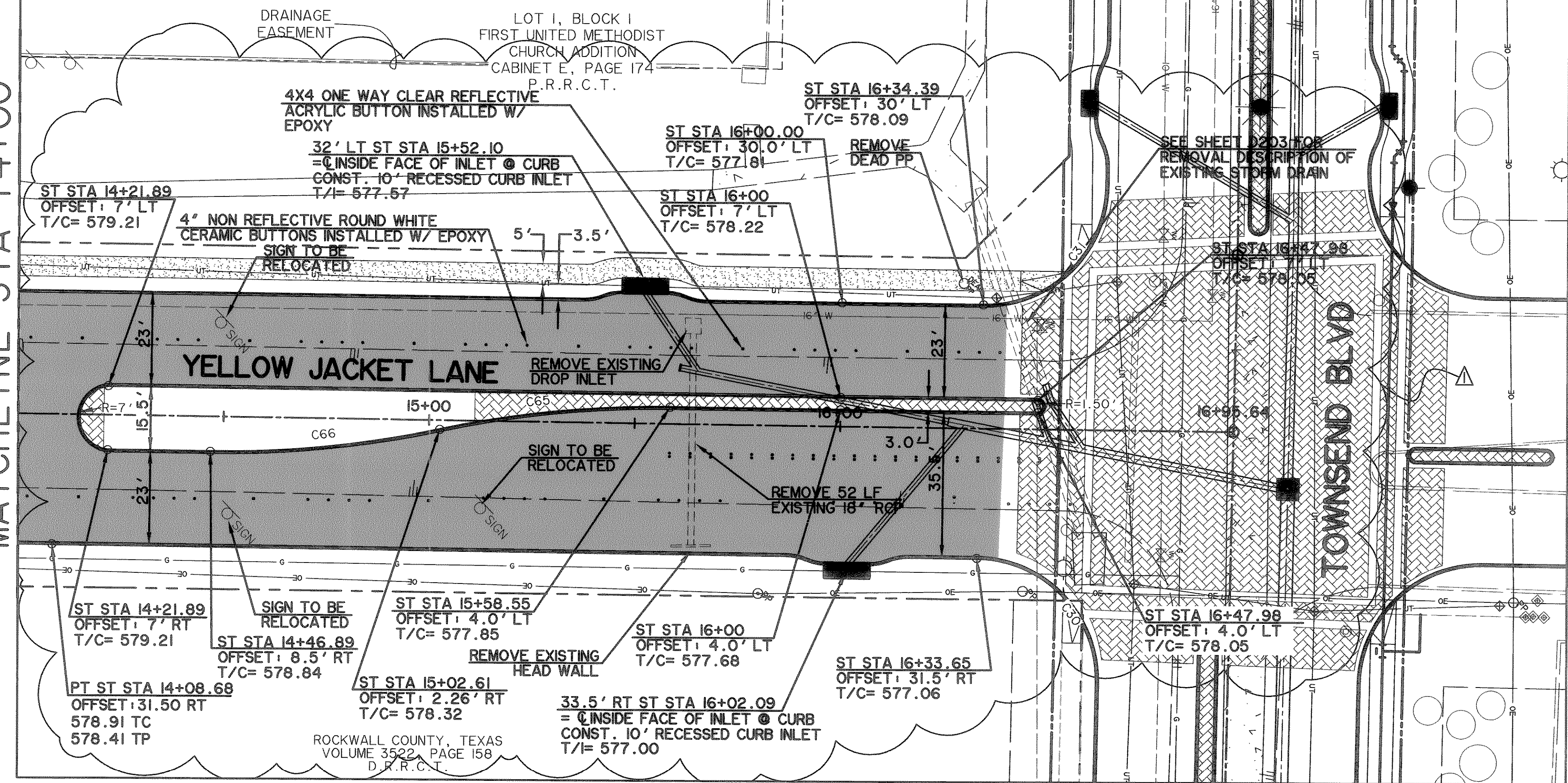

CAUTION !!!
UNDERGROUND UTILITIES

EXISTING UTILITIES AND UNDERGROUND FACILITIES INDICATED ON THESE PLANS HAVE BEEN LOCATED FROM REFERENCE INFORMATION SUPPLIED BY VARIOUS OWNERS OF THE FACILITIES. THE ENGINEER DOES NOT ACCEPT THE RESPONSIBILITY FOR THE UTILITY LOCATIONS SHOWN. IT SHALL BE THE RESPONSIBILITY OF THE CONTRACTOR TO VERIFY BOTH HORIZONTALLY AND VERTICALLY THE LOCATION OF ALL EXISTING UTILITIES AND UNDERGROUND FACILITIES PRIOR TO CONSTRUCTION, TO TAKE NECESSARY PRECAUTIONS IN ORDER TO PROTECT ALL FACILITIES ENCOUNTERED, AND TO NOTIFY THE ENGINEER PROMPTLY OF ALL CONFLICTS OF THE WORK WITH EXISTING FACILITIES. THE CONTRACTOR SHALL PRESERVE AND PROTECT ALL EXISTING UTILITIES FROM DAMAGE DURING CONSTRUCTION. ANY DAMAGE BY THE CONTRACTOR TO EXISTING UTILITIES SHALL BE REPAIRED BY THE CONTRACTOR AT HIS EXPENSE. CONTACT ALL POSSIBLE UTILITY AND UNDERGROUND FACILITY OWNERS.

NOTES

1. CONTRACTOR SHALL COORDINATE RELOCATIONS WITH FRANCHISE UTILITIES AT LEAST THREE WEEKS PRIOR TO CONSTRUCTION.
2. ALL DIMENSIONS, LINES, CURVES, AND POINTS ARE TO THE BACK OF CURB UNLESS NOTED OTHERWISE.

REVISION:

▲ MODIFIED T/C ELEVATIONS AND LOCATIONS AND MEDIAN NOSE GEOMETRY

3/21/06

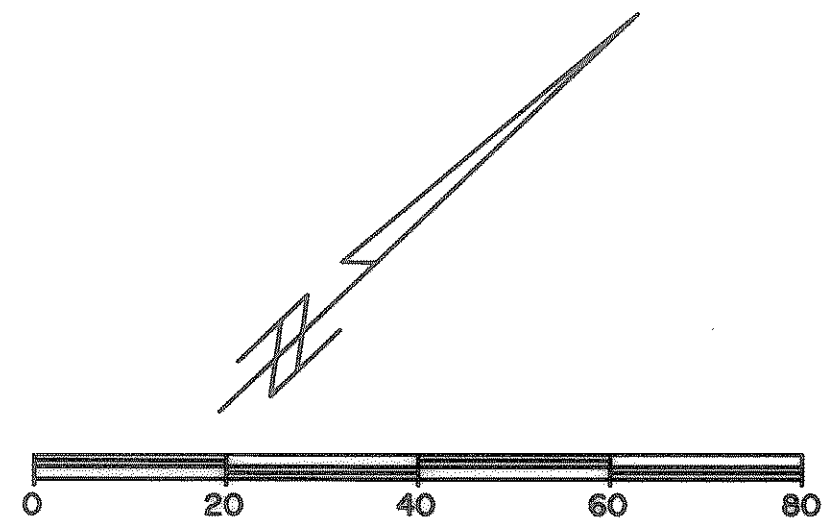

BENCHMARKS:

□ CUT IN THE EAST END OF THE HEADWALL LOCATED ON THE NORTHWEST CORNER OF THE INTERSECTION OF BOYDSTUN STREET AND CLARK STREET. ELEVATION 534.21

□ CUT IN THE SOUTHWEST CORNER OF THE HEADWALL LOCATED ON THE WEST SIDE OF INDUSTRIAL BLVD, APPROXIMATELY 250± FEET NORTH OF THE INTERSECTION OF INDUSTRIAL AND THE I-30 ACCESS ROAD. ELEVATION 544.77

LEGEND

- 4200 PSI CONCRETE PAVEMENT
- PROPOSED SIDEWALK
- PROPOSED ASPHALT PAVEMENT
- INTERLOCKING PAVING STONES TO BE APPROVED BY CITY
- EXISTING WATER LINE
- EXISTING SANITARY SEWER LINE
- R.O.W. LINE
- LOT LINE
- FIRE HYDRANT
- STORM DRAIN INLET
- WATER VALVE
- DIRECTION OF FLOW
- EXISTING SIGN
- EXISTING OVERHEAD ELECTRIC
- EXISTING UNDERGROUND GAS
- EXISTING WATER VALVE
- EXISTING UNDERGROUND TELEPHONE
- BARRIER FREE RAMP TO BE CONST. W/PROJECT

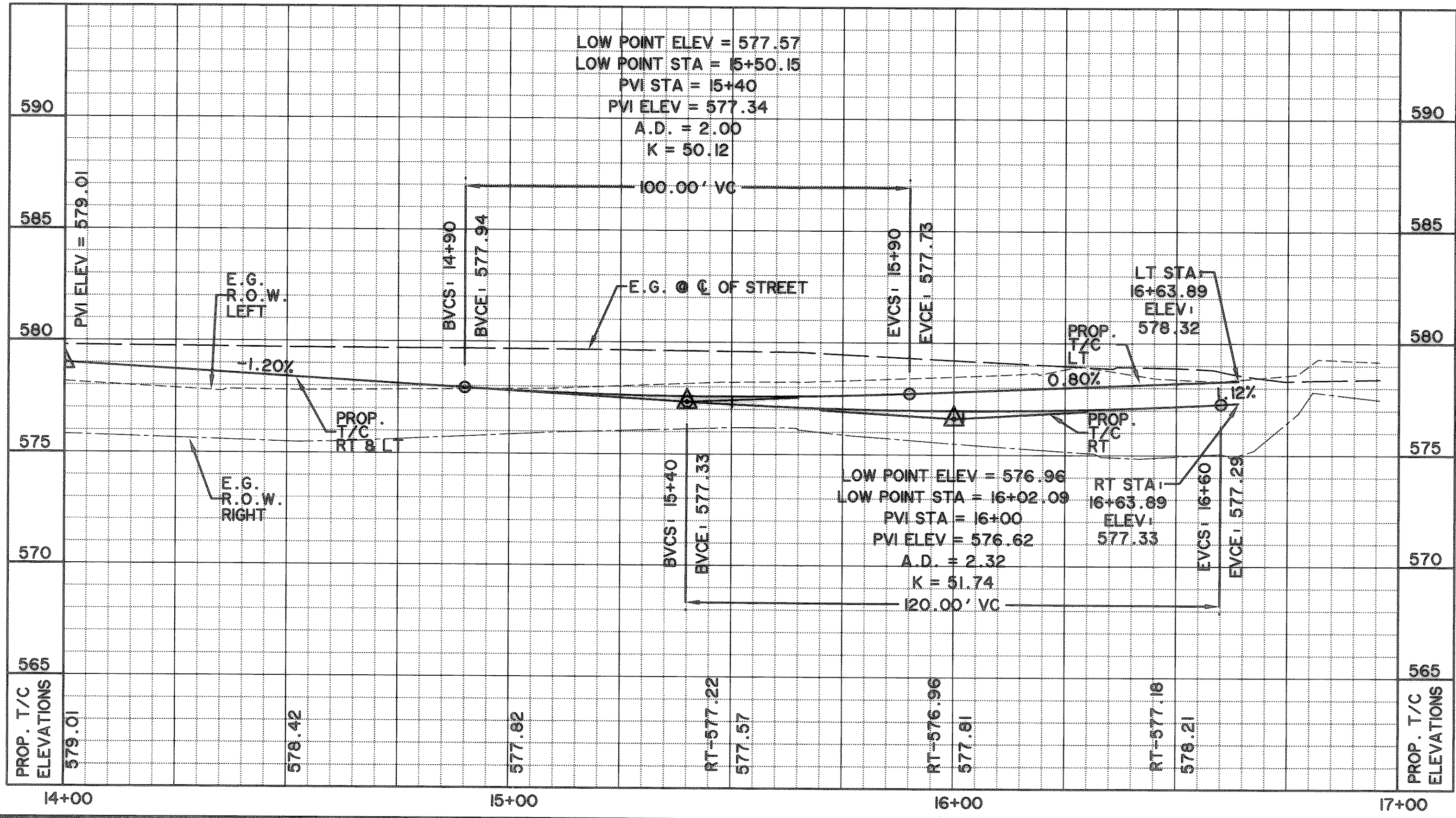

RECORD DRAWING
02/06/07

PREPARED BY:
WIA WIER & ASSOCIATES, INC.
ENGINEERS SURVEYORS LAND PLANNERS
4300 BELLEVUE PLACE, SUITE 130 ARLINGTON, TEXAS 76018 METRO (817)467-7700
1300 U.S. HIGHWAY 287 N. SUITE 101 WAXSFIELD, TEXAS 76063 METRO (817)477-6700
6840 ELM STREET PERSCO, TEXAS 75084 METRO (214)387-8800
www.wierassociates.com

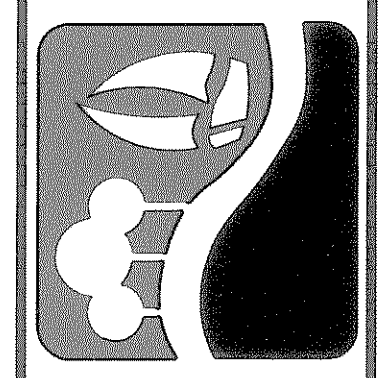

CITY OF ROCKWALL
TOWNSEND BLVD
(I.H. 30 TO JUSTIN)
& YELLOW JACKET LN
(S.H. 205 TO TOWNSEND)

YELLOW JACKET LANE-PAVING PLAN AND PROFILE, STA 14+00 TO 17+00

STATE OF TEXAS
RONALD RAMIREZ
81821
REGISTERED PROFESSIONAL ENGINEER

Ronald Ramirez

COPYRIGHT © WIER & ASSOCIATES, INC.
LAST SHEET EDIT
DATE: 07-26-2007
WA# 04124

SHEET NO. P112