

TIME 10.44 FILE: PAVES_I-04124.dwg

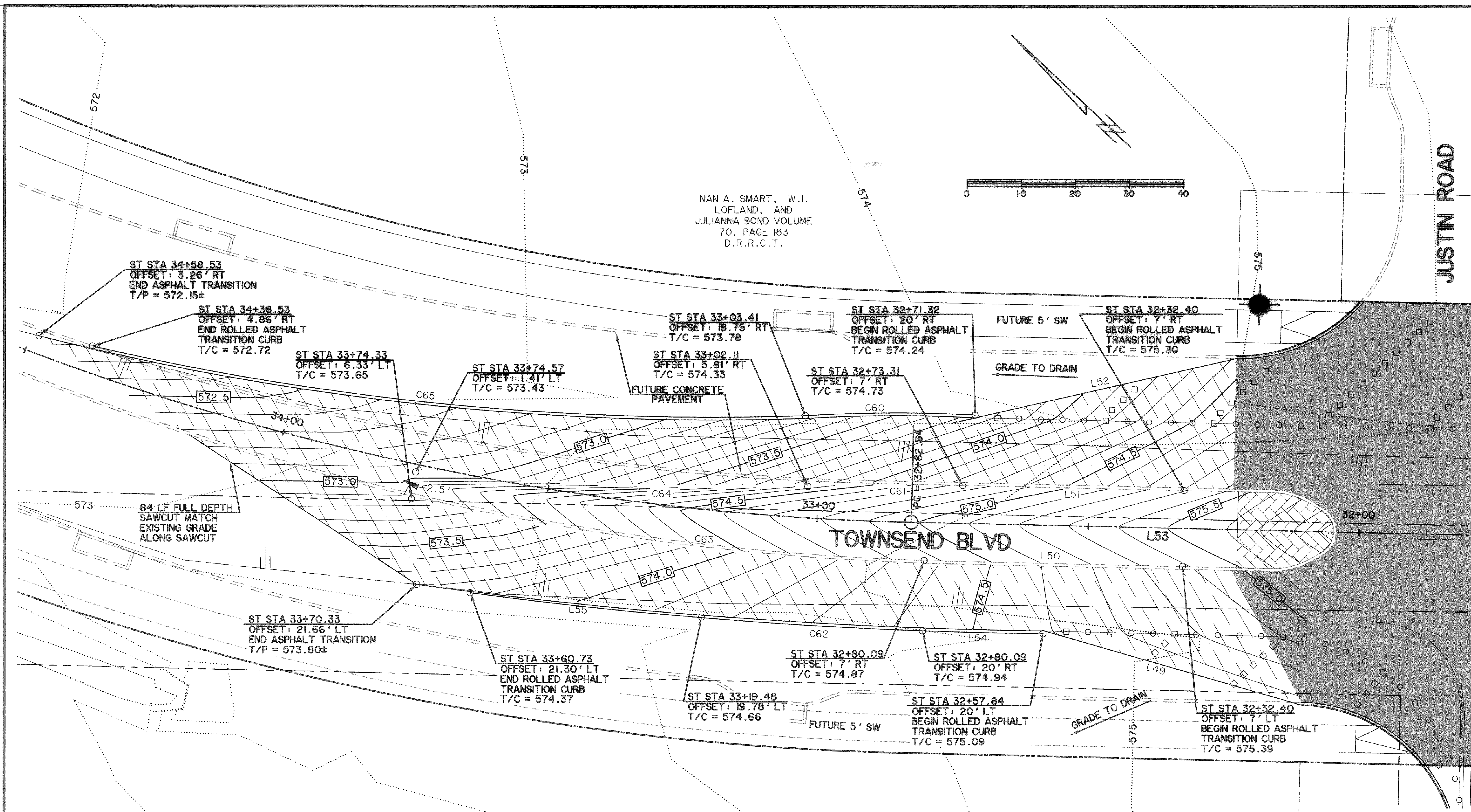

NAN A. SMART, W.I.
LOFLAND, AND
JULIANNA BOND VOLUME
70, PAGE 183
D.R.R.C.T.

LOT 1A-R, BLOCK A
LOFLAND INDUSTRIAL
CABINET E, PAGE 138
PARK ADDITION
P.R.R.C.T.

CAUTION !!!
UNDERGROUND UTILITIES

EXISTING UTILITIES AND UNDERGROUND FACILITIES INDICATED ON THESE PLANS HAVE BEEN LOCATED FROM REFERENCE INFORMATION SUPPLIED BY VARIOUS OWNERS OF THE FACILITIES. THE ENGINEER DOES NOT ACCEPT THE RESPONSIBILITY FOR THE UTILITY LOCATIONS SHOWN, IT SHALL BE THE RESPONSIBILITY OF THE CONTRACTOR TO VERIFY BOTH HORIZONTALLY AND VERTICALLY THE LOCATION OF ALL EXISTING UTILITIES AND UNDERGROUND FACILITIES PRIOR TO CONSTRUCTION, TO TAKE NECESSARY PRECAUTIONS IN ORDER TO PROTECT ALL FACILITIES ENCOUNTERED, AND TO NOTIFY THE ENGINEER PROMPTLY OF ALL CONFLICTS OF THE WORK WITH EXISTING FACILITIES. THE CONTRACTOR SHALL PRESERVE AND PROTECT ALL EXISTING UTILITIES FROM DAMAGE DURING CONSTRUCTION. ANY DAMAGE BY THE CONTRACTOR TO EXISTING UTILITIES SHALL BE REPAIRED BY THE CONTRACTOR AT HIS EXPENSE. CONTACT ALL POSSIBLE UTILITY AND UNDERGROUND FACILITY OWNERS.

**RECORD
DRAWING**
02/06/07

NOTE: SEE SHEETS P107 AND P108 FOR UTILITY LINES, FENCES, SIGNS AND OTHER PERTINENT INFORMATION.

LINE	LENGTH, FT	BEARING
L49	49.48	N29°39'06" W
L50	58.99	N43°41'17" W
L51	66.79	N43°41'17" W
L52	49.49	N57°43'27" W
L53 CL	783.92	N43°41'17" W
L54	22.19	N43°41'17" W
L55	42.96	N39°07'12" W

CURVE	DELTA	LENGTH, FT	RADIUS, FT	TANGENT, FT	CHORD BR	CHORD, FT
C60	03°29'39"	31.26	512.50	15.63	N45°13'10" W	31.25
C61	03°16'42"	28.58	499.50	14.29	N45°19'38" W	28.58
C62	04°34'04"	40.86	512.50	20.44	N41°24'15" W	40.85
C63	10°57'06"	95.48	499.50	47.88	N38°12'44" W	95.33
C64	14°51'19"	132.62	511.50	66.68	N39°32'20" W	132.25
C65	07°55'08"	72.49	524.50	36.30	N43°00'25" W	72.43

BENCHMARKS:
 [Symbol] CUT IN THE EAST END OF A HEAD-WALL LOCATED ON THE NORTHWEST CORNER OF THE INTERSECTION OF BOYDSTUN STREET AND CLARK STREET. ELEVATION 534.21
 [Symbol] CUT IN THE SOUTHWEST CORNER OF THE HEADWALL LOCATED ON THE WEST SIDE OF INDUSTRIAL BLVD, APPROXIMATELY 250± FEET NORTH OF THE INTERSECTION OF INDUSTRIAL AND THE I-30 ACCESS ROAD. ELEVATION 544.77

LEGEND
 [Symbol] 4200 PSI CONCRETE PAVEMENT
 [Symbol] PROPOSED SIDEWALK
 [Symbol] PROPOSED ASPHALT PAVEMENT
 [Symbol] DIRECTION OF FLOW
 [Symbol] BARRIER FREE RAMP TO BE CONST. W/PROJECT

PREPARED BY:
WIER & ASSOCIATES, INC.
 ENGINEERS SURVEYORS LAND PLANNERS
 4300 BELTWAY PLACE SUITE 130 ARLINGTON, TEXAS 76018 METRO (817)467-7700
 1300 U.S. HIGHWAY 207 N. SUITE 101 WANSFELD, TEXAS 76063 METRO (817)477-8700
 6840 ELM STREET PRISDO, TEXAS 75034 METRO (214)387-8000
 www.wierassociates.com

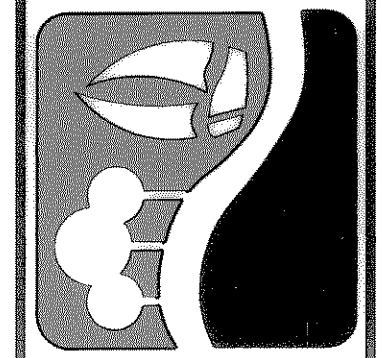

**CITY OF ROCKWALL
 TOWNSEND BLVD
 (I.H. 30 TO JUSTIN)
 & YELLOW JACKET LN
 (S.H. 205 TO TOWNSEND)**

**TOWNSEND BLVD-
 DETAILED
 TRANSITION
 GRADING**

STATE OF TEXAS
 RONALD RAMIREZ
 81821
 REGISTERED PROFESSIONAL ENGINEER
 COPYRIGHT ©
 WIER & ASSOCIATES, INC.
 LAST SHEET EDIT
 DATE 07-26-2007
 WA# 04124
**SHEET NO.
 P108.1**