

CAUTION !!!
UNDERGROUND UTILITIES

EXISTING UTILITIES AND UNDERGROUND FACILITIES INDICATED ON THESE PLANS HAVE BEEN LOCATED FROM REFERENCE INFORMATION SUPPLIED BY VARIOUS OWNERS OF THE FACILITIES. THE ENGINEER DOES NOT ACCEPT THE RESPONSIBILITY FOR THE UTILITY LOCATIONS SHOWN, IT SHALL BE THE RESPONSIBILITY OF THE CONTRACTOR TO VERIFY BOTH HORIZONTALLY AND VERTICALLY THE LOCATION OF ALL EXISTING UTILITIES AND UNDERGROUND FACILITIES PRIOR TO CONSTRUCTION, TO TAKE NECESSARY PRECAUTIONS IN ORDER TO PROTECT ALL FACILITIES ENCOUNTERED, AND TO NOTIFY THE ENGINEER PROMPTLY OF ALL CONFLICTS OF THE WORK WITH EXISTING FACILITIES. THE CONTRACTOR SHALL PRESERVE AND PROTECT ALL EXISTING UTILITIES FROM DAMAGE DURING CONSTRUCTION. ANY DAMAGE BY THE CONTRACTOR TO EXISTING UTILITIES SHALL BE REPAIRED BY THE CONTRACTOR AT HIS EXPENSE. CONTACT ALL POSSIBLE UTILITY AND UNDERGROUND FACILITY OWNERS.

BENCHMARKS:
 'BM' CUT IN THE EAST END OF THE HEADWALL LOCATED ON THE NORTHWEST CORNER OF THE INTERSECTION OF BOYDSTUN STREET AND CLARK STREET. ELEVATION 534.21
 'BM' CUT IN THE SOUTHWEST CORNER OF THE HEADWALL LOCATED ON THE WEST SIDE OF INDUSTRIAL BLVD. APPROXIMATELY 250± FEET NORTH OF THE INTERSECTION OF INDUSTRIAL AND THE I-30 ACCESS ROAD. ELEVATION 544.77

LEGEND
 ——— STORM DRAIN LINE
 - - - R.O.W. LINE
 - - - EXISTING STORM DRAIN
 [] STORM DRAIN INLET
 ← DIRECTION OF FLOW

NOTE: DRAINAGE CALCULATIONS FOR THE EXISTING STORMDRAIN SYSTEM WERE NOT AVAILABLE.

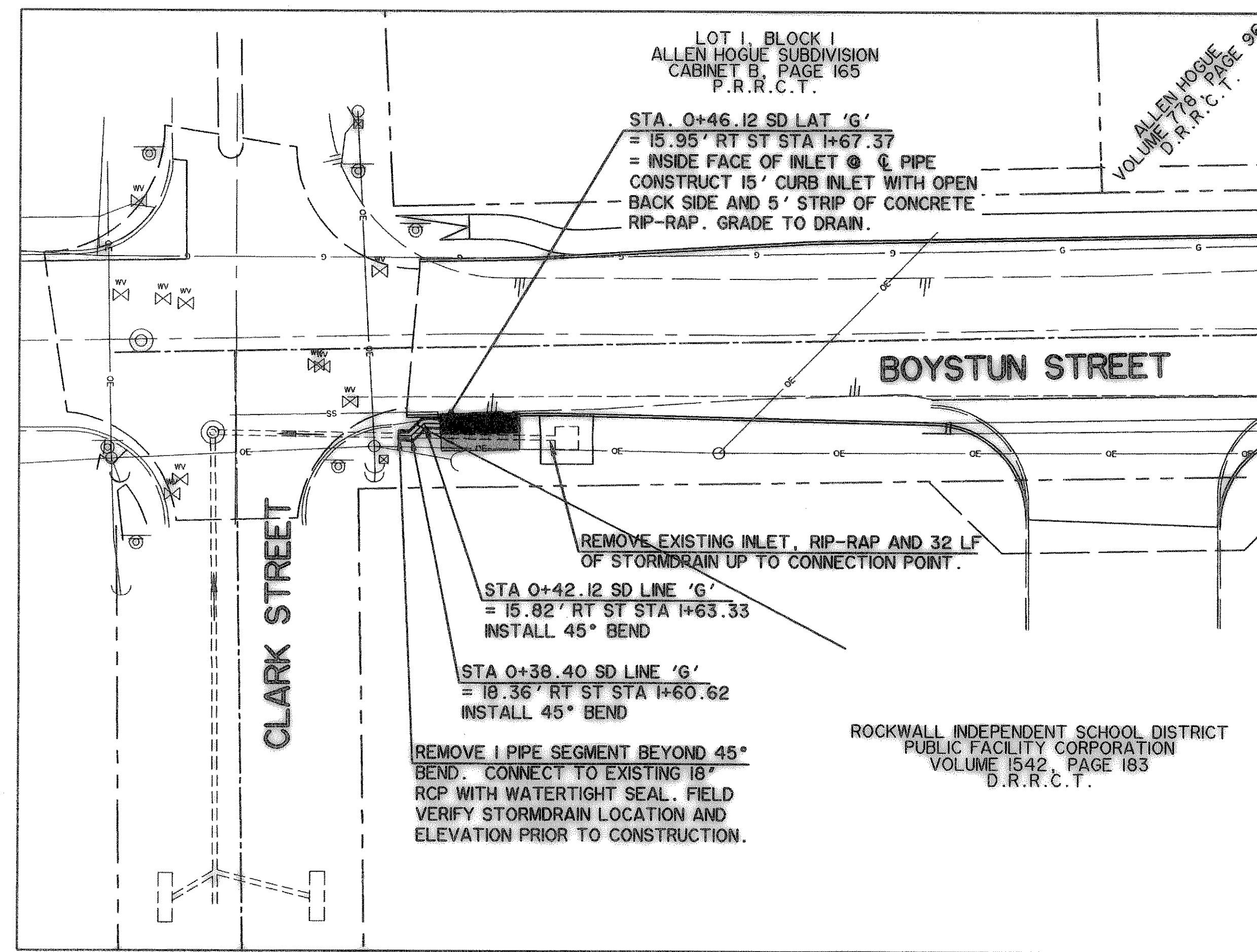
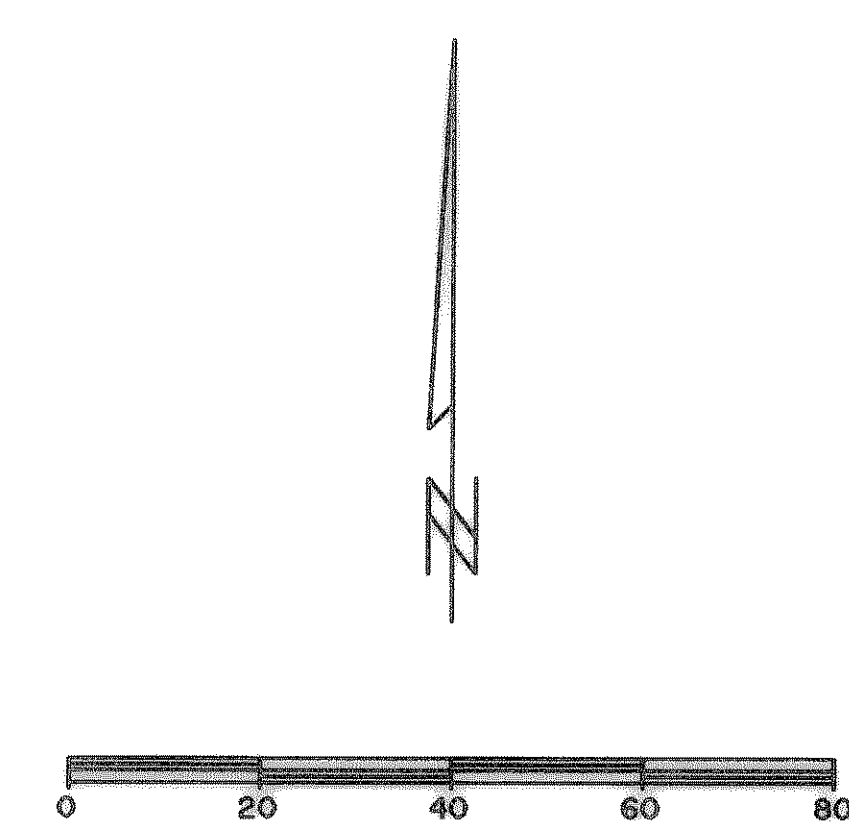

STORMDRAIN LINE 'G'

PREPARED BY:
VIA WIER & ASSOCIATES, INC.
 ENGINEERS SURVEYORS LAND PLANNERS
 701 HIGHLANDER BLVD., SUITE 310 ARLINGTON, TEXAS 76015 METRO (817)467-7700
 6809 ELM STREET FRSO, TEXAS 75004 METRO (214)387-8800
 www.viawierassociates.com

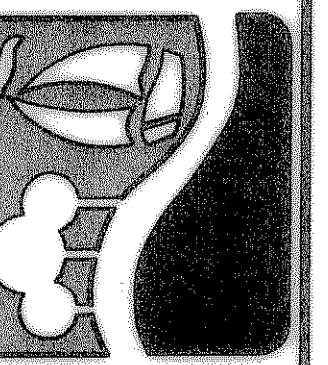

**CITY OF ROCKWALL
 TOWNSEND BLVD
 (JUSTIN RD TO BOYDSTUN ST)
 & BOYDSTUN ST
 (TOWNSEND BLVD TO CLARK ST)**

**BOYSTUN STREET
 STORMDRAIN LINE 'G'**

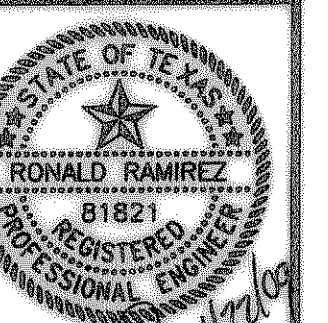

Ronald Ramirez

**RECORD
 DRAWING
 01/16/09**

COPYRIGHT ©
 WIER & ASSOCIATES, INC.
 LAST SHEET EDIT
 DATE 01-07-2009
 WA# 04124

**SHEET NO.
 D107**