

BOUNDARY DEFINED BY
USGS QUAD MAPS

BOUNDARY DEFINED BY
USGS QUAD MAPS

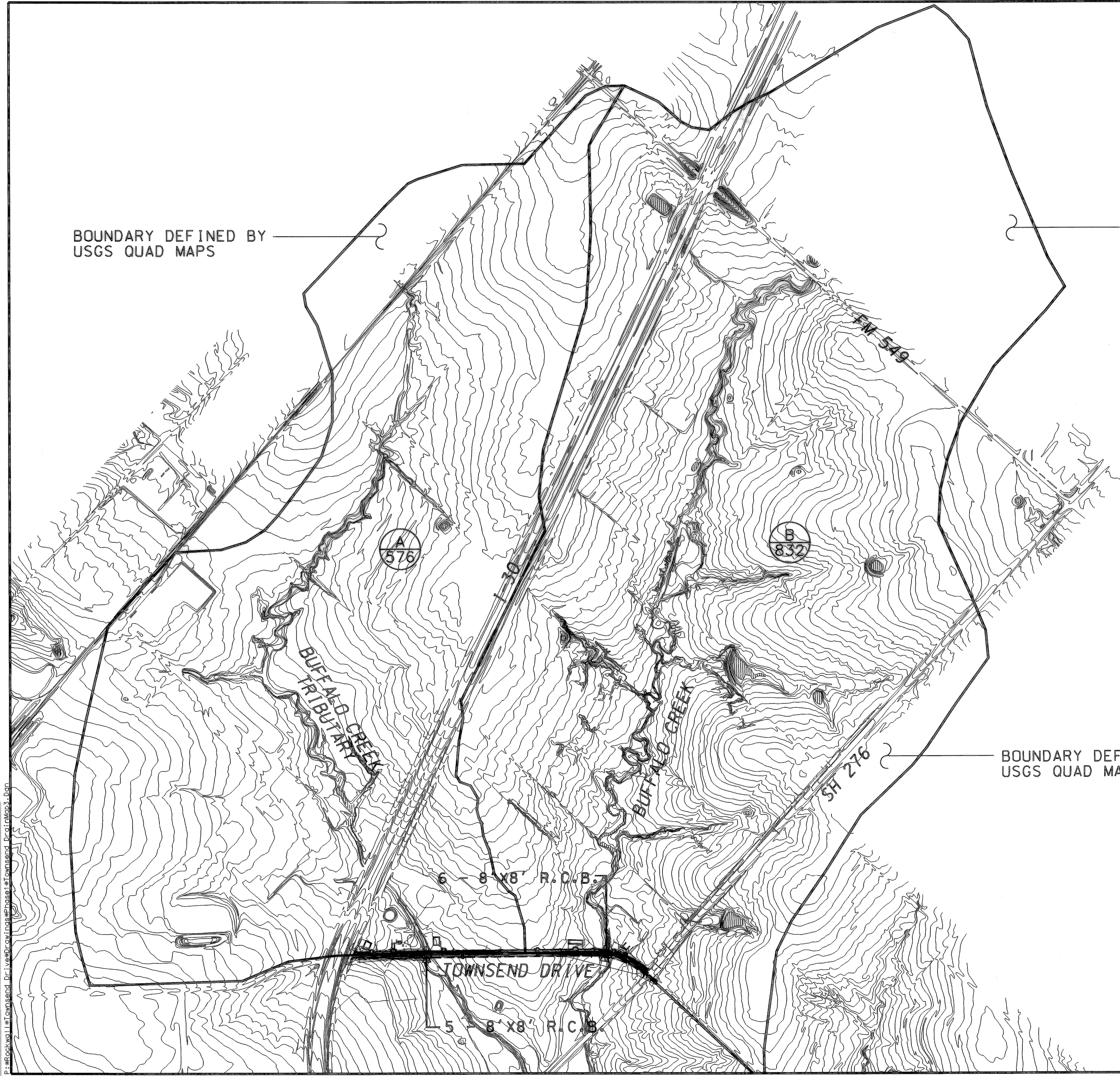

AREA #	A (AC)	Q (CFS)
A	576	2600
B	832	4308

NOTE: FLOW WAS DETERMINED
BY HEC-1 ANALYSIS

LEGEND

- MAJOR DRAINAGE DIVIDE
- DRAINAGE AREA
- ACRES

RECORD DRAWINGS
These record drawings have been prepared using information provided by the Construction Contractor and/or Owner. The seal and signature below only signifies that the plans have been revised in accordance with the information provided and does not guarantee that these plans accurately show every detail of the constructed project.

Voranique Simon 4-2-01
Signature Date

BOUNDARY DEFINED BY
USGS QUAD MAPS

4			
3			
2			
1			
NO.	DATE	REVISION	APPROV.
CITY OF ROCKWALL "THE NEW HORIZON"			
TOWNSEND DRIVE			
DRAINAGE AREA MAP			
TurnerCollie & Braden Inc. ENGINEERS • PLANNERS • PROJECT MANAGERS			
Unit	A123	Scale: Horiz. 1"=500'	Date FEBRUARY, 2001
Designed	VVS	Checked TBS	Job No. 15-00925-200
Drawn	GBA	Approved RCB	Sheet 17 of 72

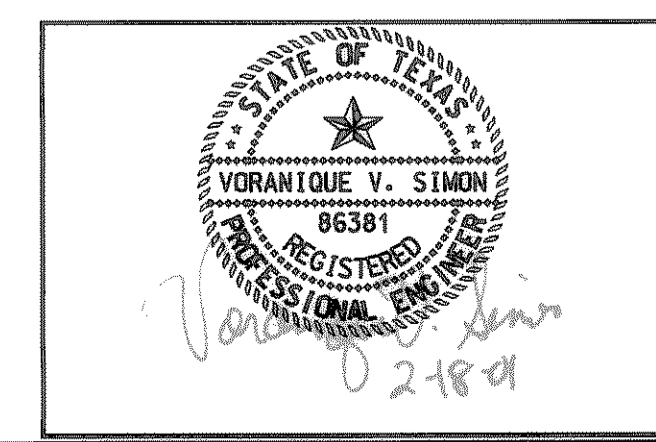

P:\Rockwall\Townsend Drive\Drawings\Phase1\Townsend DrainMap3.Dwg