

- LEGEND**
- PROPOSED CONCRETE CONSTRUCTION
  - FUTURE CONSTRUCTION
  - PROPOSED ASPHALT CONSTRUCTION
  - FUTURE CURB

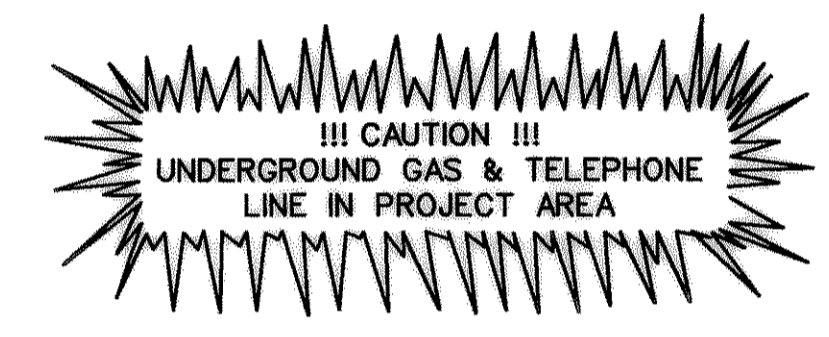

CAMBRIDGE COMPANIES  
VOLUME 105, PAGE 505  
D. R. R. C. T.

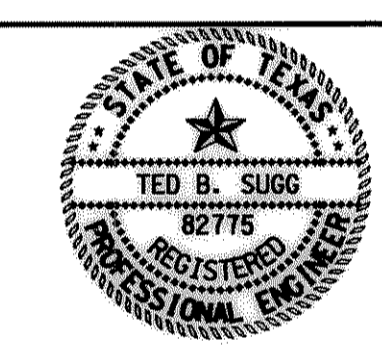

**UNDERGROUND UTILITIES**

THE LOCATION OF EXISTING UTILITIES SHOWN ON THESE PLANS ARE APPROXIMATE AND BASED ON DATA FURNISHED BY UTILITY COMPANIES. IT IS THE RESPONSIBILITY OF THE CONTRACTOR TO LOCATE AND VERIFY ON-SITE THE UTILITIES THAT MAY CONFLICT WITH THE CONSTRUCTION.

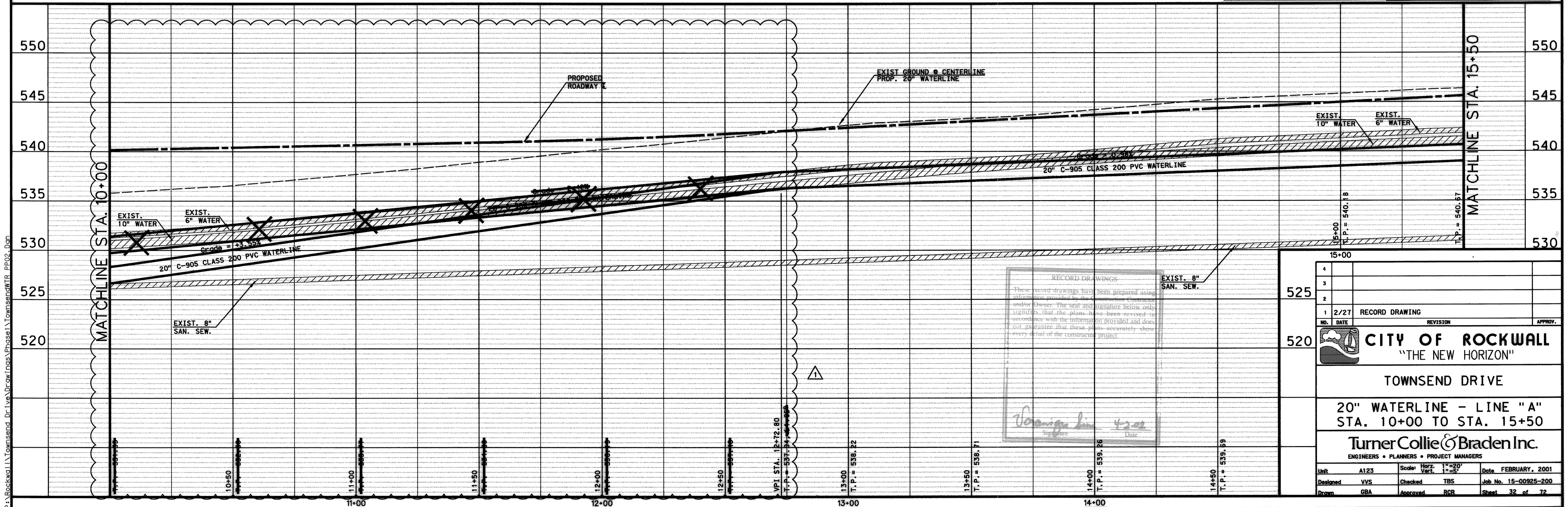

**RECORD DRAWINGS**

These record drawings have been prepared using information provided by the Construction Contract and/or Owner. The seal and signature below only signifies that the plans have been reviewed in accordance with the information provided and does not guarantee that these plans accurately show every detail of the constructed project.

*Signature*  
Date: 4/20/02

4			
3			
2			
1	2/27	RECORD DRAWING	
NO.	DATE	REVISION	APPROV.
<b>CITY OF ROCKWALL</b> "THE NEW HORIZON"			
<b>TOWNSEND DRIVE</b> <b>20" WATERLINE - LINE "A"</b> <b>STA. 10+00 TO STA. 15+00</b>			
<b>TurnerCollie &amp; Braden Inc.</b> ENGINEERS • PLANNERS • PROJECT MANAGERS			
Unit	A123	Scale: Horiz. 1"=20' Vert. 1"=5'	Date: FEBRUARY, 2001
Designed	VVS	Checked: TBS	Job No. 15-00925-200
Drawn	GBA	Approved: RCR	Sheet 32 of 72

P:\Rockwall\Townsend Drive\Drawings\Phase1\TownsendMTR\_PP02.Dwg