

DISCLAIMER: The use of this standard is governed by the "Texas Engineering Practice Act". No warranty of any kind is made by TxDOT for any purpose whatsoever. TxDOT assumes no responsibility for the conversion of this standard to other formats or for incorrect results or damages resulting from its use.

LEVELS DISPLAYED
ACC:

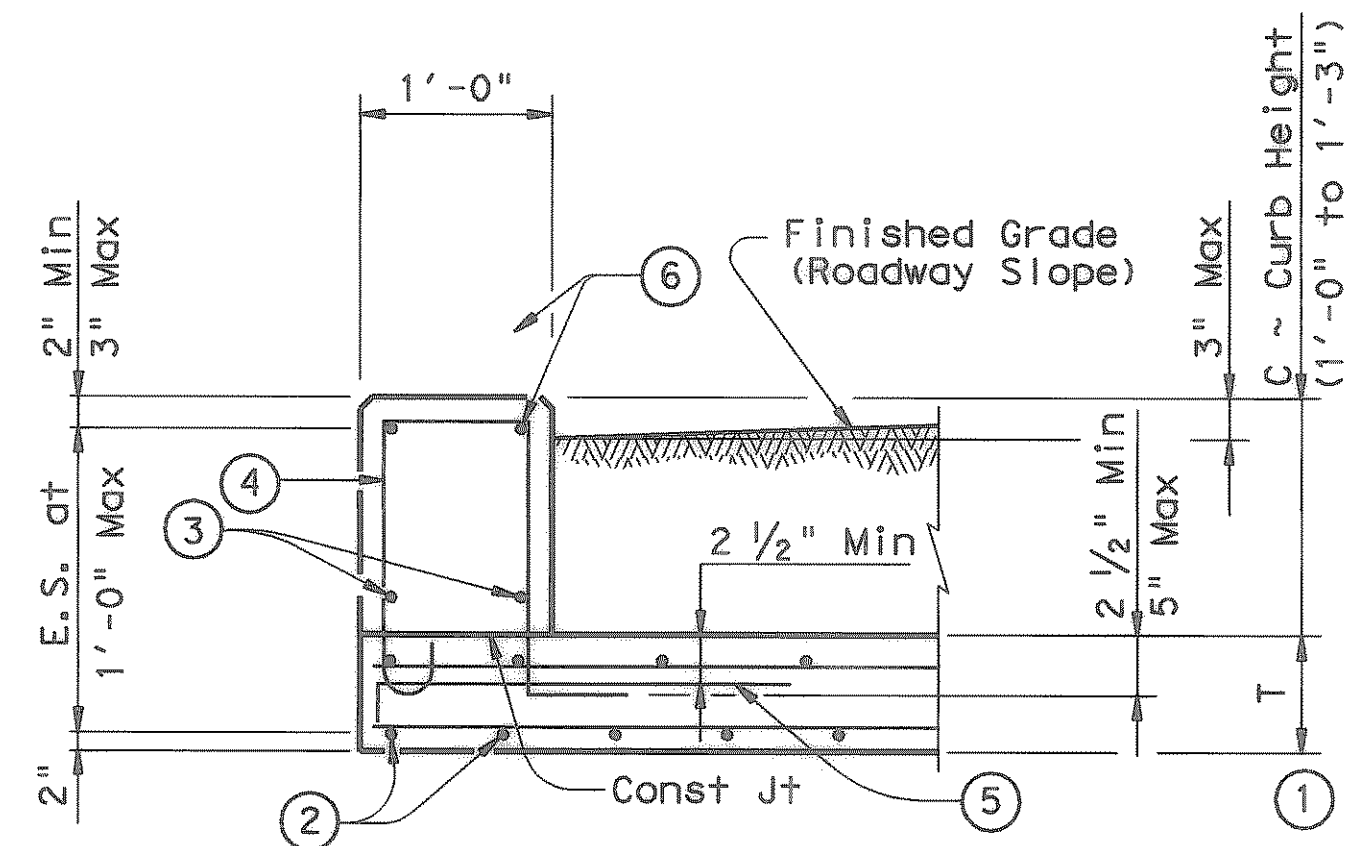

ELEVATION

FILL HEIGHTS FROM 1'-0" TO 1'-3"

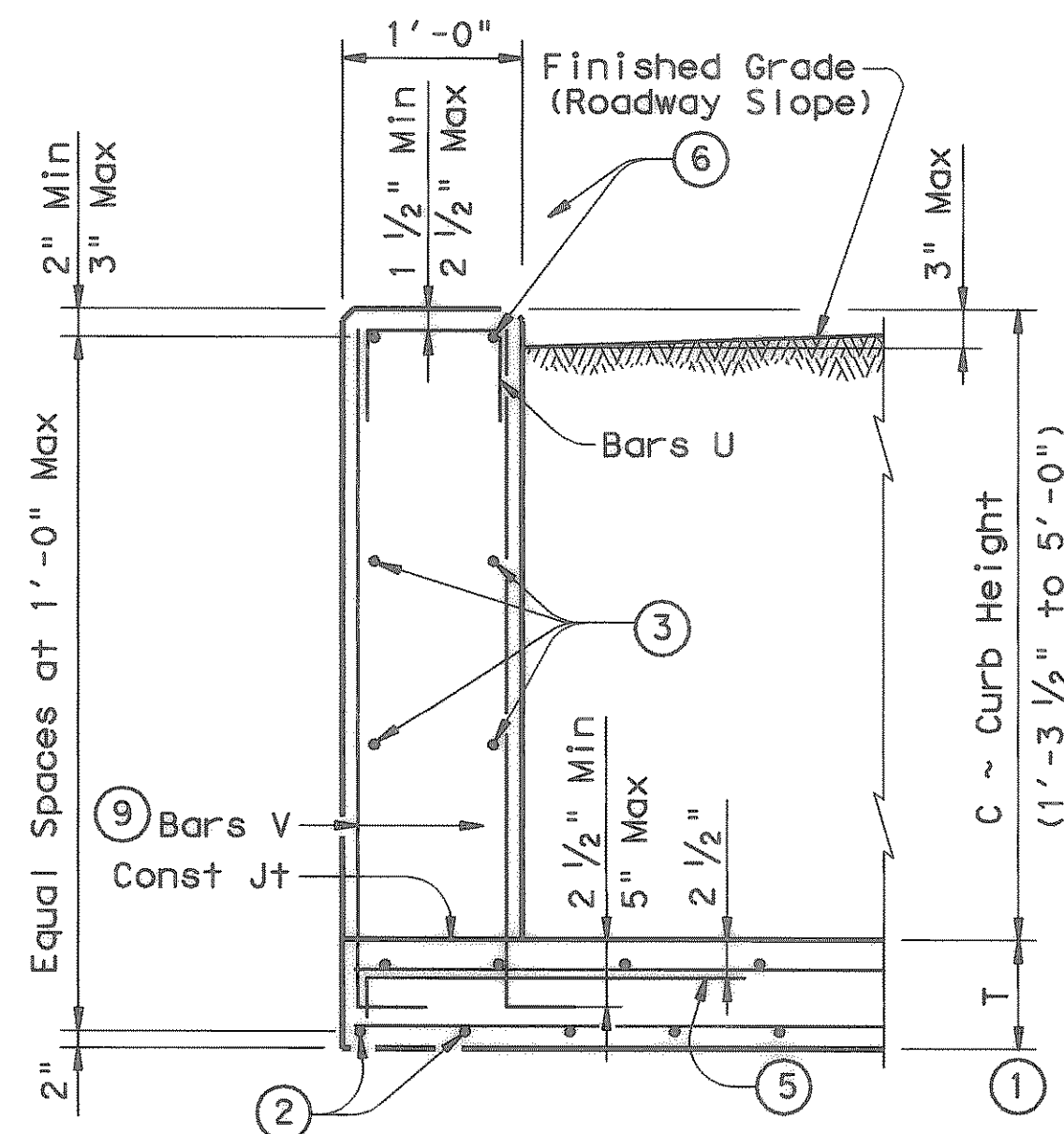

ELEVATION

FILL HEIGHTS FROM 1'-3 1/2" TO 5'-0"

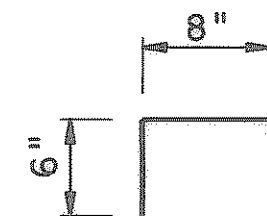

BARS U (#4)
("C" = 1'-3 1/2" to 5'-0")
Space at 2'-0" Max

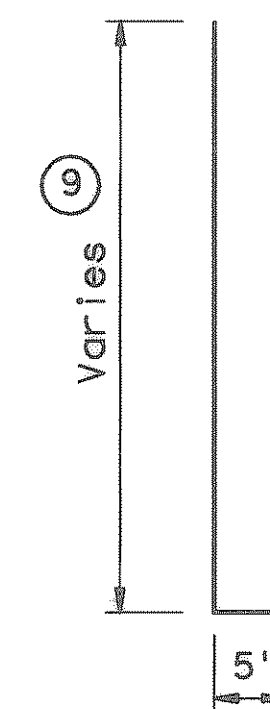

BARS V (#5)
("C" = 1'-3 1/2" to 5'-0")
Space at 1'-0" Max

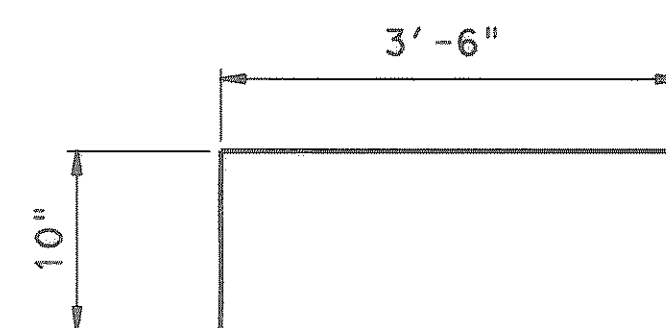

BARS L (#5)
("C" = 1'-0 1/2" to 5'-0")
Space at 1'-0" Max

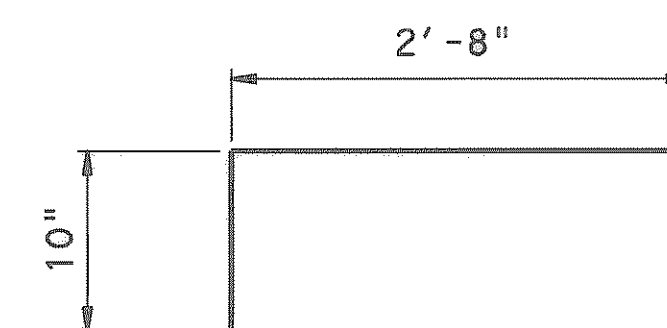

OPTIONAL BARS L (#5)
("C" = 1'-0 1/2" to 5'-0")
Space at 1'-0" Max

TABLE OF ESTIMATED CURB QUANTITIES

Curb Height (C)	Class "C" Conc (CY/F+)	Reinf Steel (Lb/F+)
1'-0"	0.037	5.51
1'-3"	0.046	5.51
1'-3 1/2"	0.048	5.01
1'-9"	0.065	5.49
1'-10"	0.068	6.97
2'-9"	0.102	7.87
2'-10"	0.105	9.29
3'-9"	0.139	10.25
3'-10"	0.142	11.67
4'-9"	0.176	12.63
4'-10"	0.179	14.05
5'-0"	0.185	14.22

- ① For T less than 7" see Standard SCP-MD for details not shown.
- ② Normal Culvert Bars B or additional Bars H per skewed end details.
- ③ Additional #4 Bars as required to maintain 1'-0" max spa.
- ④ Place normal culvert Bars K as shown
- ⑤ For curbs greater than 1'-0" high, place Bars L as shown. Tilt hook as necessary to maintain cover.
- ⑥ Place normal culvert Bars H as shown
- ⑦ Optional Bars L are to be used only for Precast Box Culverts with 3'-0" closure pour.
- ⑧ Quantities shown are per linear foot of curb length assuming T=7". Values in table can be interpolated for intermediate values of curb height, C. Quantity includes Bars K (when applicable) and Bars H shown on the box culvert standards.
- ⑨ Length of Bars V may be adjusted as necessary to maintain clear cover. Omit normal culvert Bars K when using Bars V.

GENERAL NOTES:

Designed according to current AASHTO Standard and Interim Specifications.
 Designed for HS20 loading.
 All reinforcing steel shall be Grade 60.
 All concrete shall be Class "C" and shall have a minimum 28 day compressive strength of 3600 psi.
 All reinforcing bars shall be adjusted to provide 1/4" clear cover.
 These extended curb details have sufficient strength to allow for future retrofit of T6 rail. These details are not suitable for mounting other rail types. For new construction using T6 rail use T6-CM standard.
 The extended curb is considered part of the Box Culvert for payment.
 For vehicle safety the top of curb shall not extend more than 3" above finished grade.

HS20 LOADING

Texas Department of Transportation
Bridge Division

**EXTENDED CURB DETAILS
FOR BOX CULVERTS WITH
CURBS FROM 1'-0" TO 5'-0"**

ECD

RECORD DRAWINGS
These record drawings have been prepared using information provided by the Construction Contractor and/or Owner. The seal and signature below only signifies that the plans have been revised in accordance with the information provided and does not guarantee that these plans accurately show every detail of the constructed project.
Vanessa Jimin
Date 4-2-02

FILE: ecdstdel.dgn	DW: GAF	CK: ARC	DW: TxDOT	CK: GAF
© TxDOT September 2000	DISTRICT	FEDERAL AID PROJECT		SHEET
REVISIONS	COUNTY	CONTROL	SECT	JOB HIGHWAY
				60