

LEGEND

- • • • VERTICAL PANELS
- TYPE III BARRICADE
- ➔ TRAFFIC FLOW

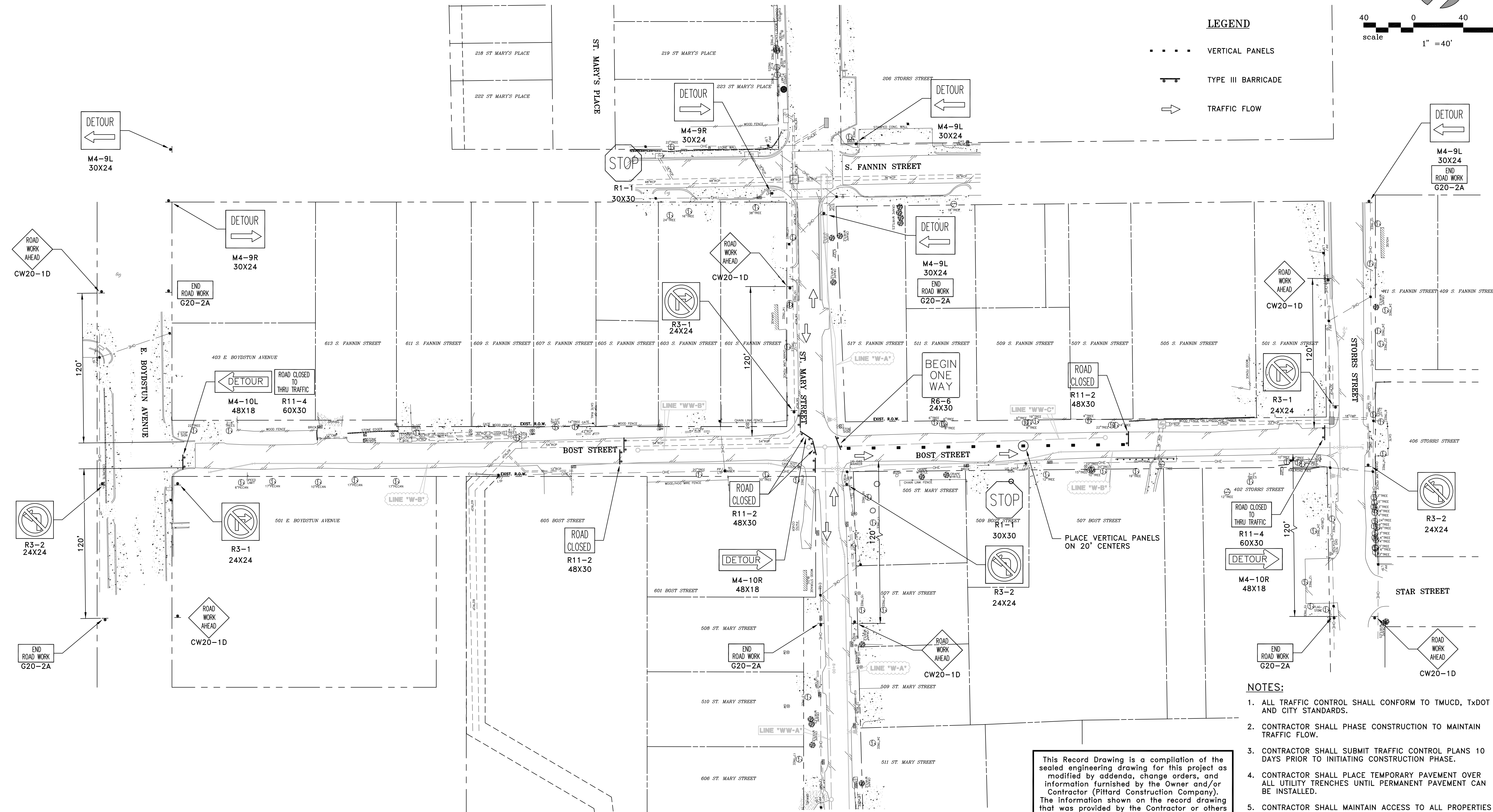

NOTES:

1. ALL TRAFFIC CONTROL SHALL CONFORM TO TMUCD, TxDOT AND CITY STANDARDS.
2. CONTRACTOR SHALL PHASE CONSTRUCTION TO MAINTAIN TRAFFIC FLOW.
3. CONTRACTOR SHALL SUBMIT TRAFFIC CONTROL PLANS 10 DAYS PRIOR TO INITIATING CONSTRUCTION PHASE.
4. CONTRACTOR SHALL PLACE TEMPORARY PAVEMENT OVER ALL UTILITY TRENCHES UNTIL PERMANENT PAVEMENT CAN BE INSTALLED.
5. CONTRACTOR SHALL MAINTAIN ACCESS TO ALL PROPERTIES AT ALL TIMES DURING CONSTRUCTION.

This Record Drawing is a compilation of the sealed engineering drawing for this project as modified by addenda, change orders, and information furnished by the Owner and/or Contractor (Pittard Construction Company). The information shown on the record drawing that was provided by the Contractor or others not associated with the Engineer, cannot be verified for accuracy or completeness. The original sealed engineering drawings are on file at the office of:
 BW2 Engineers, Inc.
 1919 S. Shiloh Road, Suite 500
 Garland, Texas 75042
 (972) 864-8200
 RECORD DRAWINGS PREPARED ON:
 06/01/20

PHASE 3B

NO.	DATE	REVISION	REVIEWED
6			
5			
4			
3			
2			
1			

DRAWN: _____ BW2
 DESIGN: _____ JFW
 REVIEWED: _____ MRB
 SCALE: _____ 1" = 40'
 DATE: _____ OCTOBER 2019
 DWG. NAME: _____ 1933TRAFCONT08

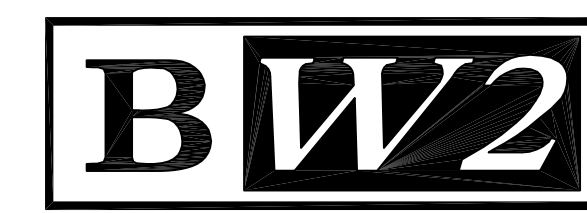

BW2 ENGINEERS, INC.
 1919 S. Shiloh Road
 Suite 500, L.B. 27
 Garland, Texas 75042
 (972) 864-8200 (T) (972) 864-8220 (F)
 Firm Registration No. F-5290

THE SEAL THAT ORIGINALLY APPEARED ON THIS DOCUMENT WAS AUTHORIZED BY MICHAEL R. BURGE, TEXAS P.E. 41290 ON 10/11/19. ALTERATION OF A SEALED DOCUMENT WITHOUT PROPER NOTIFICATION OF THE RESPONSIBLE ENGINEER IS AN OFFENSE UNDER THE TEXAS ENGINEERING PRACTICE ACT.

WATER LINE AND WASTEWATER LINE REPLACEMENT PROJECT
 (ST. MARY STREET, BOST STREET, AND SHERMAN STREET)
 SUGGESTED TCP PHASE 3A
CITY OF ROCKWALL

SHEET NO. 25
 OF 29 SHEETS
 JOB NO. 19-1933