

N 7020853.3267  
E 2602920.6047  
STA. 0+20.00  
FURNISH & INSTALL:  
1-30"x8" TAPPING SLEEVE & VALVE  
W/ LOCKING LID (BASS & HAYS #2436 SVB  
& 1824S LID 4)  
20 L.F. 8" P.V.C. FORCE MAIN

N 7020834.0935  
E 2602926.5504  
STA. 0+40.13  
FURNISH & INSTALL:  
1-4" DIA. TYPE "S" MANHOLE

N 7020867.8663  
E 2603035.7995

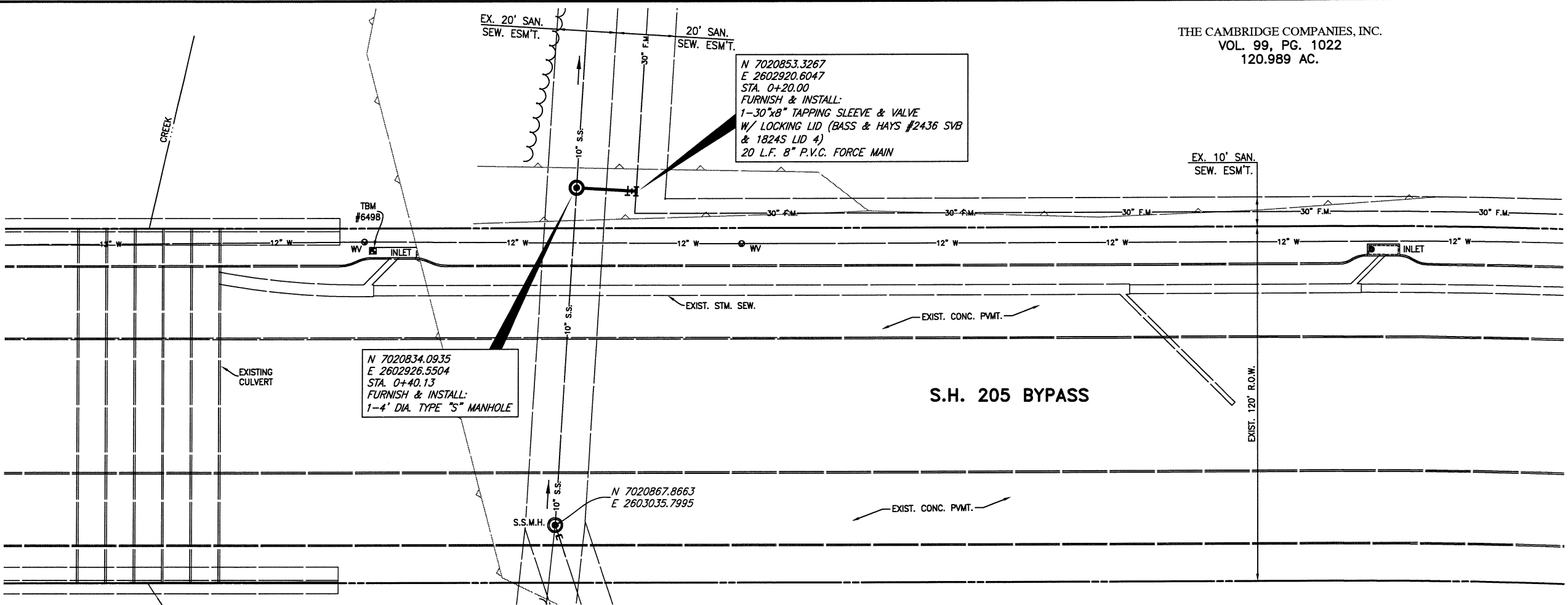

TBM 6498  
INLET LID WEST SIDE OF  
S.H. 205 & NORTH OF  
BUFFALO CREEK  
N 7020776.9884  
E 2602970.9561  
ELEV. 546.89

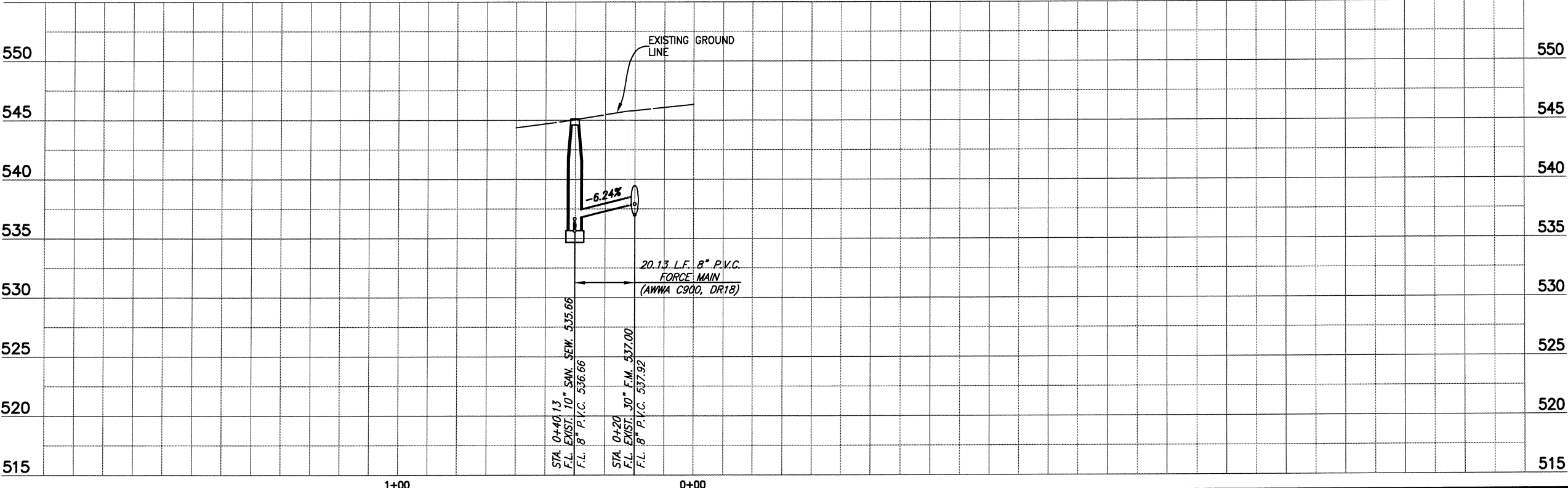

This record drawing is a compilation of the sealed engineering drawing for this project; modified by addenda, change orders and information furnished by the contractor. The information shown on the record drawings that was provided by the contractor or others not associated with the design engineer cannot be verified for accuracy or completeness. This original sealed drawings are on file at the offices of Birkhoff, Hendricks & Carter, L.L.P.  
BY PAC DATE 03/06/12

These plans and related specifications were prepared for construction of this specific project only. Reuse of these documents is not permitted without written authorization of Birkhoff, Hendricks, & Carter, L.L.P.

**BIRKHOFF, HENDRICKS & CARTER, L.L.P.**  
PROFESSIONAL ENGINEERS  
Texas Firm F526  
11910 Greenville Ave., Suite 600  
Dallas, Texas 75243 (214) 361-7900

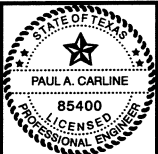

*[Signature]*  
5/28/10

**CITY OF ROCKWALL, TEXAS**  
SQUABBLE CREEK LIFT STATION  
TEMPORARY FORCE MAIN TIE-IN  
PLAN-PROFILE

BHC  
PROJECT NO.  
2007-110  
MAY 2010

SHEET NO.  
**11**