

Rockwall Y.M.C.A.
Vol. 152, Pg. 77

Caruth Lake Phase I
Cab. C, Pg. 205

SANITARY SEWER
CURVE DATA
 $\Delta = 22'00''17''$
 $R = 1097.5'$
 $T = 213.38'$
 $L = 421.50'$

Robert S. Whittle
Vol. 694, Pg. 47

S.S. McCurry Survey
Abstract No. 146

MATCH LINE STA. 00+42.76

**FURNISH & INSTALL
18" SANITARY SEWER**

STA. 44+16.67
CONSTRUCT STD. 5" DIA.
INSIDE DROP MANHOLE
CONNECT TO EXIST. 8" SAN. SEW.
CUT, PLUG AND ABANDON 8" NORTH
N 7895.1906
E 13122.4970

EXIST. 15" SAN. SEW.
TO REMAIN IN SERVICE

STA. 44+99.99
CONSTRUCT STD. 5" DIA. MANHOLE
OVER EXIST. 15" SAN. SEW.
CONNECT TO EXIST. SAN. SEW.
N 7974.4442
E 13203.1703

PROPOSED TEMP. CONST.
EASEMENT

**FURNISH & INSTALL
24" SANITARY SEWER**

P.I. STA. 48+66.82
 $\Delta = 90'00''00''$ RT.
CONST. STD. 5" DIA. MANHOLE
N 7838.0638
E 13342.6326

P.T. STA. 46+13.39
N 7833.3862
E 13317.4650

EXISTING 40'
SANITARY SEWER
EASEMENT

STA. 48+93.46
CONNECT TO EXIST. MANHOLE
END THIS PROJECT
N 7812.7833
E 13531.9327

PROP. 50' LONE STAR GAS EASEMENT

CARUTH LANE

Caruth Lake Phase II
Cab. C, Pg. 244

Caruth Lake Ph.III
Cab. C, Pg. 205

Caruth Lake Phase IV

WHISPERING GLEN

MORNING STAR

BENCHMARK: T.B.M. S-4 "X" CUT ON TOP OF EXISTING CONC.
RIGHT-OF-WAY MARKER AT THE
NORTHWEST INTERSECTION OF HWY. 205
AND DICKSON LANE.
ELEV. 477.41

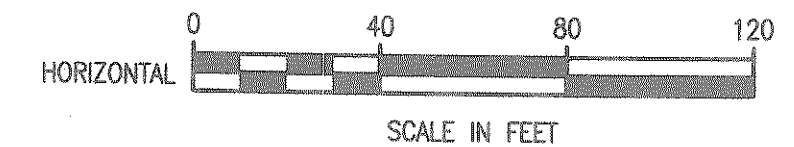

These plans and related specifications were prepared for construction of this specific project only. Reuse of these documents is not permitted without written authorization of Shimek, Jacobs & Finklea, L.L.P.

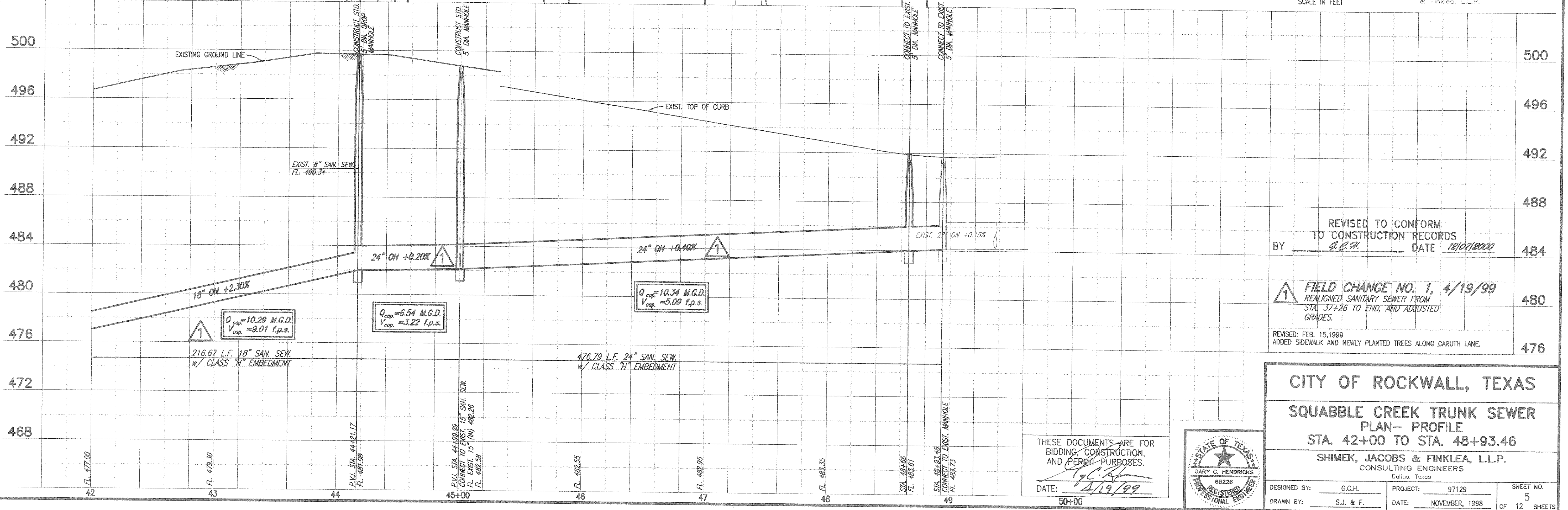

REVISED TO CONFORM
TO CONSTRUCTION RECORDS
BY G.C.F. DATE 12/07/2000

FIELD CHANGE NO. 1, 4/19/99
REALIGNED SANITARY SEWER FROM
STA. 37+26 TO END, AND ADJUSTED
GRADES.

REVISED: FEB. 15, 1999
ADDED SIDEWALK AND NEWLY PLANTED TREES ALONG CARUTH LANE.

CITY OF ROCKWALL, TEXAS
SQUABBLE CREEK TRUNK SEWER
PLAN- PROFILE
STA. 42+00 TO STA. 48+93.46

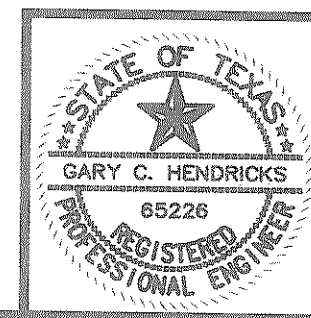

THESE DOCUMENTS ARE FOR
BIDDING, CONSTRUCTION,
AND PERMIT PURPOSES.
DATE: 4/19/99

DESIGNED BY: G.C.H. PROJECT: 97129 SHEET NO. 5
DRAWN BY: S.J. & F. DATE: NOVEMBER, 1998 OF 12 SHEETS

97129-05.DWG 4/20/99 K4B BLOCKS PROF-05