

These plans and related specifications were prepared for construction of this specific project only. Reuse of these documents is not permitted without written authorization of Birkhoff, Hendricks, & Conway, L.L.P.

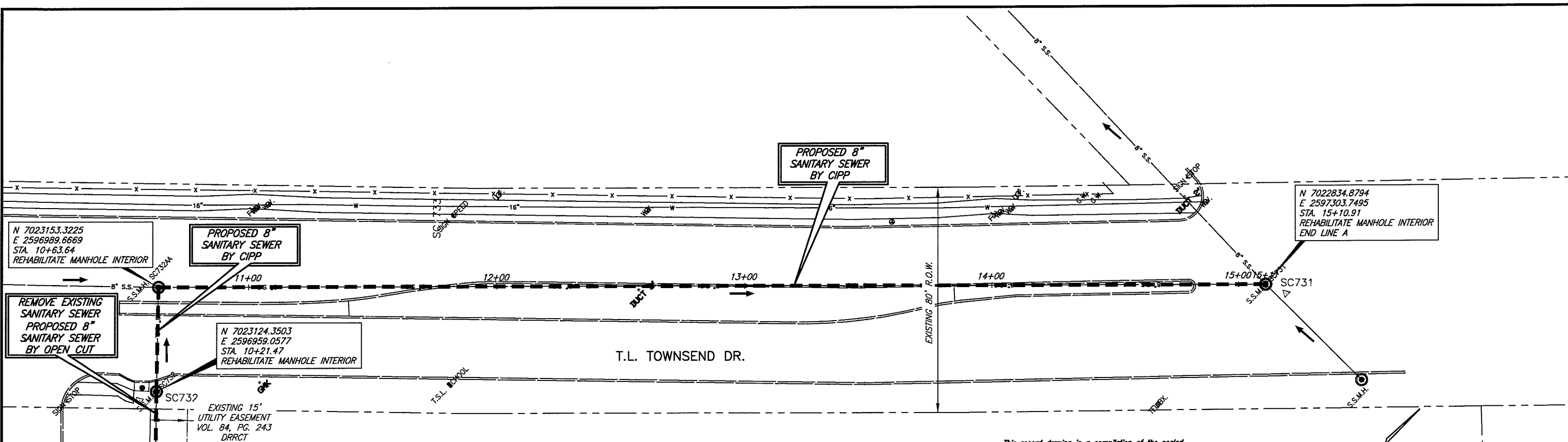

MATCH LINE STA. 10+00  
N 7023109.4507, E 2596943.6046

B.R. & R.B. CAMERON  
VOL. 108, PG. 837  
DRRCT

This record drawing is a compilation of the sealed engineering drawing for this project, modified by addenda, change orders and information furnished by the contractor. The information shown on the record drawings that was provided by the contractor or others not associated with the design engineer cannot be verified for accuracy or completeness. This original sealed drawings are on file at the offices of Birkhoff, Hendricks & Conway, L.L.P.  
BY P.A.C. DATE 10/14/09

HORIZONTAL SCALE IN FEET

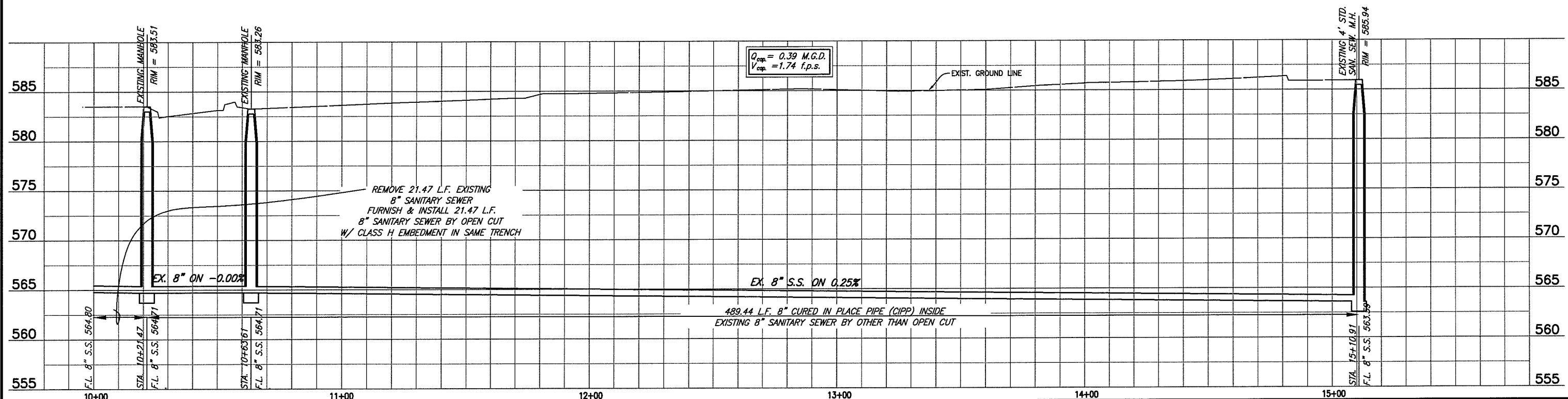

<b>BIRKHOFF, HENDRICKS &amp; CONWAY, L.L.P.</b> CONSULTING ENGINEERS 11910 Greenville Ave., Suite 600 Dallas, Texas (214) 361-7900			<b>CITY OF ROCKWALL, TEXAS</b> SQUABBLE CREEK INTERCEPTOR, PHASE II REHABILITATION	BHC PROJECT NO. 2008-130	SHEET NO. <b>5</b>
			<b>SQUABBLE CREEK SANITARY SEWER LINE          PLAN AND PROFILE          STA 10+00 TO STA. 15+11 (LINE A)</b>	February, 2009	