

CONSTRUCTION PLANS

FOR

SQUABBLE CREEK REHABILITATION

IN THE

CITY OF ROCKWALL, ROCKWALL COUNTY, TEXAS

ESTIMATED CONSTRUCTION START DATE: MAY 2019

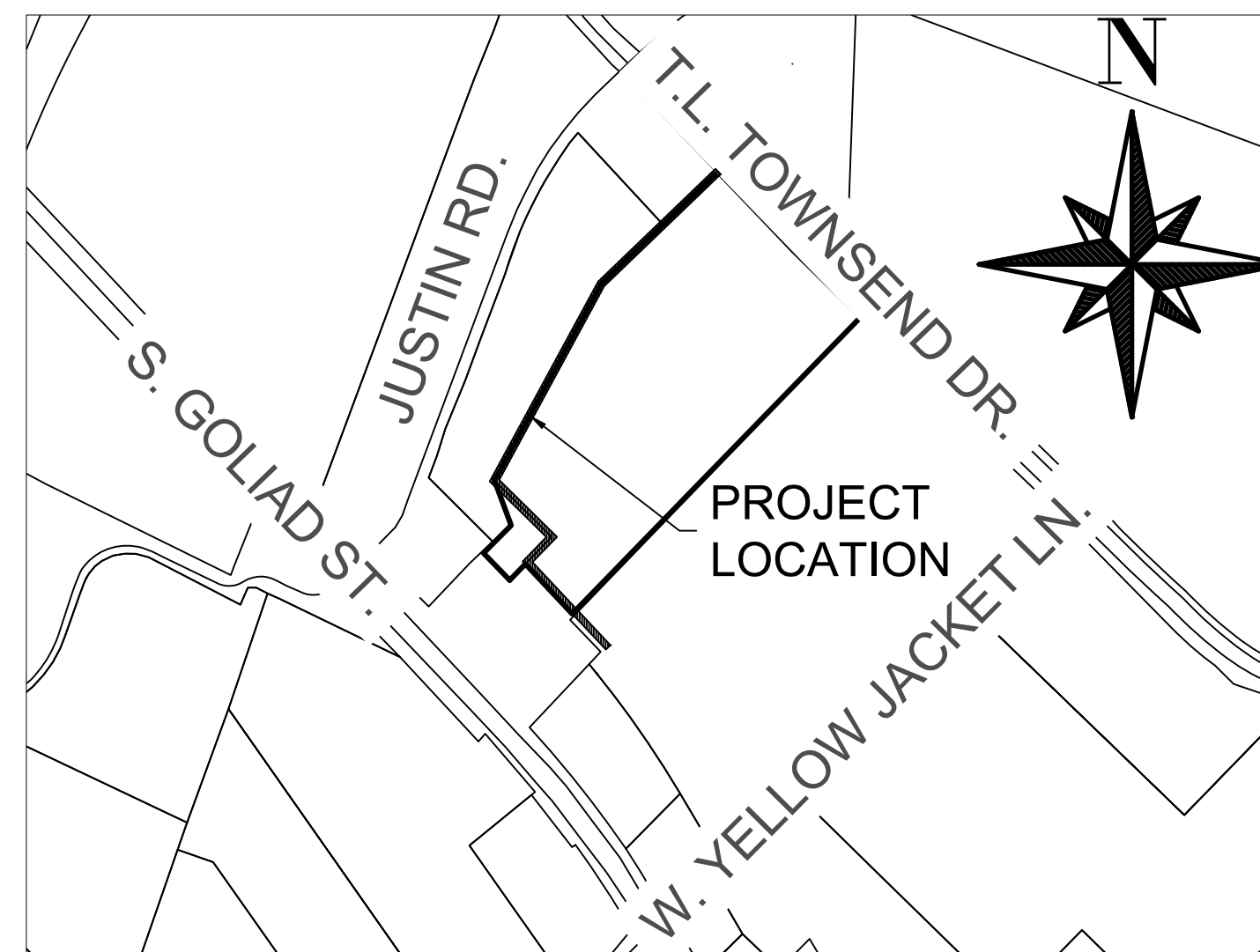

LOCATION MAP
N.T.S.

Sheet List Table	
Sheet Number	Sheet Title
C.01	COVER SHEET
C.02	GENERAL NOTES
C.03	EXISTING CONDITIONS & DEMOLITION
C.04	SS LINE 'A' PLAN & PROFILE (SHEET 1 OF 3)
C.05	SS LINE 'A' PLAN & PROFILE (SHEET 2 OF 3)
C.06	SS LINE 'A' PLAN & PROFILE (SHEET 3 OF 3)
C.07	EROSION CONTROL PLAN
C.08	SANITARY SEWER DETAILS

PLOTTED: 5/24/2019 10:44:57 AM

MAY 2019

P:\PR57307\CaddModels\Civil\IG-COVR01.dwg 5/24/2019 10:38:07 AM Mulvey, Kyle

JOB No. 57307

SQUABBLE CREEK REHABILITATION

NO.	REVISIONS	DATE	BY	CHK.

Burgess & Niple, Inc. Stafford, TX

CIVIL ENGINEER:
BURGESS & NIPLE
 10701 CORPORATE DRIVE, SUITE 118
 STAFFORD, TX 77477
 PHONE: (281)980-7705
 TBPE FIRM REGISTRATION NO. F-10834
 CONTACT: JOSEPH T. REUE

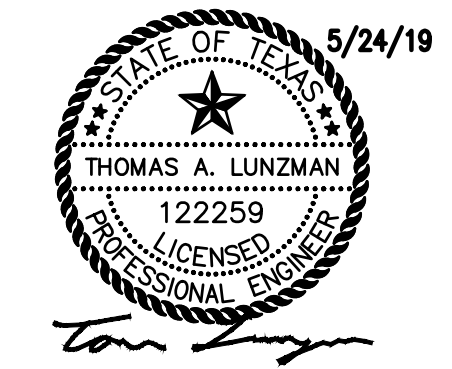

"ALL RESPONSIBILITY FOR ADEQUACY OF DESIGN REMAINS WITH THE DESIGN ENGINEER. THE CITY OF ROCKWALL, IN REVIEWING AND RELEASING PLANS FOR CONSTRUCTION, ASSUMES NO RESPONSIBILITY FOR ADEQUACY OR ACCURACY OF DESIGN."