

LEGEND

PROPOSED TREE REMOVAL

NOTE:
CONTRACTOR SHALL PROTECT EXISTING WALK DURING CONSTRUCTION OF PROPOSED SANITARY SEWER LINE

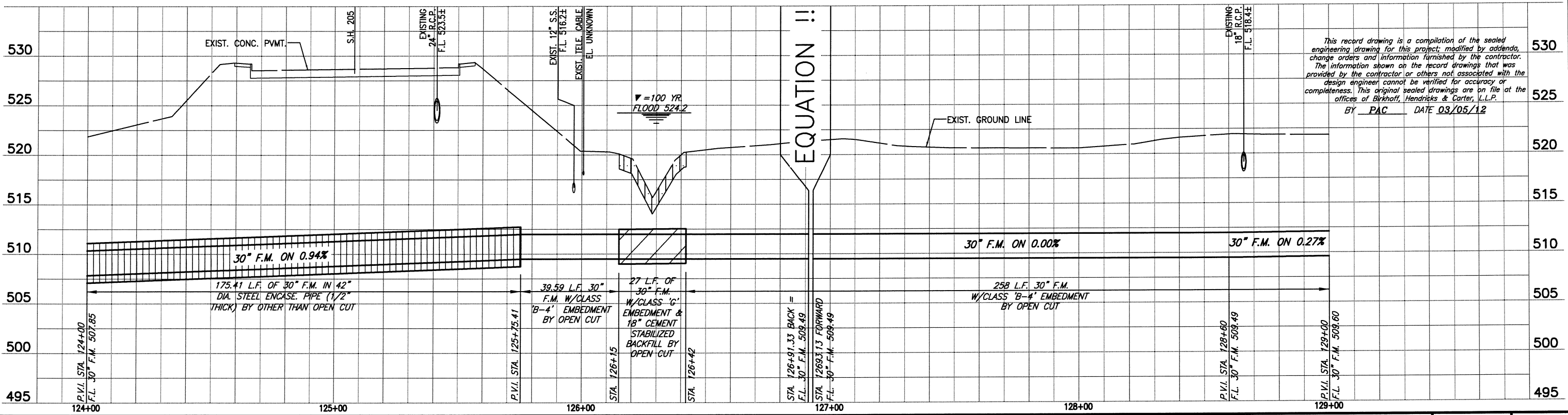

This record drawing is a compilation of the sealed engineering drawing for this project, modified by addenda, change orders and information furnished by the contractor. The information shown on the record drawings that was provided by the contractor or others not associated with the design engineer cannot be verified for accuracy or completeness. This original sealed drawings are on file at the offices of Birkhoff, Hendricks & Carter, L.L.P.
BY PAC DATE 03/05/12

BIRKHOFF, HENDRICKS & CARTER, L.L.P. PROFESSIONAL ENGINEERS Texas Firm F526 11910 Greenville Ave., Suite 600 Dallas, Texas (214) 361-7900			CITY OF ROCKWALL, TEXAS SQUABBLE CREEK FORCE MAIN PLAN AND PROFILE STA. 124+00 TO STA. 129+00	BHC PROJECT NO. 2007-110 May, 2011	SHEET NO. 12
--	--	--	--	---	----------------------------

These plans and related specifications were prepared for construction of this specific project only. Reuse of these documents is not permitted without written authorization of Birkhoff, Hendricks & Carter, L.L.P.