

These plans and related specifications were prepared for construction of this specific project only. Reuse of these documents is not permitted without written authorization of Birkhoff, Hendricks, & Conway, L.L.P.

MATCH LINE STA. 35+00  
N 7035699.1102, E 2599419.3609

MATCH LINE STA. 40+00  
N 7036198.8108, E 2599403.8328

S.H. 205 BYPASS  
(NORTH BOUND)

FURNISH & INSTALL:  
12-INCH WATERLINE

N 7036031.4066  
E 2599405.4355  
P.I. STA. 38+33.56  
Δ = 01°51'04" RT.  
PULL PIPE

N 7036118.8145  
E 2599404.5986  
STA. 39+20  
FURNISH & INSTALL:  
1-12"x6" TEE  
1-6" GATE VALVE  
1-12" GATE VALVE  
6 L.F. 6" WATERLINE  
1-FIRE HYDRANT

N 7035719.0926  
E 2599418.5235  
STA. 35+20  
FURNISH & INSTALL:  
1-12"x6" TEE (UP)  
1-12" 90° BEND  
1-6" GATE VALVE  
6 L.F. 6" WATERLINE  
1-FIRE HYDRANT

**LEGEND**

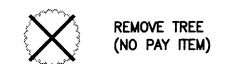

**CAUTION!!**  
MT. ZION WSC WATERLINE IN AREA.  
CONTACT DWIGHT LINDOP AT  
972-670-9091 FOR LOCATES PRIOR  
TO EXCAVATING IN THIS AREA.

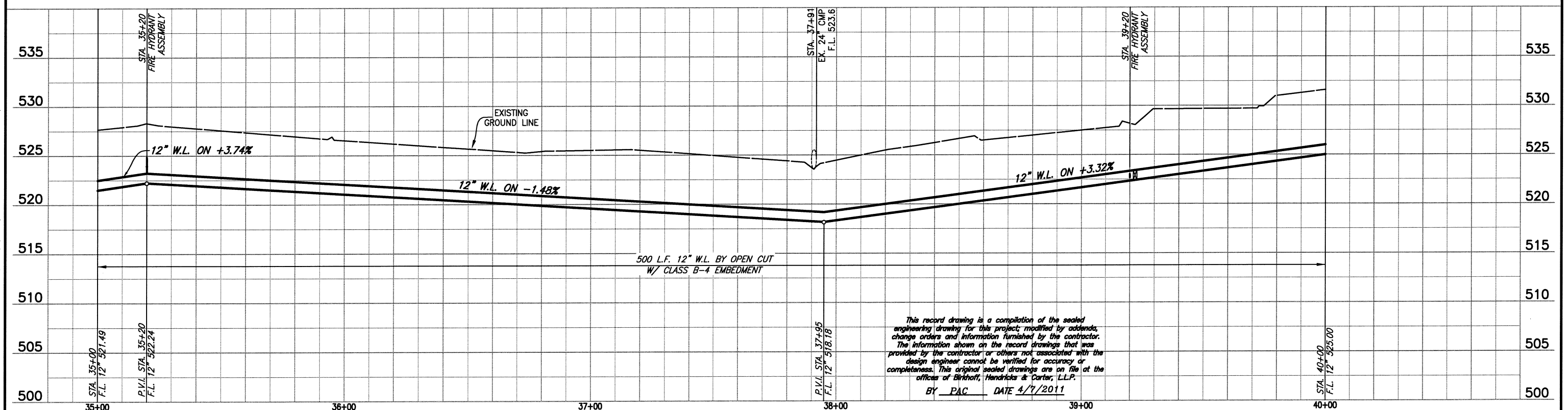
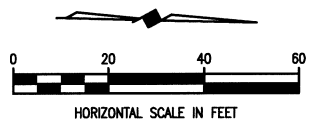

This record drawing is a compilation of the sealed engineering drawing for this project, modified by addenda, change orders and information furnished by the contractor. The information shown on the record drawings that was provided by the contractor or others not associated with the design engineer cannot be verified for accuracy or completeness. This original sealed drawings are on file at the offices of Birkhoff, Hendricks & Conway, L.L.P.  
BY PAC DATE 4/7/2011

FIELD CHANGE NO. 1 - NOVEMBER 17, 2009

**BIRKHOFF, HENDRICKS & CONWAY, L.L.P.**  
PROFESSIONAL ENGINEERS  
Texas Firm F526  
11910 Greenville Ave., Suite 600  
Dallas, Texas (214) 361-7900

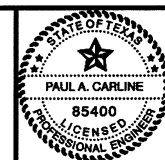

*Paul A. Garline*  
PA/G

**CITY OF ROCKWALL, TEXAS**  
QUAIL RUN WATER LINE  
PLAN-PROFILE STA. 35+00 TO STA. 40+00

BHC PROJECT NO. 2007-129	SHEET NO. 27
April 2011	