

RECORD DRAWING
 THE SEAL THAT ORIGINALLY APPEARED ON THIS DOCUMENT WAS AUTHORIZED BY THE BOARD OF SURVEYORS, TEXAS NO. 82775 ON 10-1-09. THESE RECORD DRAWINGS WERE PREPARED BASED UPON AS CONSTRUCTED DRAWINGS PROVIDED BY THE CONTRACTOR WHOSE DEVIATIONS FROM THE APPROVED CONSTRUCTION DRAWINGS WERE INCLUDED ON APRIL 18, 2011.

CITY OF ROCKWALL
 SHADY DALE LANE
 DRAINAGE AREA MAP



NO.	REVISION	DATE	BY	DESIGN: CRH / TBS	CHECKED: PBS&J	APPROVED: PBS&J

DATE: SEPTEMBER 2009
 FILE: \$FILES\$
 SHEET
 SD D 1
 8 OF 20

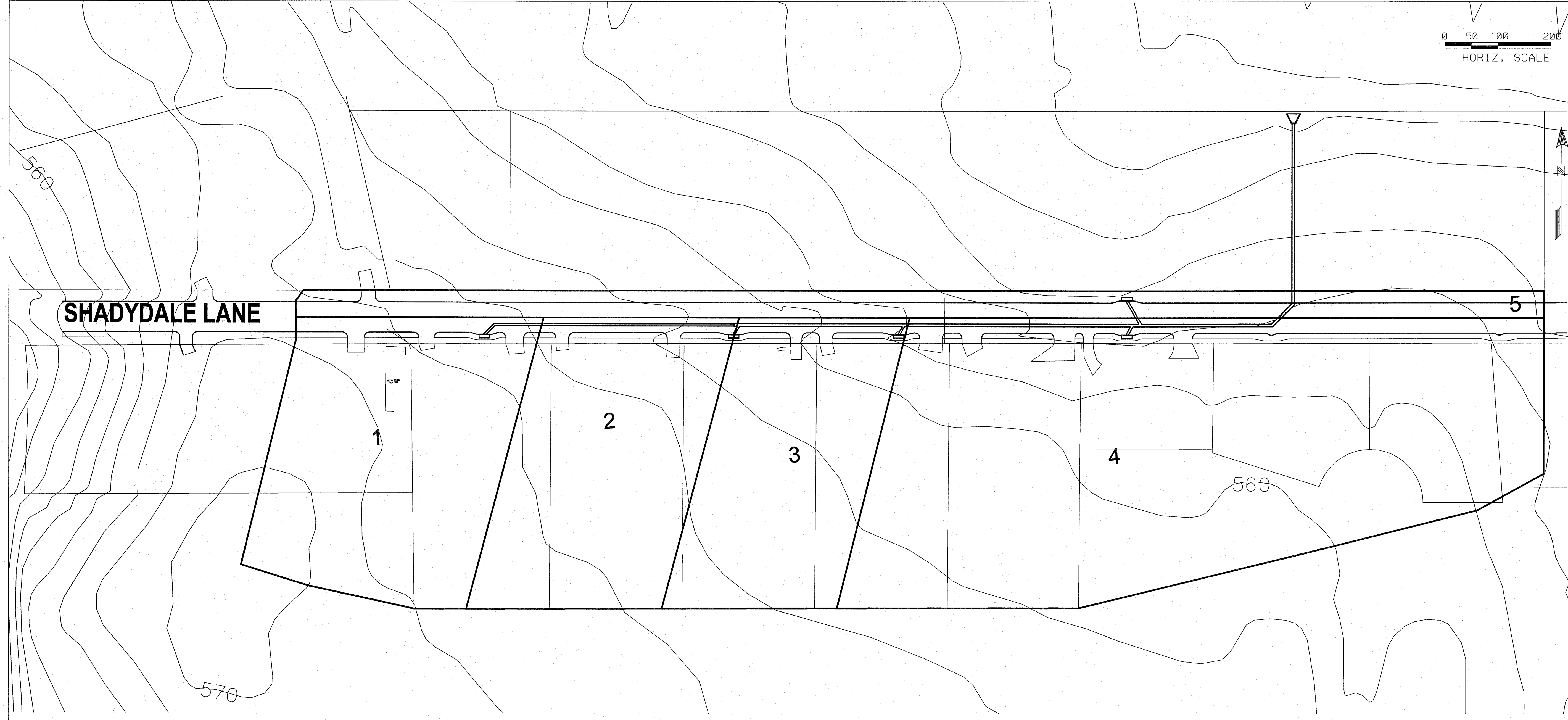

AREA	C	I	A	Q100
1	0.5	9.8	2.40	11.76
2	0.5	9.8	1.16	5.68
3	0.5	9.8	1.03	5.05
4	0.5	9.8	3.37	16.51
5	0.5	9.8	0.68	3.33

UPSTREAM STATION (ft)	DOWNSTREAM STATION (ft)	UPSTREAM FLOWLINE (ft)	DOWNSTREAM FLOWLINE (ft)	RUN DISTANCE (ft)	INPUT SOURCE AT US STA	INPUT TC (min)	RUNOFF COEFF. (c)	INPUT AREA (ac)	INC C*A @ US STA	CUMULATIVE C*A	TC UPSTREAM (min)	INTENSITY (in/hr)	Q (cfs)	PIPE SIZE (in)	PIPE SLOPE (ft/ft)	FULL FLOW VELOCITY (fps)	FULL FLOW CAPACITY (cfs)	PARTIAL DEPTH (ft)	PARTIAL DEPTH VELOCITY (fps)	SLOPE HGL (ft/ft)	HGL VELOCITY (fps)	HGL HEAD LOSS (ft)	HGL VELOCITY LOSS (ft)	HEAD LOSS COEFF. (K)	Kj HEAD LOSS (ft)	FLOW TIME (min)	DOWNSTREAM TC (min)	HGL UPSTREAM (ft)	HGL DOWNSTREAM (ft)					
LINE A																																		
956.36	942.92	560.79	560.53	13.4	inlet	10	0.5	2.40	1.20	10.00	9.8	11.8	24	0.020	10.21	32.08	0.88	9.64	0.0027	3.74	0.04	0.00	1.25	0.27	0.06	10.06	561.82	PF	561.51	PF				
942.92	712.21	560.53	556.01	225.7	bend	10	0.5	0.00	1.20	10.06	9.8	11.8	24	0.020	10.21	32.08	0.88	9.64	0.0027	3.74	0.01	0.00	0.5	0.11	1.00	11.06	561.41	PF	557.85	PF				
712.21	712.21	555.51	555.41	5.0	size change	10	0.5	1.16	0.58	11.06	9.8	17.4	30	0.020	11.85	58.16	1.76	13.28	0.0018	3.55	0.01	-0.01	1	0.20	0.02	11.09	557.67	PF	557.46	PF				
712.21	556.76	555.41	552.30	155.5	lat	10	0.5	1.03	0.52	2.30	11.09	9.8	22.5	30	0.020	11.85	58.16	1.76	13.28	0.0030	4.58	0.46	0.13	0.5	0.16	0.57	11.65	557.17	PF	555.23	FF			
556.76	452.52	552.30	550.22	104.2	lat	10	0.5	0.00	2.30	11.65	9.8	22.5	30	0.020	11.85	58.16	1.76	13.28	0.0030	4.58	0.31	0.00	0.5	0.16	0.38	12.03	555.07	FF	554.59	FF				
452.52	341.54	550.22	548.55	111.0	PVI	10	0.5	0.00	2.30	12.03	9.8	22.5	30	0.015	10.26	50.37	1.76	11.50	0.0030	4.58	0.33	0.00	0.00	0.00	0.40	12.44	554.59	FF	554.26	FF				
341.54	333.46	548.55	548.43	8.1	lat	10	0.5	3.37	1.69	3.98	12.44	9.8	39.0	30	0.015	10.26	50.37	1.76	11.50	0.0090	7.95	0.07	0.65	0.6	0.59	0.02	12.45	553.02	FF	552.36	FF			
333.46	210.17	548.43	546.58	123.3	lat	10	0.5	0.68	0.34	4.32	12.45	9.8	42.3	30	0.015	10.26	50.37	1.76	11.50	0.0106	8.62	1.31	0.17	0.4	0.46	0.24	12.69	551.72	FF	549.95	FF			
210.17	181.88	546.58	546.16	28.3	bend	10	0.5	0.00	4.32	12.69	9.8	42.3	30	0.015	10.26	50.37	1.76	11.50	0.0106	8.62	0.30	0.00	0.5	0.58	0.05	12.75	549.37	FF	548.50	FF				
181.88	11.36	546.16	543.6	170.5	bend	10	0.5	0.00	4.32	12.75	9.8	42.3	30	0.015	10.26	50.37	1.76	11.50	0.0106	8.62	1.81	0.00	0.5	0.58	0.33	13.08	547.92	PF	545.36	PF				
LAT A-1	27.14	0	550.53	548.68	27.1	inlet	10	0.5	0.68	0.34	0.34	10.00	9.8	3.3	24	0.068	18.85	59.22	1.06	19.31	0.0002	1.06	0.01	-0.57	1.25	0.02	0.43	10.43	551.75	PF	551.72	FF		
LAT A-2	10.97	0	550.53	548.8	11.0	inlet	10	0.5	3.37	1.69	1.69	10.00	9.8	16.5	24	0.158	28.67	90.08	1.06	29.37	0.0053	5.26	0.06	0.41	1.25	0.54	0.03	10.03	553.61	FF	553.02	FF		
LAT A-3	10.97	0	553.30	552.81	11.0	inlet	10	0.5	1.03	0.52	0.52	10.00	9.8	5.0	24	0.045	15.26	47.94	1.06	15.63	0.0005	1.61	0.01	0.04	1.25	0.05	0.11	10.11	557.23	FF	557.17	FF		
LAT A-4	10.97	0	556.30	555.91	11.0	inlet	10	0.5	1.16	0.58	0.58	10.00	9.8	5.7	24	0.036	13.61	42.77	1.06	13.94	0.0006	1.81	0.01	0.05	1.25	0.06	0.10	10.10	557.74	PF	557.67	FF		

STIMES
 \$\$\$SYTIME\$\$\$\$\$
 \$\$\$SYTIME\$\$\$\$\$