

WATER #4  
DELETED

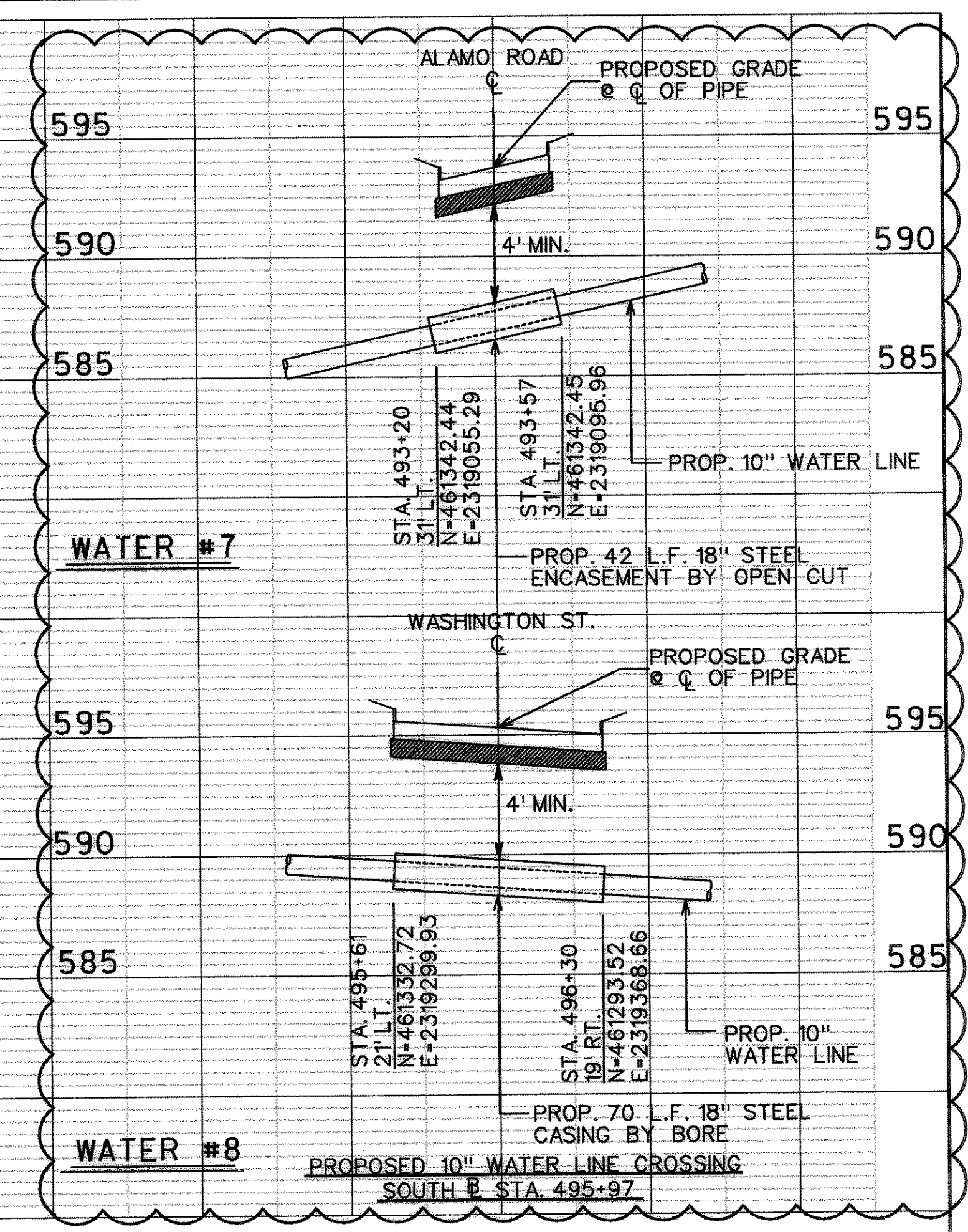

**UNDERGROUND UTILITIES**  
THE LOCATION OF EXISTING UTILITIES SHOWN ON THESE PLANS ARE APPROXIMATE AND BASED ON DATA FURNISHED BY UTILITY COMPANIES. IT IS THE RESPONSIBILITY OF THE CONTRACTOR TO LOCATE AND VERIFY ON-SITE THE UTILITIES THAT MAY CONFLICT WITH THE CONSTRUCTION.

RECORD DRAWING  
These record drawings were prepared using information provided by the Contractor and/or Owner. The Engineer is not responsible for information below only signifies that the drawings were revised in accordance with the contract and does not guarantee the accuracy of the drawings. The Contractor shall be responsible to show every change.

STATE OF TEXAS  
TED B. SUGG  
82775  
REGISTERED PROFESSIONAL ENGINEER

*Ted Sugg* - 12-10-02  
Date

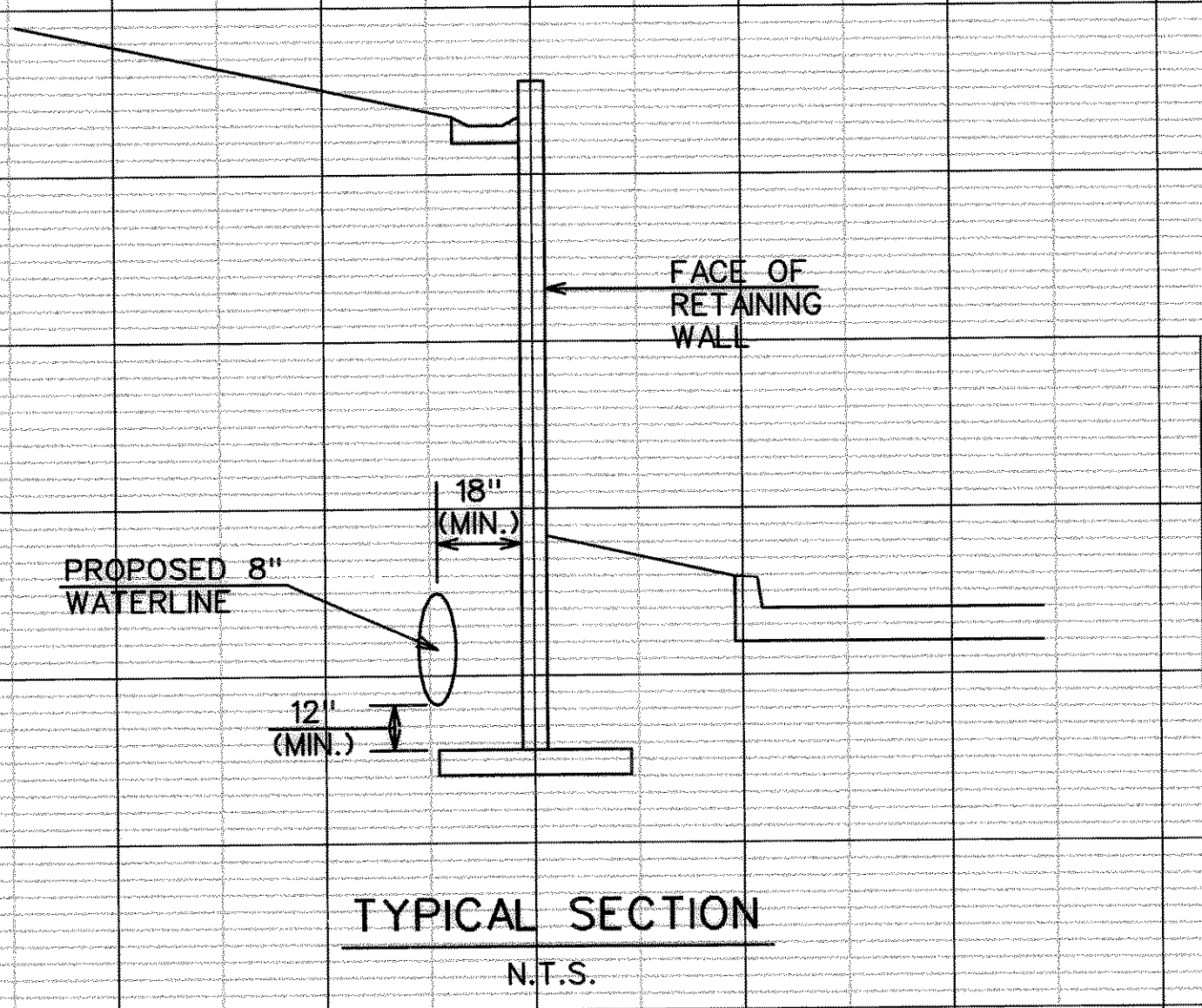
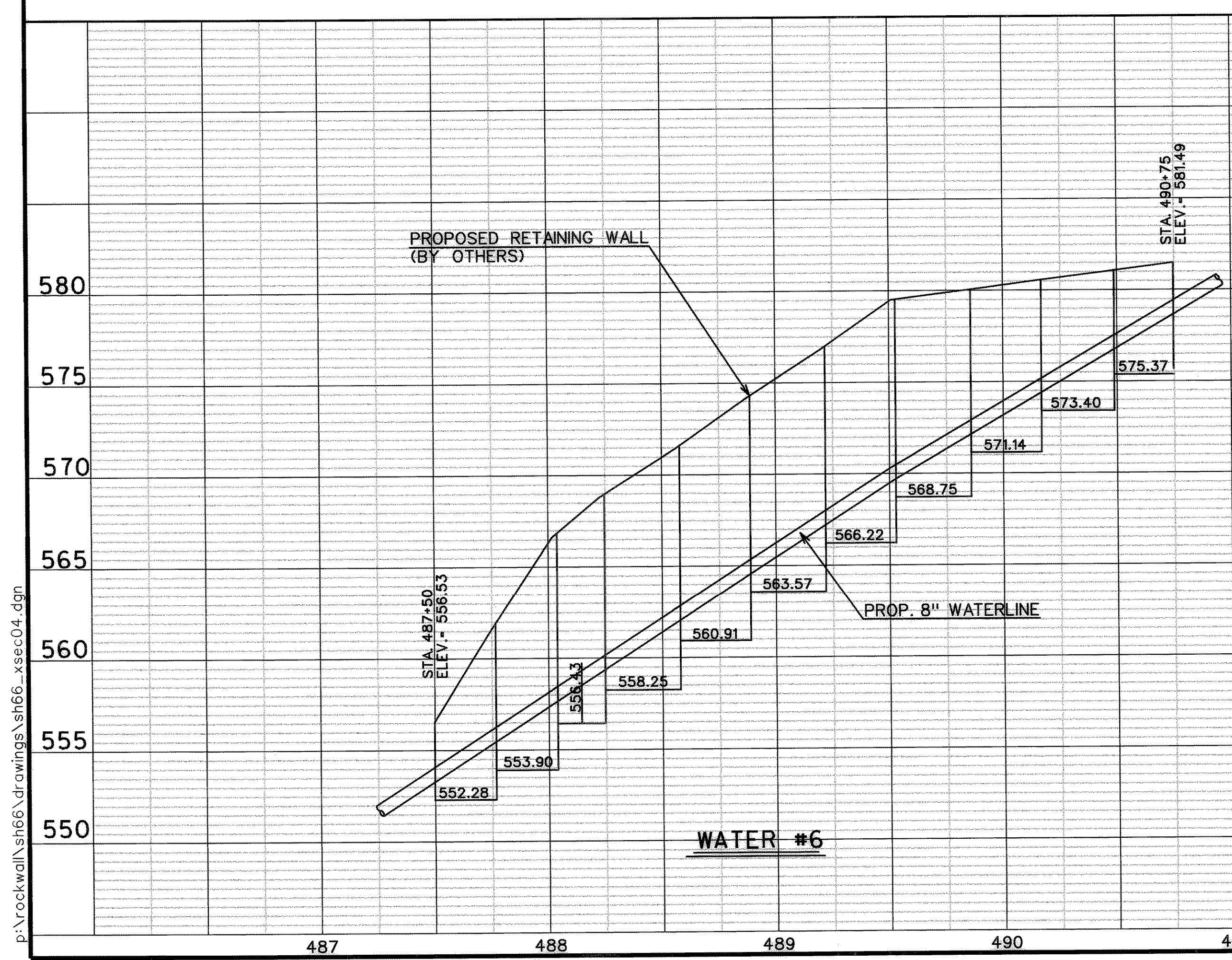

STATE OF TEXAS  
VORANIQUE V. SIMON  
86381  
REGISTERED PROFESSIONAL ENGINEER

*V. Simon* 02-3-01

REVISED	1	11/6	ADDED N. & E.
REVISED	2	12/3	WATER #5, #6 DELETED WATER #7, #8 ADDED

**CITY OF ROCKWALL**  
"THE NEW HORIZON"

S.H. 66  
UTILITY RELOCATIONS

WATER PROFILES

**Turner Collie & Braden Inc.**  
ENGINEERS • PLANNERS • PROJECT MANAGERS

Unit	A123	Scale: Horz. 1"=40' Vert. 1"=5'	Date	APRIL, 2001
Designed	VVS	Checked	TBS	Job No. 15-98925-300
Drawn	GBA	Approved	RCR	SHEET 13 OF 19

p:\rockwall\sh66\drawings\sh66\_xsec04.dgn