

S. KING SURVEY  
ABSTRACT NO. 131  
**GRANVILLE DAVIS**

S. KING SURVEY  
ABSTRACT NO. 131  
**DEWOODY ADDITION**

S. KING SURVEY  
ABSTRACT NO. 131  
**OWNER**

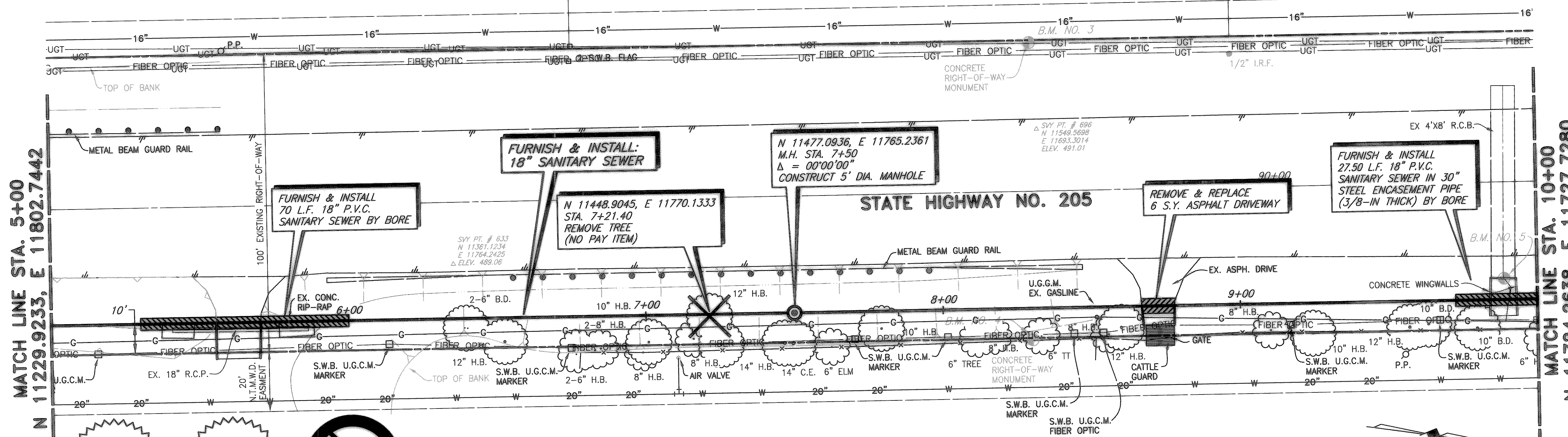

**WARNING**  
S.W. BELL BURIED  
TELEPHONE CABLE  
CALL ENTERPRISE 9800  
72 HOURS PRIOR TO  
EXCAVATION

**WARNING**  
T.X.U. GAS LINE  
NOTIFY T.X.U. GAS  
72 HOURS PRIOR TO  
EXCAVATION



ESTATE OF  
**W.W. CARUTH, JR.**  
W.T. DEWEESE SURVEY  
ABSTRACT NO. 71

B.M. NO. 3  
N 11543.1488, E 11664.9287  
STA. 8+30.36, 89.26' LT.  
CONCRETE RIGHT-OF-WAY MONUMENT  
ELEV. 486.42'

B.M. NO. 4  
N 11557.8685, E 11763.6711  
STA. 8+30.10, 10.57' RT.  
CONCRETE RIGHT-OF-WAY MONUMENT  
ELEV. 492.22

B.M. NO. 5  
N 11712.2121, E 11722.3641  
STA. 9+88.89, 7.11' RT.  
CUT TOP OF HEADWALL ON  
NORTHWEST SIDE OF S.H. 205  
ELEV. 489.23

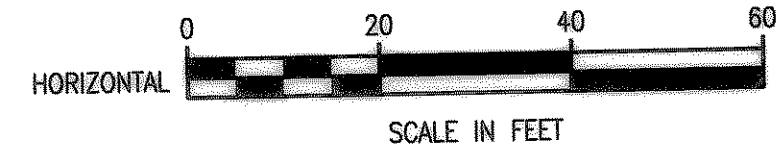

These plans and related specifications were prepared for construction of this specific project only. Reuse of these documents is not permitted without written authorization of Birkhoff, Hendricks, & Conway, L.L.P.



THESE DOCUMENTS ARE FOR  
BIDDING, CONSTRUCTION,  
AND PERMIT PURPOSES.  
DATE: 5/24/02

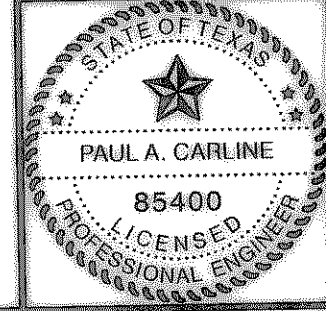

**CITY OF ROCKWALL, TEXAS**

STATE HIGHWAY NO. 205 SANITARY SEWER  
PLAN - PROFILE  
STA. 5+00 TO STA. 10+00

**BIRKHOFF, HENDRICKS & CONWAY, L.L.P.**  
CONSULTING ENGINEERS  
Dallas, Texas

|                     |                  |              |
|---------------------|------------------|--------------|
| DESIGNED BY: P.A.C. | PROJECT: 2000171 | SHEET NO. 2  |
| DRAWN BY: J.P.O.    | DATE: MAY, 2002  | OF 12 SHEETS |

Revised: 05/20/2002 KAB H:\Projects\Rockwall\2000171\Plans\Sheets\2000171-502.dwg Master Profile