

CURVE REPORT

CURVE	RADIUS	DELTA	TANGENT	LENGTH	CHORD	BEARING
C-1	715.00'	06°01'45"	37.65'	75.24'	75.20'	S84°47'27"W
C-2	715.00'	06°01'43"	37.65'	75.23'	75.20'	N84°47'25"E
C-3	715.00'	06°01'43"	37.65'	75.23'	75.20'	S86°49'15"E
C-4	715.00'	06°01'45"	37.65'	75.24'	75.20'	N86°49'17"W

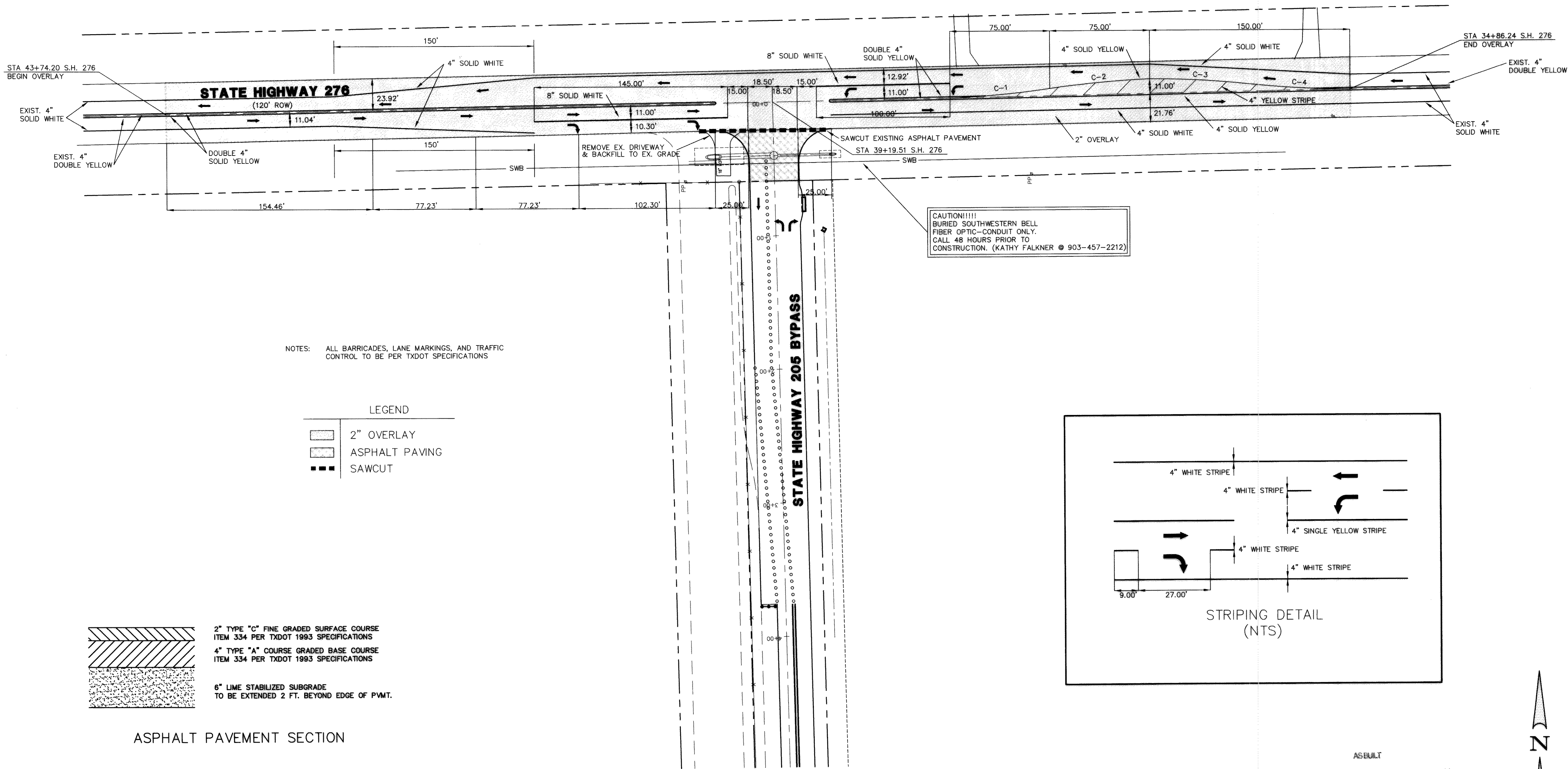

NOTES: ALL BARRICADES, LANE MARKINGS, AND TRAFFIC CONTROL TO BE PER TxDOT SPECIFICATIONS

LEGEND

	2" OVERLAY
	ASPHALT PAVING
	SAWCUT

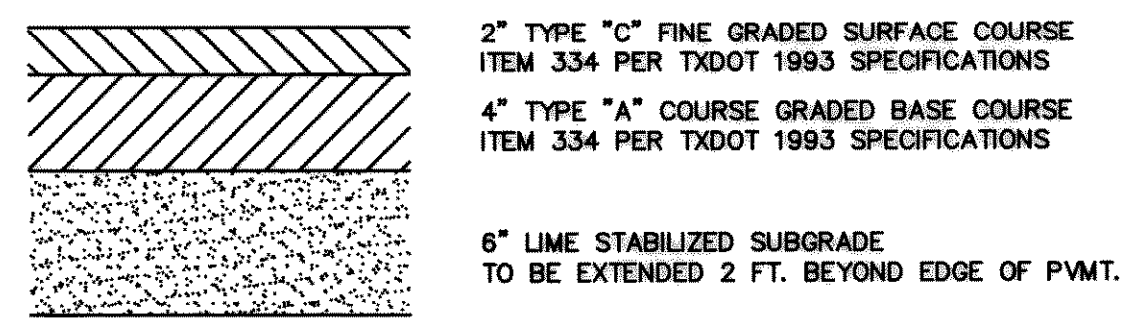

ASPHALT PAVEMENT SECTION

CAUTION!!!!  
BURIED SOUTHWESTERN BELL  
FIBER OPTIC-CONDUIT ONLY.  
CALL 48 HOURS PRIOR TO  
CONSTRUCTION. (KATHY FALKNER @ 903-457-2212)

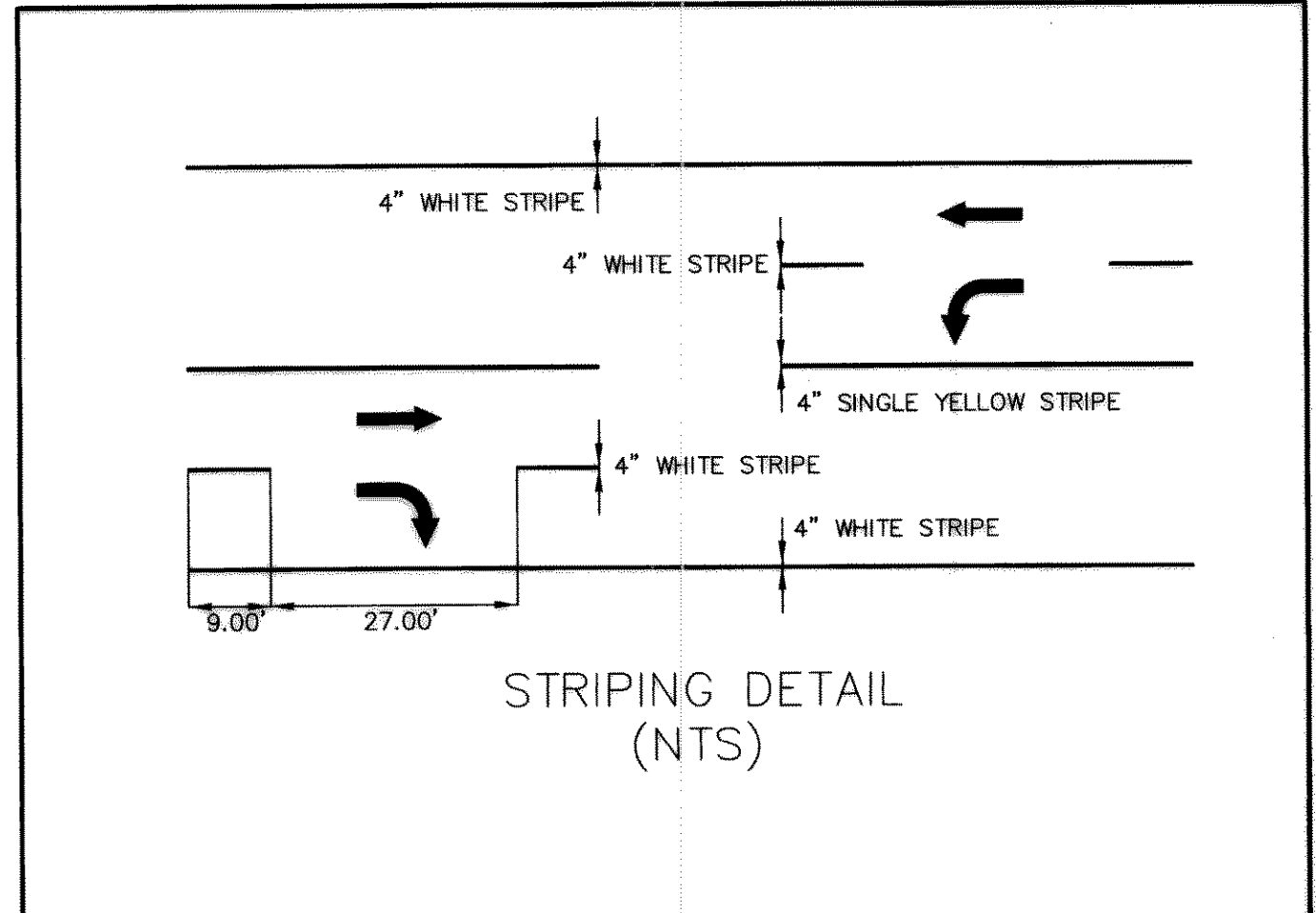

STRIPING DETAIL (NTS)

ASBUILT

Winkelmann & Associates, Inc. hereby states that this plan, to the best of our knowledge is "As Built." Modifications from the originally approved construction documents have been made as per information provided by the contractor. Winkelmann & Associates, Inc. does not certify as to the correctness or quality of construction as no field inspection was performed.

*[Signature]* DATE: 6-14-02  
WINKELMANN & ASSOCIATES, INC.

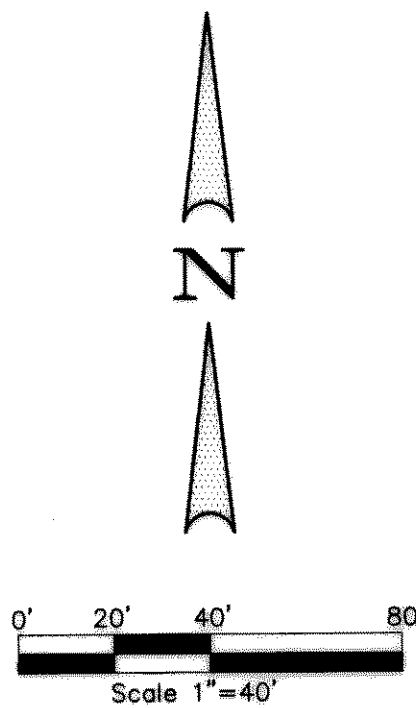

BENCHMARK: ELEV. = 600.69  
CITY OF ROCKWALL R-19  
BRASS MONUMENT AT THE N/W CORNER OF  
SILVERVIEW & DIAMOND WAY, 500' ± SOUTH OF  
S.H. 276.

BENCHMARK: ELEV. = 583.56  
R.R. SPIKE SET IN THE CENTERLINE OF S.H. 276  
3600± WEST OF F.M. 549

W.H. BAIRD SURVEY, ABSTRACT NO. 25  
CITY OF ROCKWALL  
ROCKWALL COUNTY, TEXAS  
CONTINENTAL HOMES  
621 WEST COLLEGE STREET  
GRAPEVINE, TEXAS 76051

PAVING & STRIPING PLAN  
FOR STATE HIGHWAY 276

Scale: 1"=40'  
Date: 5-14-02  
Designed By: NK  
Drawn By: MS  
Checked By: FEM  
File: 32006PSI.DWG View:  
Project No.: 32006.01

SHEET  
5  
12

NO.	DATE	REVISION	APPROV.

**Winkelmann & Associates, Inc.**  
CONSULTING CIVIL ENGINEERS & SURVEYORS  
1825 Westwood Plaza, Suite 100  
Rockwall, Texas 75087  
(972) 482-7099 FAX  
www.winkelmann.com

Professional Engineer Seal for F. E. Winkelmann, No. 67449, State of Texas, Exp. 08/31/04.