

NOTE 1

PROP 30" CMP
(SEE STORM PLAN SHT 1)

2" MT ZION WSC
PVC WATERLINE

PROP TEMP. SLOPE ESMT (WIDTH VARIES)

PROP ROW

145+00 205 BYPASS

MATCHLINE STA. 149+00

- UTILITY ADJUSTMENT NOTES:
- CONTRACTOR MAY LOWER 2" PVC WATERLINE (IF NEEDED TO PREVENT CONFLICT W/ PROP 30" CMP) WITH A WATER SUPPLY REP PRESENT. CALL DWIGHT LINDOP (972-722-3203) MT. ZION & RCH WATER SUPPLY CORP.
 - INSTALL 120 LF OF 6" SDR 21 PVC PIPE WITHIN 2 FEET OF EXISTING LINE AND PROVIDE REMOVE-ABLE PLUGS AT EACH END. 6" LINE SHALL BE USED AS A CASING FOR NEW WATER LINE IN THE EVENT OF A LINE BREAK DURING OR AFTER CONSTRUCTION.

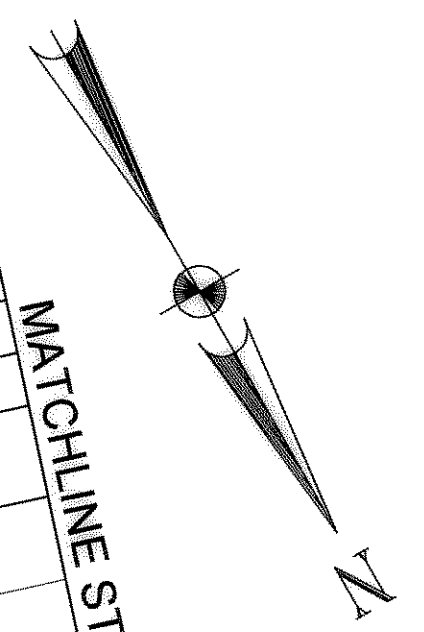

MATCHLINE STA. 149+00

150+00

PROP 14' TEMP. SLOPE ESMT

PROP ROW

205 BYPASS

155+00

160+00

MATCHLINE STA. 161+00

RECORD DRAWING
This drawing is a compilation of the original sealed engineering drawing and modifications by addenda, change orders and information furnished by the contractor. Information shown that was provided by the contractor and others not associated with the design engineer cannot be verified for accuracy or completeness. Original sealed drawing is on file at the office of AECOM USA Group, Inc., TBPE REG. NO. F-3082

ORIGINAL DRAWING
SEALED & SIGNED BY
John W. Lacy, P.E.
TX NO. 90202

NO.	REVISION	BY	DATE



City of Rockwall, Texas

205 BYPASS
SECTION 1

UTILITIES LAYOUT

1 OF 6

TCB AECOM
TCB INC.
WWW.TCB.AECOM.COM
17300 DALLAS PARKWAY, SUITE 1010
DALLAS, TEXAS 75246

Unit	PW-DAL-FW	Scale	Horz: AS SHOWN Vert: AS SHOWN	Date	11/11/2009
Designed	SRR/SDB	Checked	TCB	Project No.	60004153
Drawn	FG	Approved	TCB	Sheet	103 of 217

P:\4328\60004153-205Bypass\CAAD\Sheets\Section1-140+00-To-FM52\Record-Drawing-10-7-09\03E\1st\mgd\11.s01.dgn
11/11/2009

NOTE 2

F/L 534.74

F/L 534.28

2" MT ZION WSC
PVC WATERLINE

PROP DRAIN ESMT (WIDTH VARIES)

PROP ROW

QUAIL RUN RD

PROP ROW

PROP 25' TEMP. SLOPE ESMT

PROP TEMP. SLOPE ESMT
WIDTH VARIES

MATCHLINE STA. 8+00

MATCHLINE STA. 8+00

PROP 25' TEMP. SLOPE ESMT

PROP ROW

QUAIL RUN RD

PROP ROW

PROP 27' DRAIN ESMT

PROP TEMP. SLOPE ESMT (WIDTH VARIES)