

LEGEND

- PROPOSED ROW
- PROPOSED STORM DRAIN
- INLET

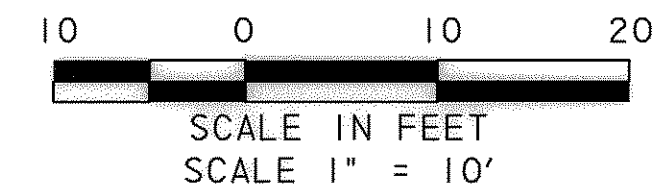
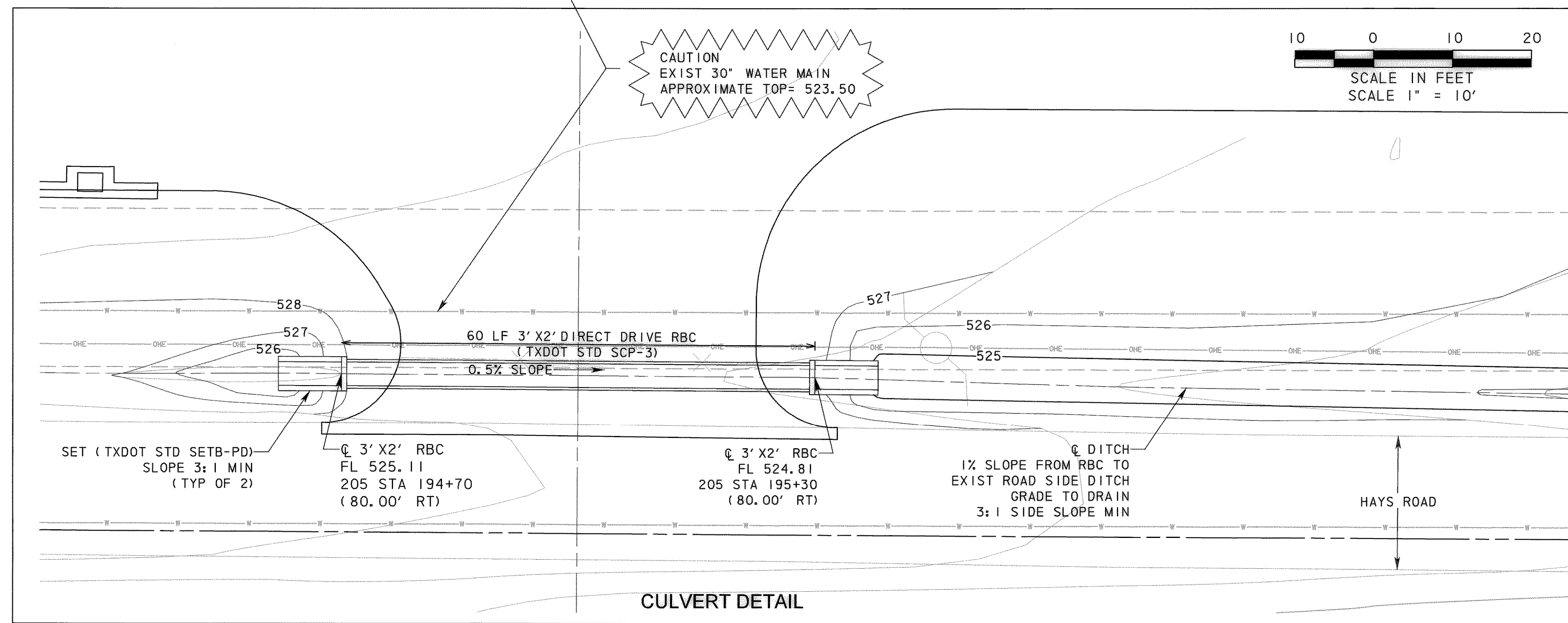
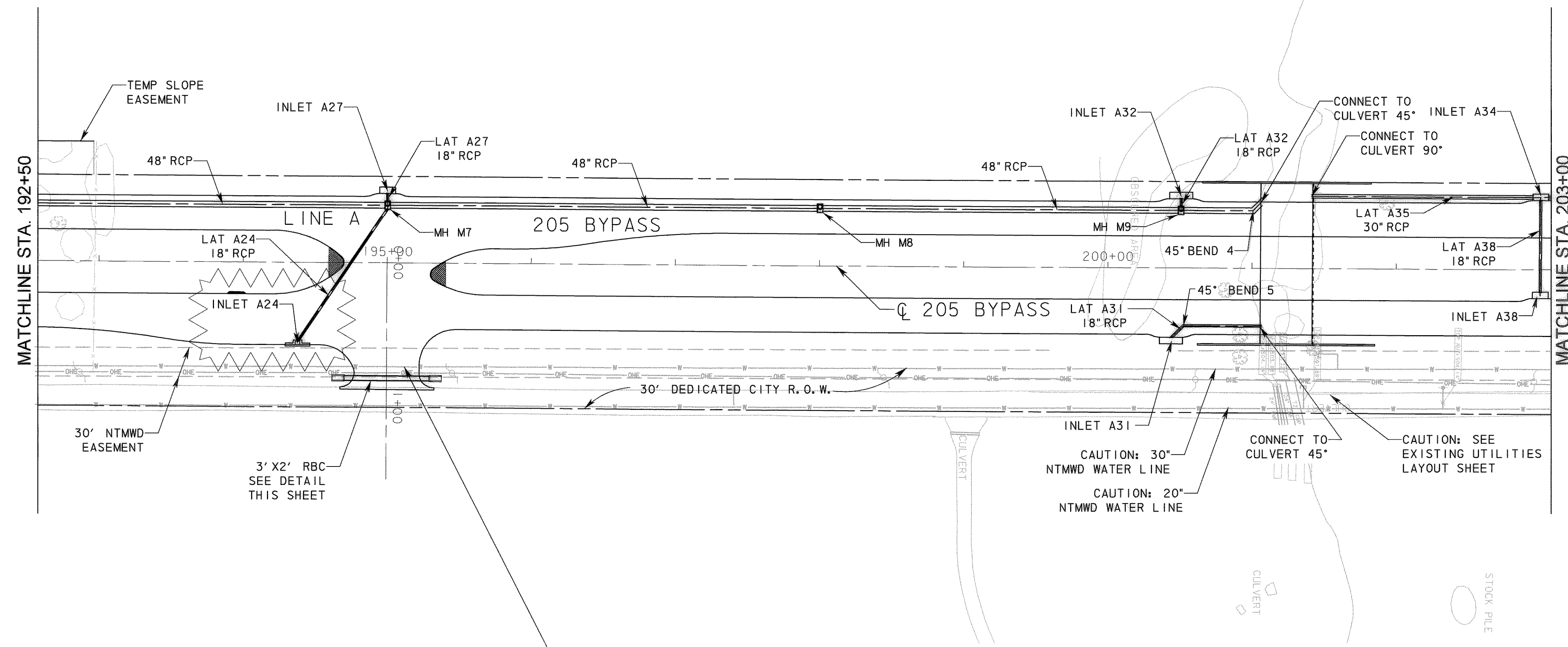

**RECORD DRAWING**  
This drawing is a compilation of the original sealed engineering drawing and modifications by addenda, change orders and information furnished by the contractor. Information shown that was provided by the contractor and others not associated with the design engineer cannot be verified for accuracy or completeness. Original sealed drawing is on file at the office of AECOM USA Group, Inc., TBPE REG. NO. F-3082

ORIGINAL DRAWING  
SEALED & SIGNED BY  
Matthew L. Abbe, P.E.  
TX NO. 92715

NO. 1	INLET A24	THG	01/10/08
NO.	REVISION	BY	DATE
<b>205 BYPASS</b> SECTION 1			
<b>STORM PLAN</b> STA. 192+50 TO STA. 203+00 6 OF 7			
<b>TCB   AECOM</b> <small>TCB INC. WWW.TCB.AECOM.COM 17300 DALLAS PARKWAY, SUITE 1010 DALLAS, TEXAS 75248</small>			
Unit	PW-DAL-FW	Scale: Horiz: AS SHOWN Vert: AS SHOWN	Date 11/11/2009
Designed	SRR/SDB	Checked TCB	Project No. 60004153
Drawn	FG	Approved TCB	Sheet 94 of 217

P:\4328\60004153-205Bypass\CADD\Sheets\Set1\1-140-00-To-FMS52\Record Drawing 10\_7\_09\0345\form\p\lan-06.dgn  
 11/11/2009