

LEGEND

- PROPOSED ROW
- PROPOSED STORM DRAIN
- INLET

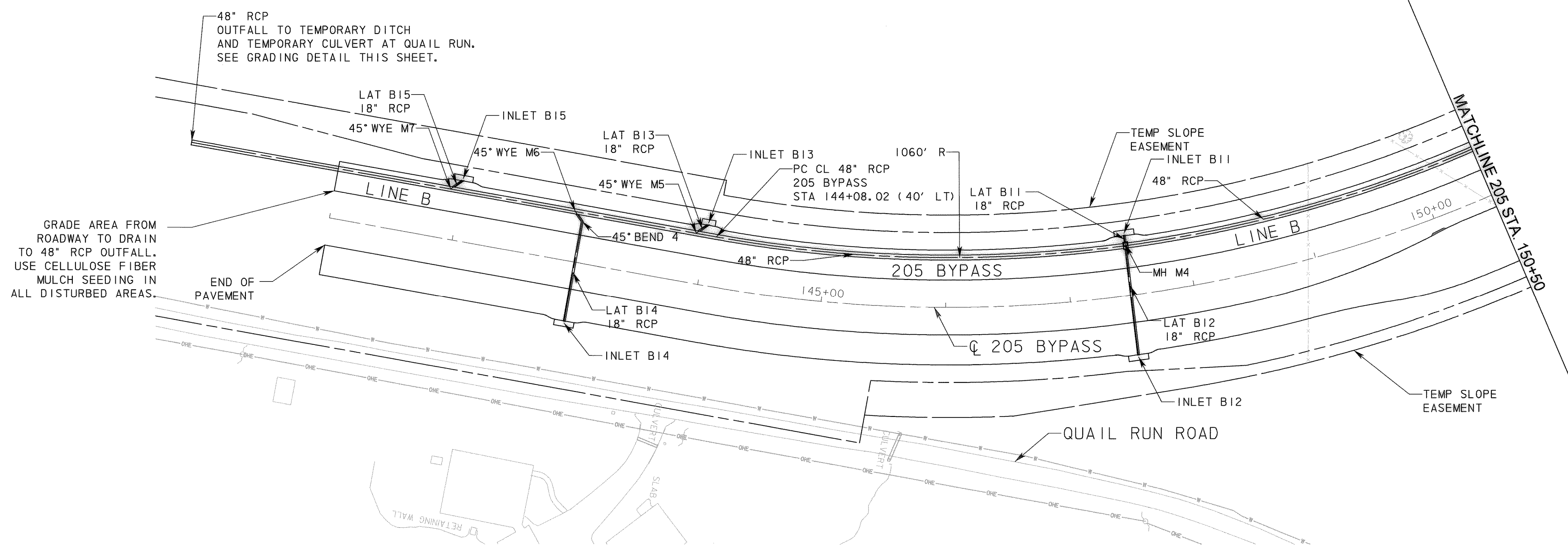

GRADE AREA FROM ROADWAY TO DRAIN TO 48" RCP OUTFALL. USE CELLULOSE FIBER MULCH SEEDING IN ALL DISTURBED AREAS.

END OF PAVEMENT

TEMP SLOPE EASEMENT

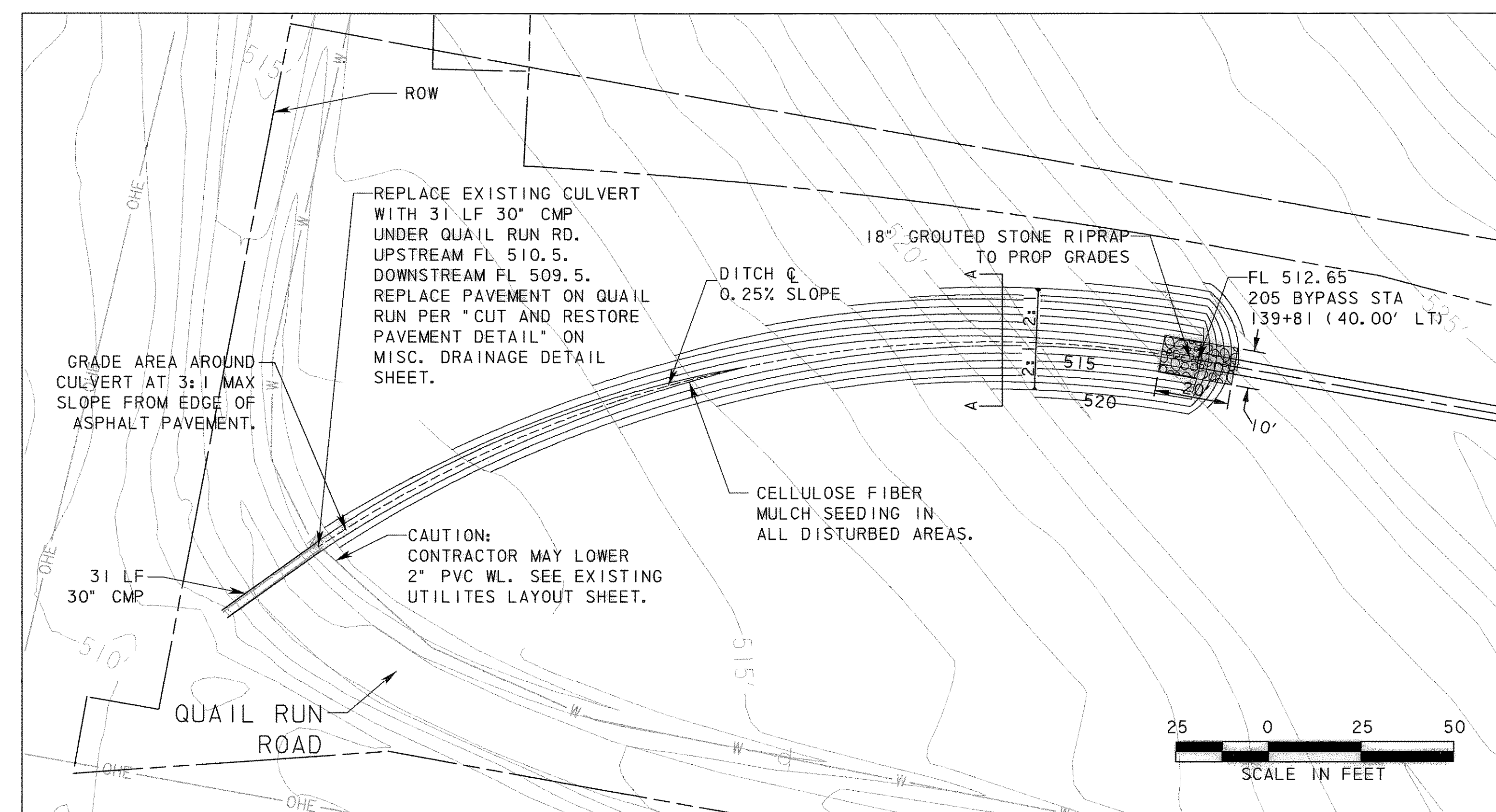
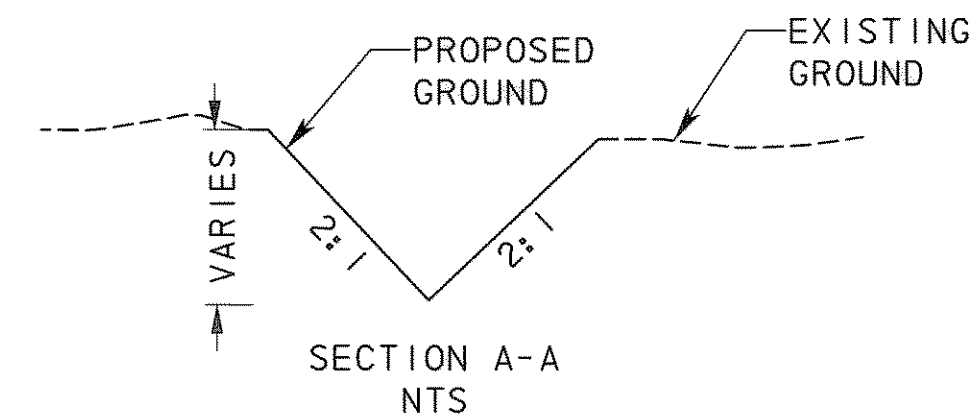
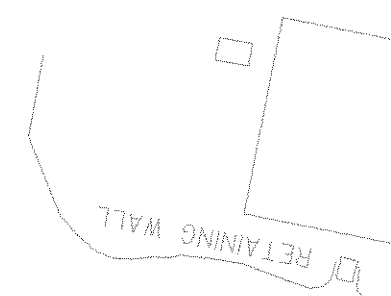

REPLACE EXISTING CULVERT WITH 31 LF 30" CMP UNDER QUAIL RUN RD. UPSTREAM FL 510.5. DOWNSTREAM FL 509.5. REPLACE PAVEMENT ON QUAIL RUN PER "CUT AND RESTORE PAVEMENT DETAIL" ON MISC. DRAINAGE DETAIL SHEET.

GRADE AREA AROUND CULVERT AT 3:1 MAX SLOPE FROM EDGE OF ASPHALT PAVEMENT.

CAUTION: CONTRACTOR MAY LOWER 2" PVC WL. SEE EXISTING UTILITIES LAYOUT SHEET.

CELLULOSE FIBER MULCH SEEDING IN ALL DISTURBED AREAS.

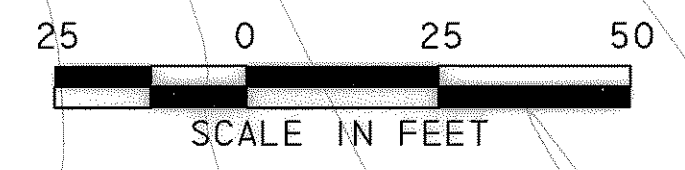

GRADING DETAIL

RECORD DRAWING

This drawing is a compilation of the original sealed engineering drawing and modifications by addenda, change orders and information furnished by the contractor. Information shown that was provided by the contractor and others not associated with the design engineer cannot be verified for accuracy or completeness. Original sealed drawing is on file at the office of AECOM USA Group, Inc., TBPE REG. NO. F-3082

ORIGINAL DRAWING SEALED & SIGNED BY
Matthew L. Abbe, P.E.
TX NO. 92715

NOTES:

1. SYSTEM B WILL TEMPORARILY DRAIN IN DITCH TO TEMPORARY CULVERT UNDER QUAIL RUN.
2. SECTION 1 CONTRACTOR SHOULD NOTE THAT A ROADWAY SECTION SOUTH OF STATION 141+00 WILL BE CONSTRUCTED (SECTION 2). SECTION 2 COULD POTENTIALLY BE UNDER CONSTRUCTION SIMULTANEOUSLY WITH SECTION 1. CONTRACTOR IS RESPONSIBLE TO COORDINATE WITH SECTION 2 CONTRACTOR AND VERIFY NEED FOR TEMPORARY DITCH AND 30" CMP.

NO.	REVISION	BY	DATE

City of Rockwall, Texas

205 BYPASS SECTION 1

STORM PLAN
STA. 140+00 TO STA. 150+50

1 OF 7

Unit	PW-DAL-FW	Scale	Horz: AS SHOWN Vert: AS SHOWN	Date	11/11/2009
Designed	SRR/SDB	Checked	TCB	Project No.	60004153
Drawn	FG	Approved	TCB	Sheet	89 of 217

TCB INC. WWW.TCB.AECOM.COM
17300 DALLAS PARKWAY, SUITE 1010
DALLAS, TEXAS 75248

P:\1428\50004153-205Bypass\CADD\Sheets\Section1\140-00-To-FM52\Record Drawing 10_7_09\0895StormPlan-01.dgn
 11/11/2009