

- NOTE
- SOD ALL GRADED SLOPES STEEPER THAN 4:1 AND ALL AREAS IN BOTTOM OF STREAM CHANNEL. INSTALL CELLULOSE FIBER MULCH SEEDING IN ALL OTHER DISTURBED AREAS PER TXDOT SPEC ITEM 164.
 - CONTRACTOR SHALL USE SPECIAL CARE WHEN GRADING OVER WATERLINE AND LIMIT LOADS TO ONE H2O LOADING OR LESS.

RECORD DRAWING

This drawing is a compilation of the original sealed engineering drawing and modifications by addenda, change orders and information furnished by the contractor. Information shown that was provided by the contractor and others not associated with the design engineer cannot be verified for accuracy or completeness. Original sealed drawing is on file at the office of AECOM USA Group, Inc., TBPE REG. NO. F-3082

ORIGINAL DRAWING SEALED & SIGNED BY
John W. Lacy, P.E.
TX NO. 90202

NO.	REVISION	BY	DATE
205 BYPASS SECTION 1			
GRADING PLAN STREAM 6			
2 OF 2			
TCB AECOM		<small>TCB INC. WWW.TCB.AECOM.COM 17300 DALLAS PARKWAY, SUITE 1010 DALLAS, TEXAS 75248</small>	
Unit	PW-DAL-FW	Scale: Horiz AS SHOWN Vert AS SHOWN	Date 11/11/2009
Designed	SRR/SDB	Checked TCB	Project No. 60004153
Drawn	FG	Approved TCB	Sheet 88 of 217

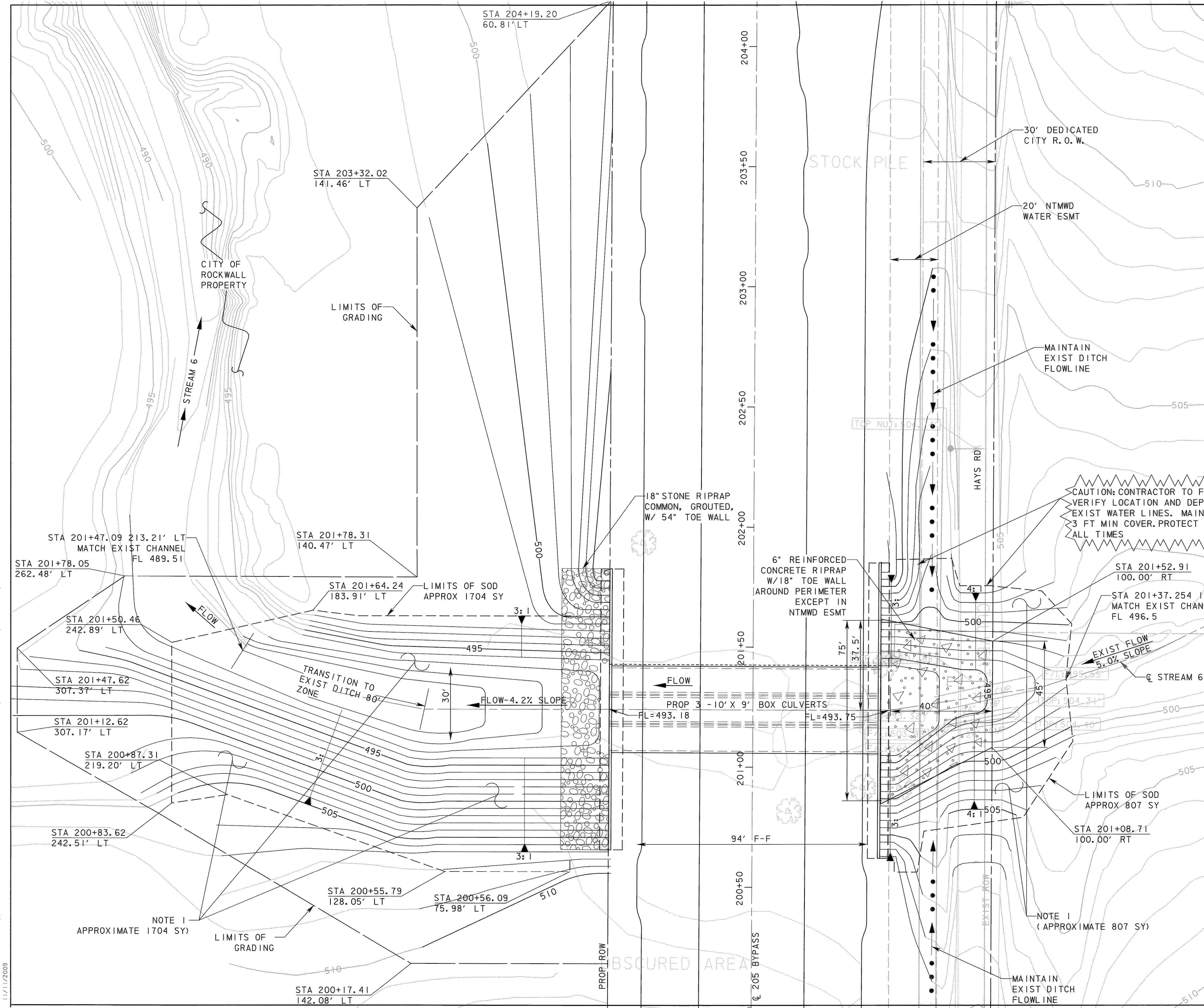

P:\4228\2009\205Bypass\CADD\Sheets\Section1\140-00-To-FM552\Record Drawing\10_7_09\086\grading-stream6.dgn
 11/11/2009