

LEGEND

	CONCRETE PAVEMENT
	HMAC PAVEMENT / OVERLAY

RECORD DRAWING

This drawing is a compilation of the original sealed engineering drawing and modifications by addenda, change orders and information furnished by the contractor. Information shown that was provided by the contractor and others not associated with the design engineer cannot be verified for accuracy or completeness. Original sealed drawing is on file at the office of AECOM USA Group, Inc., TBPE REG. NO. F-3082

ORIGINAL DRAWING SEALED & SIGNED BY

Matthew L. Abbe, P.E.
TX NO. 92715

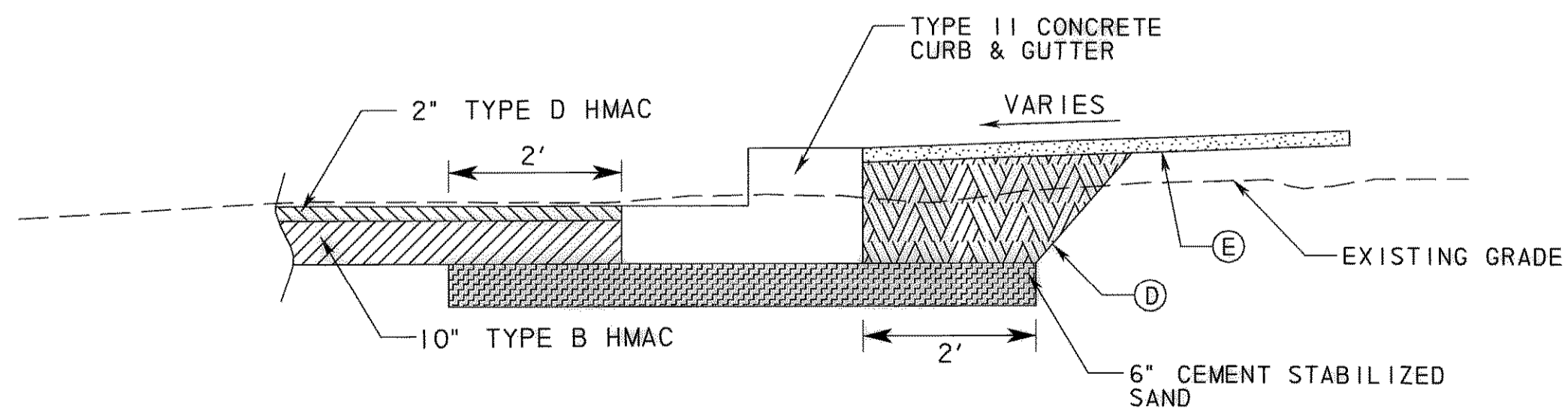
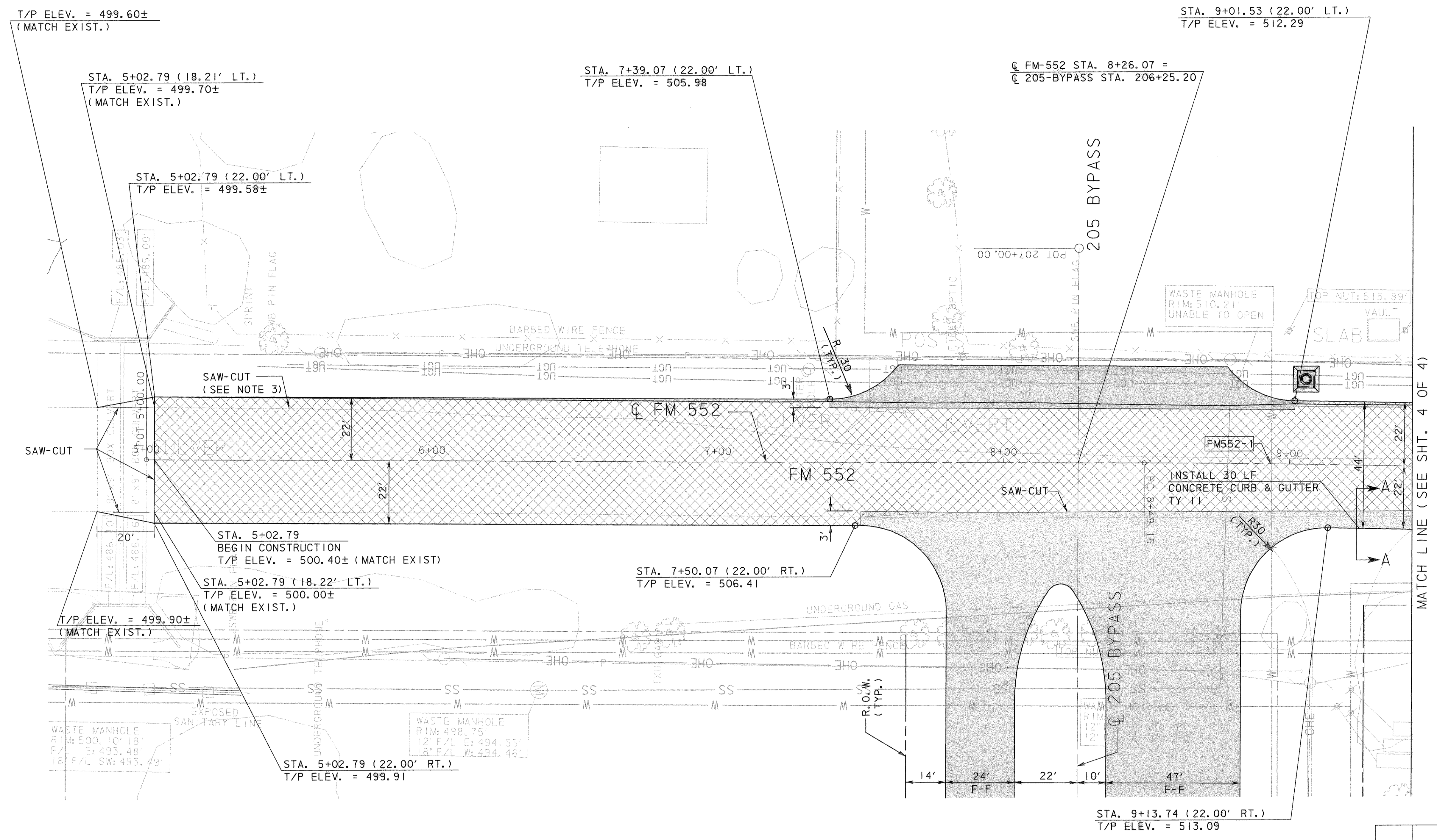

- Ⓓ EMBANKMENT
- Ⓔ 4" MANUFACTURED TOPSOIL AND CELLULOSE FIBER MULCH SEEDING

SECTION A-A
N. T. S.

CURVE DATA					
NO.	Δ	D	R	T	L
FM552-1	2° 12' 58.34" (RT)	1° 8' 45.30"	5000.00'	96.71'	193.40'

- NOTES:**
- STATION/OFFSETS SHOWN ARE REFERENCED FROM FM-552 CONTROL LINE, UNLESS OTHERWISE SHOWN.
 - REFER TO FM 552 INTERSECTION LAYOUT SHEETS 1 & 2 FOR ADDITIONAL INFORMATION.
 - CONTRACTOR TO SAWCUT ALONG EXISTING FM 552 2-FT FROM EXIST. EDGE OF PAVEMENT WHEN INSTALLING PERMANENT HMAC, TO PROVIDE CLEAN CUT. SEE TRAFFIC CONTROL SHEETS FOR SEQUENCE OF CONSTRUCTION.

NO.	REVISION	BY	DATE
205 BYPASS SECTION 1			
FM 552 INTERSECTION LAYOUT			
3 OF 4			
		<small>TCB INC. WWW.TCB.AECOM.COM 17300 DALLAS PARKWAY, SUITE 1010 DALLAS, TEXAS 75248</small>	
Unit	PW-DAL-FW	Scale	Horz: AS SHOWN Vert: AS SHOWN
Designed	SKW/MLA	Checked	TCB
Drawn	TCB	Approved	TCB
Date	11/17/2009	Project No.	60004153
Sheet	64	of	217

\\usool1\p001\pww\328\60004153-205Bypass\CADD\Sheets\Section1-140+00-to-FM552\Record Drawing 10-7-09-064 IntersectLay-FM552-03.dgn
 11/17/2009