

NOTE:  
1. CELLULOSE FIBER MULCH SEEDING IN ALL DISTURBED AREA PER TXDOT SPEC ITEM 164.

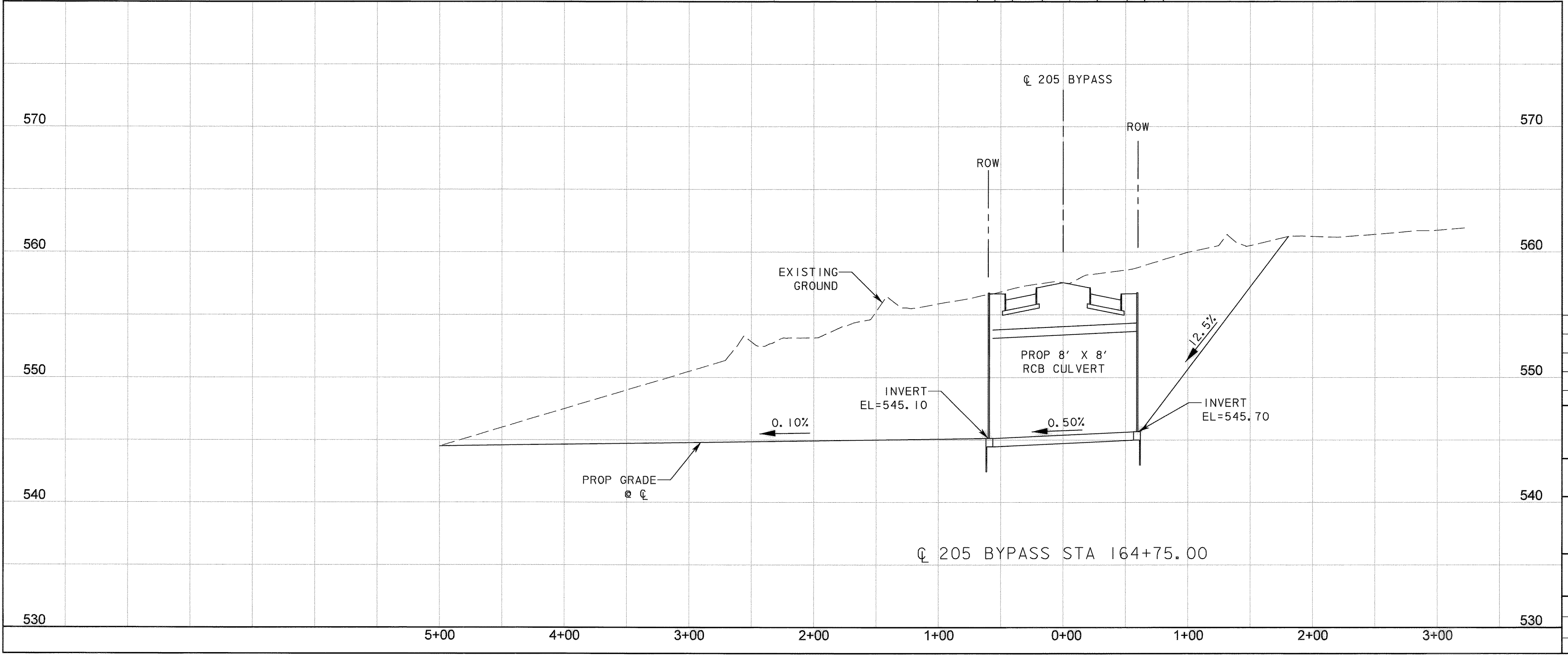

**RECORD DRAWING**  
This drawing is a compilation of the original sealed engineering drawing and modifications by addenda, change orders and information furnished by the contractor. Information shown that was provided by the contractor and others not associated with the design engineer cannot be verified for accuracy or completeness. Original sealed drawing is on file at the office of AECOM USA Group, Inc., TBPE REG. NO. F-3082

ORIGINAL DRAWING SEALED & SIGNED BY  
John W. Lacy, P.E.  
TX NO. 90202

NO.	REVISION	BY	DATE

**City of Rockwall, Texas**

**205 BYPASS SECTION 1**

**GRADING PLAN AND PROFILE STOCK PASS STA 164+75** 2 OF 2

**TCB | AECOM** TCB INC. WWW.TCB.AECOM.COM 17300 DALLAS PARKWAY, SUITE 1010 DALLAS, TEXAS 75248

Unit	PW-DAL-FW	Scale:	Horz: AS SHOWN Vert: AS SHOWN	Date	11/11/2009
Designed	SRR/SDB	Checked	TCB	Project No.	60004153
Drawn	FG	Approved	TCB	Sheet	86 of 217

P:\4328\60004153-205Bypass\CADD\Sheets\Sheet1\140-00-To-FM52\Record Drawing 10\_7\_09\0866rad\ing-stockpass.dgn  
 11/11/2009